



HILL STREET MAYFAIR W1J
£820 PER WEEK AVAILABLE 03/04/2026

Hamptons

THE HOME EXPERTS

{ THE PARTICULARS

Hill Street Mayfair W1J

£820 Per Week
Furnished

-  1 Bedroom
-  1 Bathroom
-  1 Reception

Features

- One bedroom, - One bathroom, - One reception room, - Kitchen, - Desirable Mayfair location, - Pet Friendly, - On-site building manager, - Superfast Broadband, - 24 hour emergency helpline, - Lift service, - Council Tax Band E

Council Tax

Council Tax Band E

Hamptons
168 Brompton Road
Knightsbridge, London, SW3 1HW
020 7584 2014
KnightsbridgeLettings@hamptons.co.uk
www.hamptons.co.uk

{ A ONE BEDROOM APARTMENT IN THE HEART OF MAYFAIR

The Property

This one bedroom first floor apartment is situated in the heart of London's fashionable Mayfair. The apartment is set over 427 sq ft. and comprises large double bedroom, modern fitted bathroom, spacious reception room with rear facing views over Hay's Mews, and a unique kitchenette and access to a private gated communal garden. Hill Street, benefits from spacious living accommodation, lift service, on-site building manager, and is nestled conveniently between Hyde Park and Green Park. The transport links include Green Park, Bond Street and Marble Arch Stations, all within a short stroll away.

Location

This fantastic property is situated in the heart of Mayfair which is one of London's finest residential areas with exclusive shops and restaurants. With the closest transport links of Green Park (0.4 miles) and Bond Street (0.5 miles)



HILL STREET

Approximate Gross Internal Area

430 sq. ft. (39.9 sq. m.)

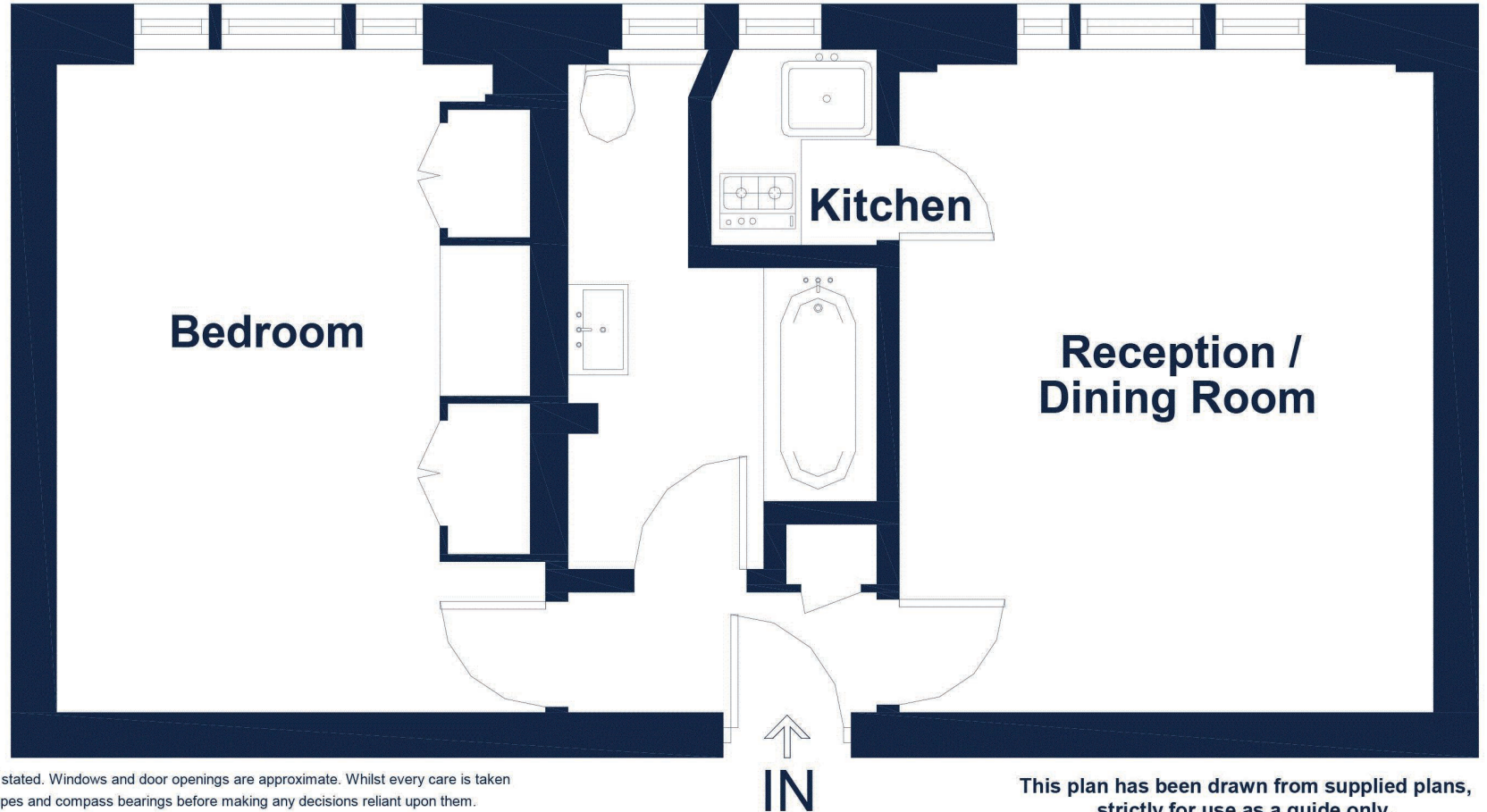

This plan is for layout guidance only. Not drawn to scale unless stated. Windows and door openings are approximate. Whilst every care is taken in the preparation of this plan, please check all dimensions, shapes and compass bearings before making any decisions reliant upon them. ID 766884

This plan has been drawn from supplied plans, strictly for use as a guide only.

For Clarification

We wish to inform prospective tenants that we have prepared these particulars as a general guide and they have been confirmed as accurate by the landlord. We have not verified permissions, nor carried out a survey, tested the services, appliances and specific fittings. Room sizes are approximate and measurement figures rounded: they are taken between internal wall surfaces and therefore include cupboards/shelves, etc. Accordingly, they should not be relied upon for

carpets and furnishings. It should also be noted that all fixtures and fittings, carpeted, curtains/blinds, kitchen equipment and garden statuary, whether fitted or not, are deemed removable by the landlord unless specifically itemised with these particulars. Please enquire in office or on our website for details on holding deposit and tenancy deposit figures.

Energy Efficiency Rating		Current	Potential
Very energy efficient - lower running costs			
100-100	A		
81-100	B		
62-81	C		
43-62	D		
24-43	E	55	
5-24	F		
1-5	G		
Not energy efficient - higher running costs			
England & Wales			EU Directive 2002/91/EC

