



Greenwich High Road, SE10

£450,000

An immaculately presented, two bedroom modern apartment positioned in Cowan House, a popular gated-development. The property also benefits from a private balcony and a long lease.

Ideally located, there are number of local shops, restaurants and bars, plus Waitrose supermarket which is nearby. The DLR is approximately 0.1 miles away, offering access into Canary Wharf within 12 minutes and Bank within less than 20 minutes. You will also benefit from access to the bustling local markets, and enjoy the open spaces of the Royal Park.

Features

- Two Bedrooms
- Chain Free
- No Work Required
- Sought After Location
- Private Balcony
- Ideal First Purchase

Greenwich High Road, London, SE10

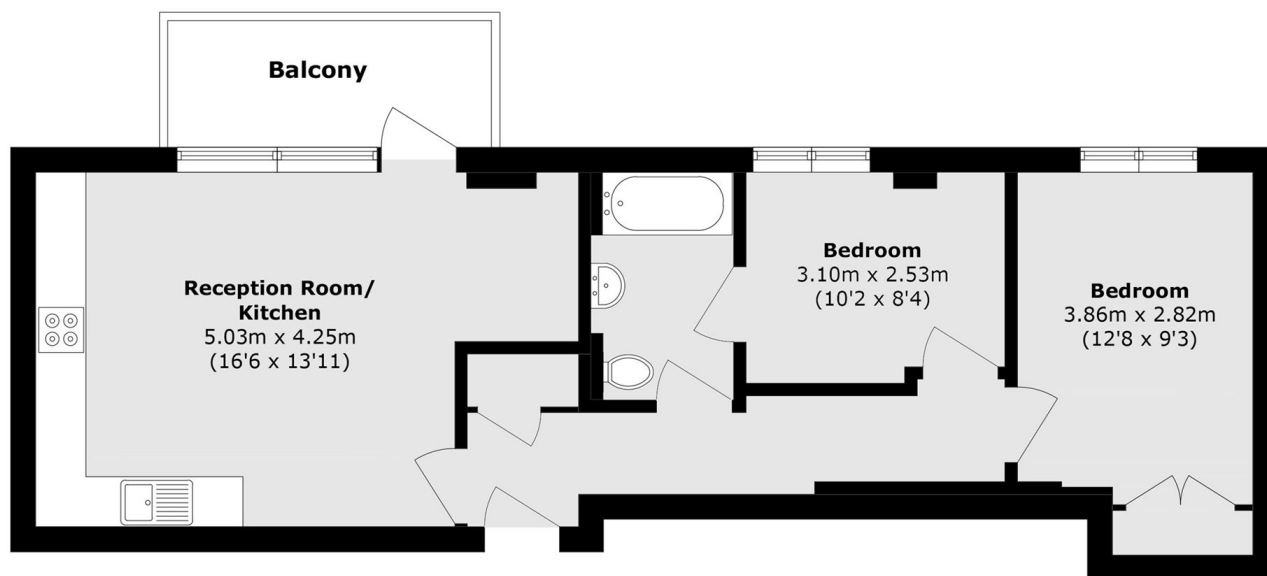

Total area (approx.): 60.0 sq. m (645.8 sq. ft)

Balcony area (approx.): 5.8 sq. m (62.4 sq. ft)