



Pennys Estate Agents Limited for themselves and for the vendor of this property whose agents they are give notice that:- (1) These particulars do not constitute any part of an offer or a contract. (2) All statements contained in these particulars are made without responsibility on the part of Pennys Estate Agents Limited. (3) None of the statements contained in these particulars are to be relied upon as a statement or representation of fact. (4) Any intending purchaser must satisfy himself/herself by inspection or otherwise as to the correctness of each of the statements contained in these particulars. (5) The vendor does not make or give and neither do Pennys Estate Agents Limited nor any person in their employment has any authority to make or give any representation or warranty whatever in relation to this property.

16 Ellwood Road, Exmouth, EX8 4LE

GUIDE PRICE

£445,000

TENURE Freehold



***** COMING SOON *****

**A Spacious Detached Bungalow In The Process Of being Modernised
And Refurbished To A Superb Standard.**

New Quality Kitchen And Bathroom Suite * Stunning Open Plan Living Area * Three Good Size Bedrooms * Rewired * New Heating System * Double Glazed Windows * Generously Sized Rear Garden With Outside Lighting And Power * Driveway And Garage * **CONTACT US FOR FURTHER DETAILS TO ENSURE YOU DO NOT MISS OUT ***

*** Internal Pictures Are For Illustration Purposes Only ***

16 Ellwood Road, Exmouth, EX8 4LE

Pennys are delighted to offer for sale this most spacious detached bungalow which is ideally located close to the shops and bus services.

The accommodation is undergoing a programme of refurbishment to include being re-wired, new central heating system, stylish quality new kitchen and bathroom suite and fully re-decorated. The property also boasts double glazed windows, a super sized rear garden, driveway and garage.

THE ACCOMMODATION COMPRISES:

HALL:

OPEN PLAN LOUNGE/DINING AREA AND KITCHEN: 7.01m x 6.38m (23'0" x 20'11") narrowing to 14'7"

BEDROOM ONE: 3.96m x 2.57m (13'0" x 8'5")

BEDROOM TWO: 3.05m x 3.02m (10'0" x 9'11")

BEDROOM THREE: 3.35m x 2.74m (11'0" x 9'0")

BATHROOM/WC:

FLOOR PLAN:

GROUND FLOOR

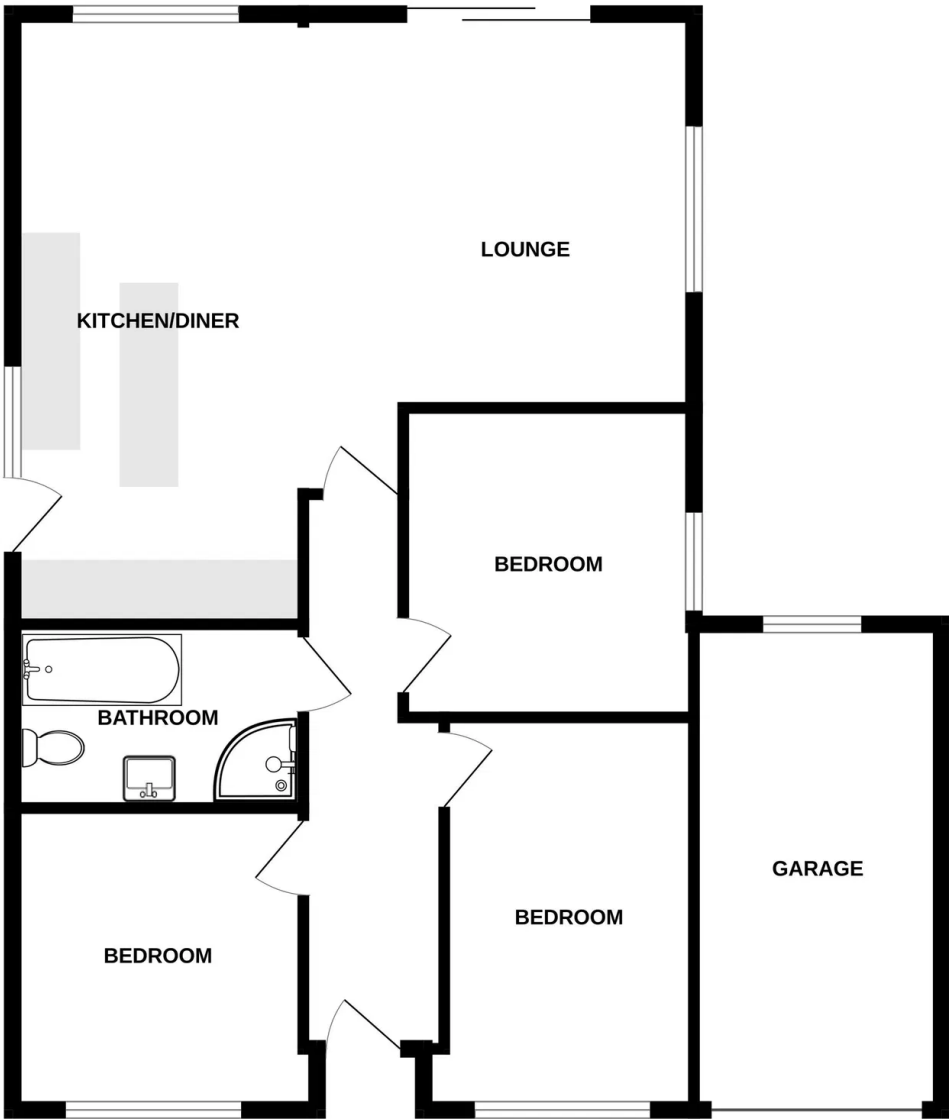

Whilst every attempt has been made to ensure the accuracy of the floorplan contained here, measurements of doors, windows, rooms and any other items are approximate and no responsibility is taken for any error, omission or mis-statement. This plan is for illustrative purposes only and should be used as such by any prospective purchaser. The services, systems and appliances shown have not been tested and no guarantee as to their operability or efficiency can be given.
Made with Metropix ©2025