



10 Mulberry Close, Ormskirk

Ormskirk

Guide Price £285,000

# 10 Mulberry Close

Ormskirk

Modern three-storey townhouse near Ormskirk centre with 4 bedrooms, 3 bathrooms, gardens, parking, and flexible living spaces. Well presented and close to schools and transport links.  
Council Tax band: C

Tenure: Freehold

EPC Energy Efficiency Rating: C

EPC Environmental Impact Rating:

- MODERN THREE STOREY TOWN HOUSE
- EN-SUITE
- POPULAR RESIDENTIAL DEVELOPMENT
- PARKING TO THE FRONT
- EASILY MAINTAINED GARDEN





Ian Anthony



Ian Anthony



Ian Anthony



**Ground Floor** Building 1

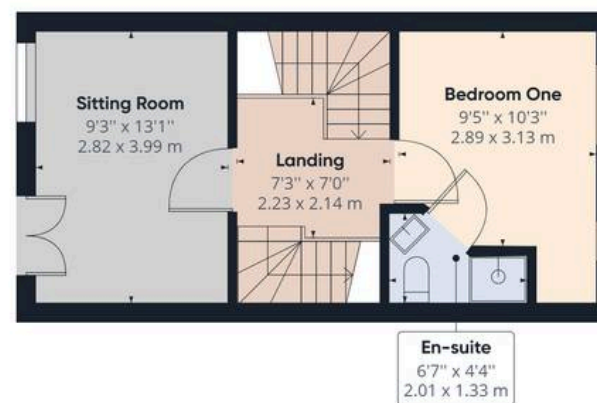

**Floor 1** Building 1

**Approximate total area<sup>(1)</sup>**

975.48 ft<sup>2</sup>

90.62 m<sup>2</sup>

(1) Excluding balconies and terraces

While every attempt has been made to ensure accuracy, all measurements are approximate, not to scale. This floor plan is for illustrative purposes only.

**GIRAFFE360**

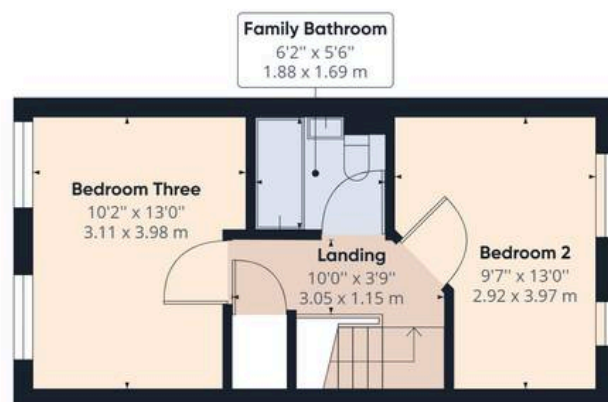

**Floor 2** Building 1



## IAN ANTHONY

5 Burscough Street, Ormskirk - L39 2EG

01695580888

[enquiries@iananthonyestates.co.uk](mailto:enquiries@iananthonyestates.co.uk)

[iananthonyestates.co.uk/](http://iananthonyestates.co.uk/)

