



3 Ironwood Avenue  
Kettering, NN14 2JJ



**Simpson Ellson**

Magnificent Five Bedroom Detached Family Home | Three Storeys | Prime Position on the Grange Development

Occupying a prime position at the highly sought-after entrance to the popular Grange Development, this substantial five-bedroom, three-storey detached residence offers exceptional space, versatility and modern family living.

Ideally located within easy reach of local amenities, highly regarded schools and major road links, the property perfectly balances convenience with an enviable residential setting.

#### Ground Floor

A welcoming entrance hall sets the tone for the generous accommodation beyond. The heart of the home is the impressive open-plan kitchen/breakfast room, thoughtfully designed to provide both functionality and style — ideal for everyday family life and entertaining alike.

Further ground floor accommodation includes:

A separate formal dining room

A dedicated study, perfect for home working

A practical utility room

Downstairs W/C

To the rear, a bright conservatory enhances the living space and provides seamless access to the beautifully maintained rear garden.

#### First Floor

The first floor offers superb flexibility, featuring a spacious, light-filled living room together with two well-proportioned double bedrooms and a convenient W/C.

#### Second Floor

Price £350,000



5



2



4



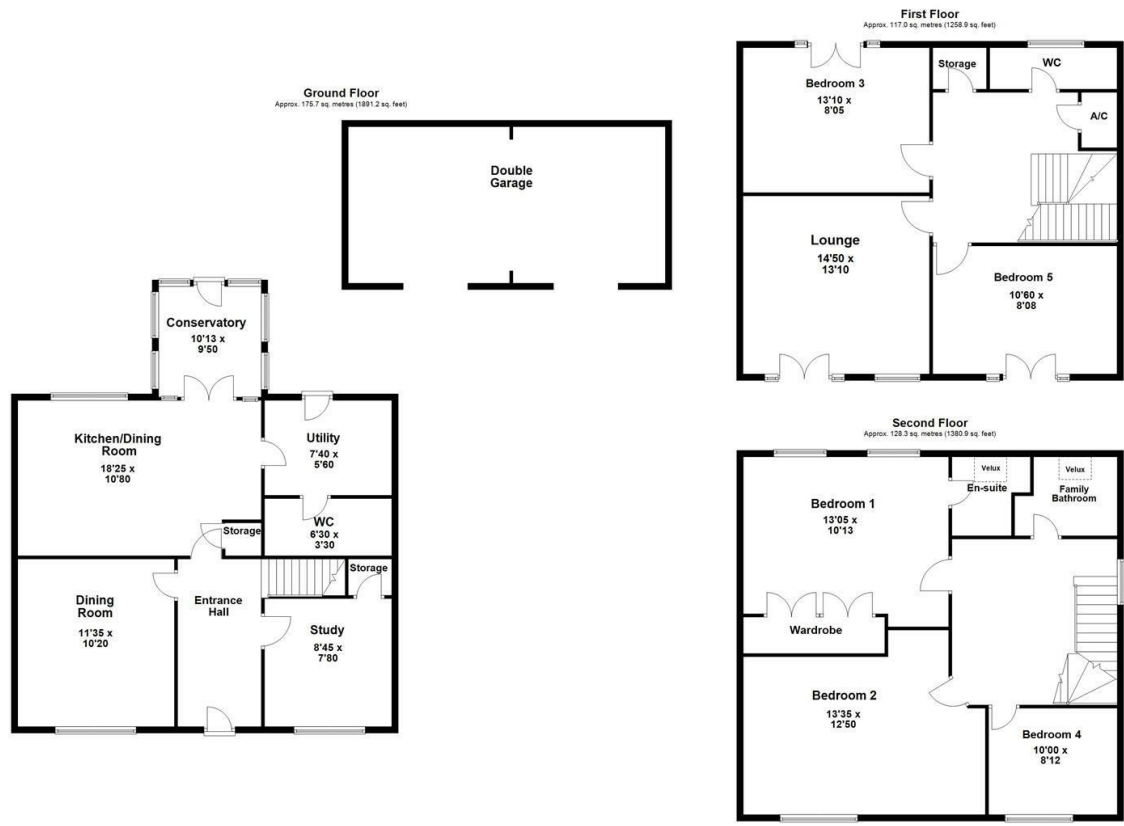

Total area: approx. 420.9 sq. metres (4530.9 sq. feet)

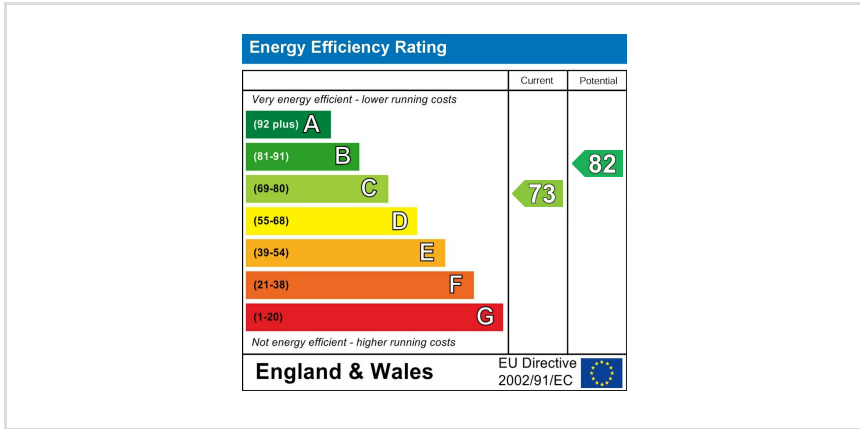



**Simpson  
Ellson**

T: 01536 645960  
E: [rothwell@simpsonellson.co.uk](mailto:rothwell@simpsonellson.co.uk)



01536 645960  
[rothwell@simpsonellson.co.uk](mailto:rothwell@simpsonellson.co.uk)  
<https://www.simpsonellson.co.uk>

32 High Street, Rothwell, Northants, NN14 6BQ