



Union Street, SE1

£350,000

Set within a characterful period building, this seldom-offered conversion combines timeless charm with contemporary style. Expansive sash windows bathe the interior in daylight, while rich wooden flooring runs seamlessly throughout. The bright open-concept lounge and kitchen create an inviting space for entertaining and everyday living, alongside a generously sized double bedroom and a three-piece bathroom.

Union Street sits in the heart of SE1, blending historic charm with a vibrant city lifestyle. Moments away, Borough Market and Flat Iron Square offer buzzing food and social scenes, while the South Bank provides scenic riverside walks and cultural hotspots. With London Bridge Station nearby, the transport links couldn't be better.

Features

- Chain Free Sale
- Victorian Conversion
- Sash Windows & Wooden Floors
- Very Central Location
- Excellent Transport Links

Union Street,
London, SE1

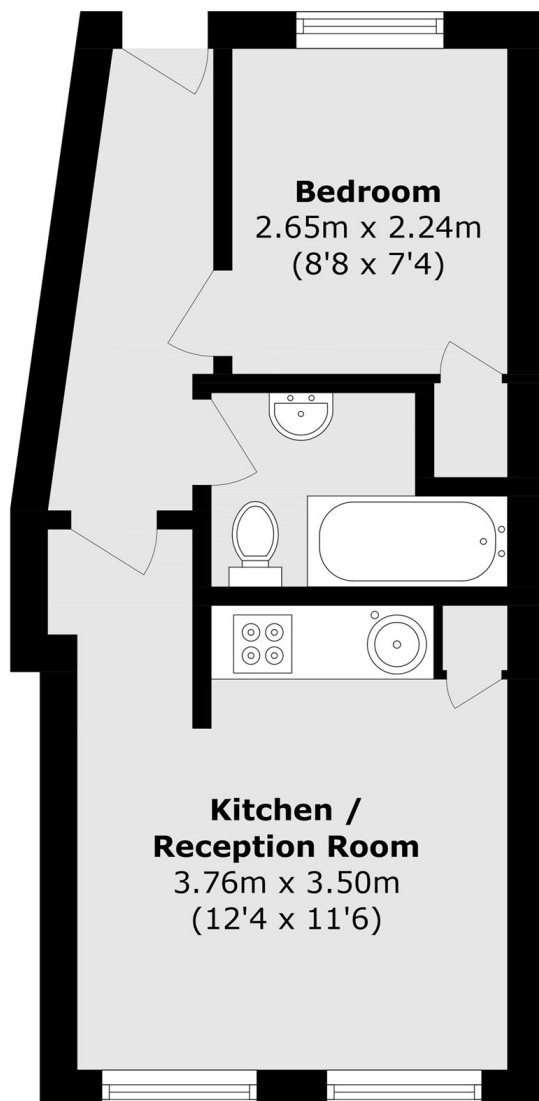

Total area (approx.): 29.2 sq. m (314.3 sq. ft)

Dexters

London Bridge
54 Borough High Street
London
SE1 1XL
Sales
020 7650 5 100

Energy Rating: . We aim to make our particulars both accurate and reliable. However they are not guaranteed; nor do they form part of an offer or contract. If you require clarification on any points then please contact us, especially if you're traveling some distance to view. Please note that appliances and heating systems have not been tested and therefore no warranties can be given as to their good working order.

 **RICS** | Regulated
Estate Agent
and Letting Agent

dexters.co.uk