



Crowther Road
Birmingham

burchell
edwards



Property Description

This attractive semi-detached home offers spacious and versatile accommodation throughout and has been maintained to a good standard by the current owners. The ground floor briefly comprises a welcoming entrance hall, guest W.C, generous lounge with bay window and feature fireplace, separate dining room overlooking the rear garden and a fitted kitchen with access to the side.

Upstairs the property benefits from three well proportioned bedrooms and a modern family bathroom fitted with a white suite. The layout provides an excellent balance of bedroom space alongside practical family living accommodation, making it perfectly suited to growing families.

Externally the property enjoys a substantial rear garden which is mainly laid to lawn with patio and seating areas, offering excellent outdoor space for entertaining and family use. To the front is a spacious block paved driveway providing ample off road parking. The property is conveniently positioned for local schools, shops, transport links and amenities.

Lounge

Bay window to front elevation, feature fireplace and radiator.

Dining Room

Double glazed window to rear elevation, radiator and ample dining space.

Kitchen

Fitted with a range of wall and base units with work surfaces over, sink and drainer unit, space for appliances and side access door.

Bedroom One

Double glazed window to rear elevation and radiator.

Bedroom Two

Double glazed window to front elevation and radiator.

Bedroom Three

Double glazed window to front elevation and radiator.

Bathroom

Fitted with bath, wash hand basin, low level W.C and double glazed window to rear elevation.









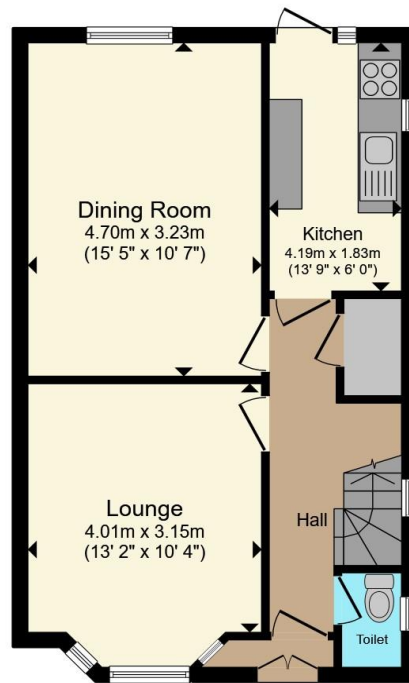

Ground Floor

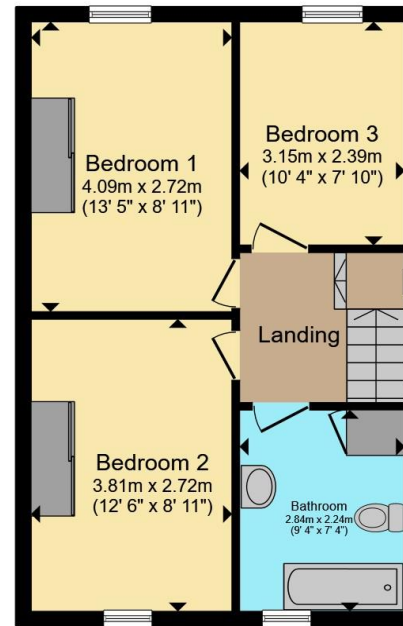

First Floor

Total floor area 87.9 m² (946 sq.ft.) approx

This floor plan is for illustrative purposes only. It is not drawn to scale. Any measurements, floor areas (including any total floor area), openings and orientation are approximate. No details are guaranteed, they cannot be relied upon for any purpose and they do not form part of any agreement. No liability is taken for any error, omission or misstatement. A party must rely upon its own inspection(s). Powered by www.propertybox.io



To view this property please contact Burchell Edwards on

T 0121 373 6320
E erdington@burchelledwards.co.uk

Unit 3 Queens Court, Gravelly Hill Erdington
 BIRMINGHAM B23 6BJ

EPC Rating: B Council Tax
 Band: B

Tenure: Freehold

view this property online burchelledwards.co.uk/Property/ERD207961



1. MONEY LAUNDERING REGULATIONS Intending purchasers will be asked to produce identification documentation at a later stage and we would ask for your co-operation in order that there will be no delay in agreeing the sale. 2. These particulars do not constitute part or all of an offer or contract. 3. The measurements indicated are supplied for guidance only and as such must be considered incorrect. Potential buyers are advised to recheck measurements before committing to any expense. 4. We have not tested any apparatus, equipment, fixtures, fittings or services and it is in the buyers interest to check the working condition of any appliances.

Burchell Edwards is a trading name of Connells Residential which is registered in England and Wales under company number 1489613, Registered Office is Cumbria House, 16-20 Hockliffe Street, Leighton Buzzard, Bedfordshire, LU7 1GN. VAT Registration Number is 500 2481 05.

See all our properties at www.burchelledwards.co.uk | www.rightmove.co.uk | www.zoopla.co.uk

Property Ref: ERD207961 - 0003