

## 28 Glasshouses Mill, Glasshouses, HG3 5AG

£1,075PCM (Deposit: £1,240)

 2  2  1

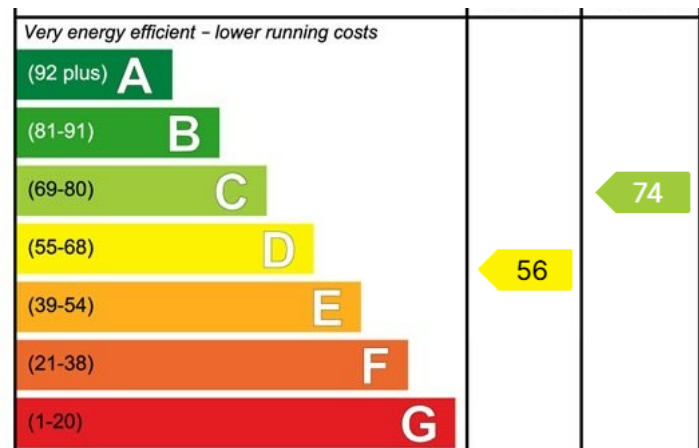

Tax Band: Furnished: Unfurnished

A charming three storey cottage forming part of the stunning Glasshouses Mill development in this sought-after village near Pateley Bridge. Combining character features with quality fittings and neutral décor. Living room with stylish kitchen area, utility cupboard, first floor bedroom and shower room, top floor bedroom with en-suite shower room. Garden and allocated parking.

**APPLICATION INFORMATION** One weeks rent is payable to reserve a property which will then be deducted from the total rent and deposit requested. Properties will remain available until this is paid. On completing an application form on-line, you will need to provide identification (colour copy of passport, driver's licence and a utility bill). The completion and submission of an application form does not guarantee the offer of tenancy, this is subject to satisfactory references being obtained. A deposit equivalent to five weeks rent payable before the commencement of the Tenancy. The first month's rent and deposit must be paid before we will release the keys to the property. Applicants must show evidence of their contents insurance prior to the start of a tenancy. Payments can be made by bank transfer only. Personal cheques are not acceptable.

- Stunning Town House
- Open-Plan Living Space
- Utility Cupboard
- Quality Fixtures & Fittings
- Outside Space & Parking
- Part of Glasshouses Mill
- Kitchen with Appliances
- Excellent Storage
- Fabulous En-Suite Bedroom
- Lovely Nidderdale Setting



2ND FLOOR  
230 sq.ft. (21.3 sq.m.) approx.

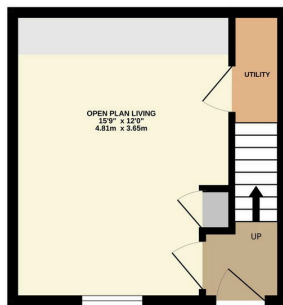

GROUND FLOOR  
233 sq.ft. (21.6 sq.m.) approx.

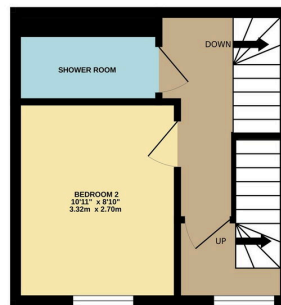

1ST FLOOR  
225 sq.ft. (20.9 sq.m.) approx.

TOTAL FLOOR AREA : 687 sq.ft. (63.9 sq.m.) approx.

Whilst every attempt has been made to ensure the accuracy of the floorplan contained here, measurements of doors, windows, rooms and any other items are approximate and no responsibility is taken for any error, omission or mis-statement. This plan is for illustrative purposes only and should be used as such by any prospective purchaser. The services, systems and appliances shown have not been tested and no guarantee as to their operability or efficiency can be given.  
Made with Metropix ©2026