



FOR SALE

3 Bed Semi-Detached House in Carlton Drive, Wigston LE18 1DF
Offers In Excess Of £220,000

Situated along the highly regarded Carlton Drive in the heart of Wigston, this attractive three bedroom semi-detached home offers fantastic potential for further improvement and modernisation throughout. Occupying a generous plot, the property boasts a distinctive architectural design, ample off-road parking, detached garage and mature gardens, making it an ideal investment opportunity or family project home. Offered to the market with no upward chain, the property is conveniently positioned close to local amenities, schools and transport links.



GROUND FLOOR
439 sq.ft. (40.8 sq.m.) approx.

1ST FLOOR
440 sq.ft. (40.8 sq.m.) approx.

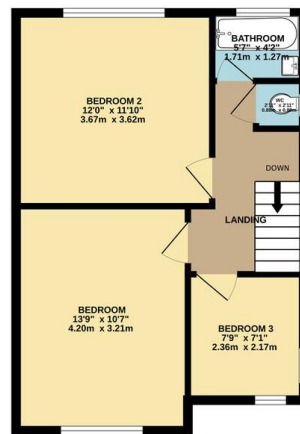
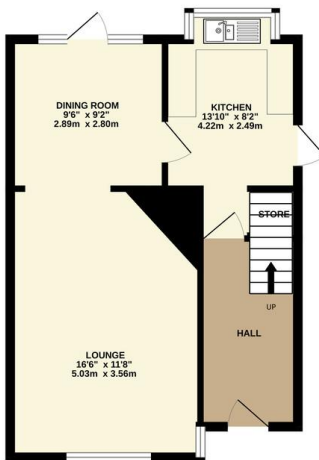

TOTAL FLOOR AREA: 879 sq.ft. (81.6 sq.m.) approx.
While every attempt has been made to ensure the accuracy of the description contained here, measurements of doors, windows, rooms and any other items are approximate and no responsibility is taken for any error, omission or misstatement. This plan is for illustrative purposes only and should be used as such by any prospective purchaser. The services, systems and appliances shown have not been tested and no guarantee as to their operability or efficiency can be given.
Made with Metropro ©2020

EPC Ordered

- Three Bedroom Semi Detached Home
- Offered Chain Free
- Requires Modernisation Throughout
- Popular Wigston Location
- Located On Carlton Drive
- Excellent Family Project Home
- Large Mature Plot
- Detached Garage To Rear

Agents Note: Whilst every care has been taken to prepare these sales particulars, they are for guidance purposes only. All measurements are approximate are for general guidance purposes only and whilst every care has been taken to ensure their accuracy, they should not be relied upon and potential buyers are advised to recheck the measurements.

