



52 Heriot Street, Liverpool

£850 PCM

Welcome to City Residence—a stunning one-bedroom apartment situated in a brand new development on Heriot Street, Liverpool.

This contemporary living space offers an open-plan living room with expansive windows that provide picturesque views of a nearby field, flooding the room with natural light.

The sleek, matte black kitchen is a culinary enthusiast's dream, featuring integrated appliances that blend seamlessly into the modern design. The double bedroom is spacious and inviting, offering a peaceful retreat at the end of the day. The property also boasts a chic, modern bathroom with a walk-in shower, perfect for unwinding.

Located close to convenient transport links, this apartment is ideal for professionals or couples seeking a stylish and convenient lifestyle in Liverpool. Don't miss out on the opportunity to make this exceptional property your new home.

Deposit - £980
Holding Deposit - £190
Tax Band A
Available 3rd August 2026



GROUND FLOOR
397 sq.ft. (36.9 sq.m.) approx.

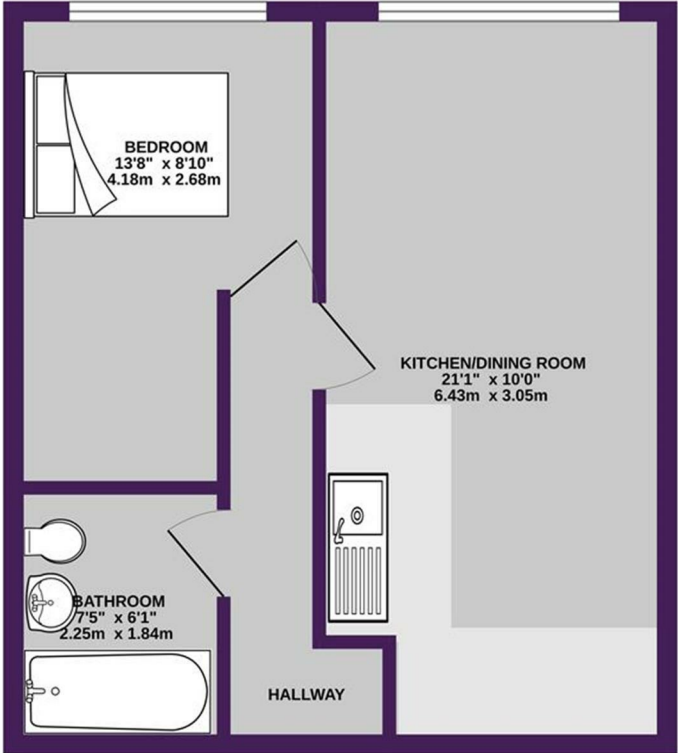

1 BEDROOM APARTMENT

TOTAL FLOOR AREA : 397 sq.ft. (36.9 sq.m.) approx.

Whilst every attempt has been made to ensure the accuracy of the floorplan contained here, measurements of doors, windows, rooms and any other items are approximate and no responsibility is taken for any error, omission or mis-statement. This plan is for illustrative purposes only and should be used as such by any prospective purchaser. The services, systems and appliances shown have not been tested and no guarantee as to their operability or efficiency can be given.
Made with Metropix ©2024



Energy Efficiency Rating		Environmental Impact (CO ₂) Rating	
Score	Band	Score	Band
92-100	A	100-120	A
81-91	B	90-100	B
69-80	C	80-90	C
58-68	D	70-80	D
47-57	E	60-70	E
35-46	F	50-60	F
23-34	G	40-50	G

Energy Efficiency Rating: 78 (Band G)

Environmental Impact (CO₂) Rating: 78 (Band G)