



Espalier Gardens, NW6

£475,000

A stylish one bedroom modern apartment in the sought after Espalier Gardens development, featuring a semi open plan kitchen/living room, integrated appliances, utility cupboard, lift access and a private balcony.

Espalier Gardens is superbly located just moments from cafés, restaurants, shops and the open spaces of Queen's Park and Kilburn Grange Park. Excellent transport links include Kilburn Underground (Jubilee Line), Brondesbury Overground and Kilburn High Road stations, providing easy access across London.

Features

- One Bedroom
- Private Balcony
- Close To Station
- Modern Apartment
- Utility Cupboard
- Lift Access

Espalier Gardens, London, NW6

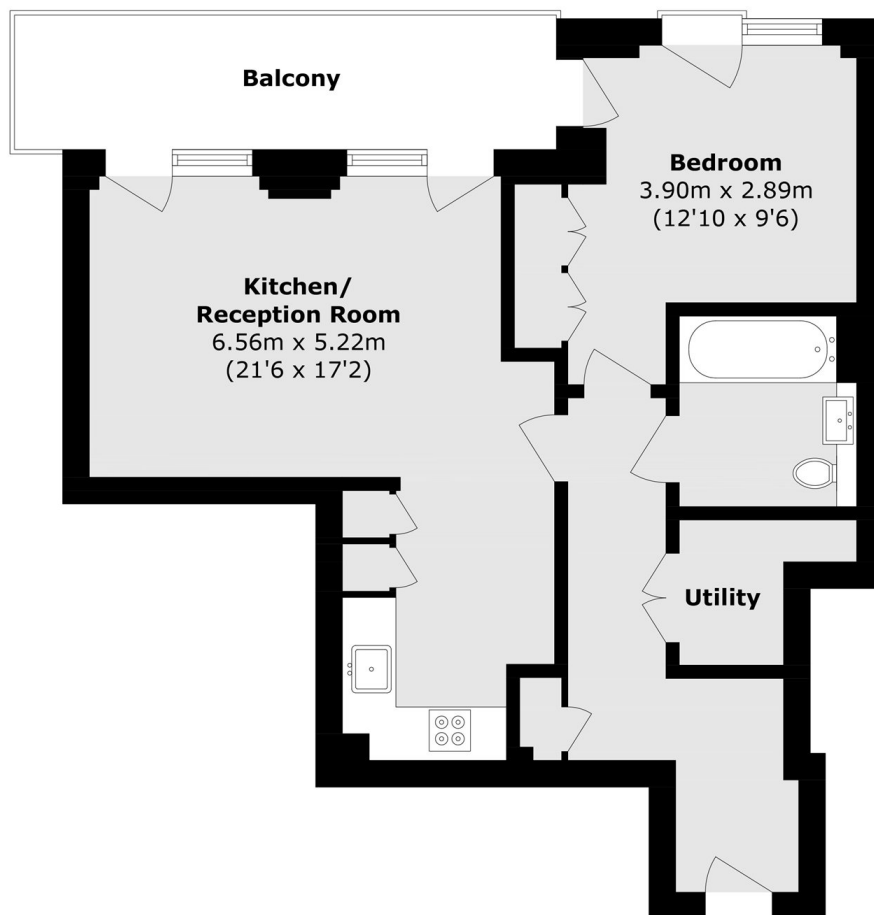

Total area (approx.): 52.1 sq. m (560.8 sq. ft)
Balcony area (approx.): 9.2 sq. m (99.0 sq. ft)