

[www.jeffreygross.co.uk](http://www.jeffreygross.co.uk)

CARDIFF

VALE

CAERPHILLY

BRISTOL



*Richards Terrace*

ROATH





Comments by Mr Rhys Carter



**Property Specialist**  
**Mr Rhys Carter**  
Senior valuer

rhys.carter@jeffreygross.co.uk

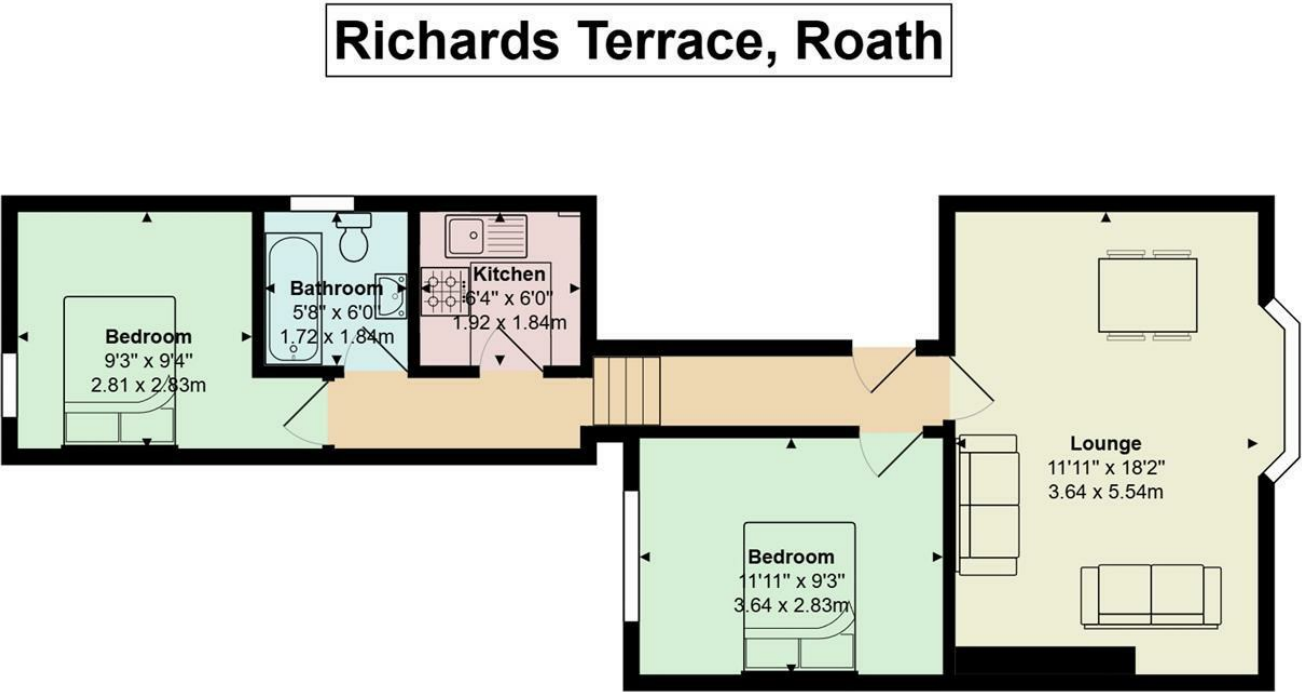

Total Area: 591 ft² ... 54.9 m²

All measurements are approximate and for display purposes only

Comments by the Homeowner





# Richards Terrace

Roath, Cardiff, CF24 1RW

PCM

£850 PCM



2 Bedroom(s)



1 Bathroom(s)



591.00 sq ft



Contact our  
*Penylan Branch*  
02920 499680

Within walking distance of Cardiff City Centre and on the convenient Richards Terrace, Roath is this extremely spacious two-bedroom first-floor flat. Available furnished or unfurnished the property offers a great living space with large lounge / diner, spearate kitchen with gas hob, two double bedrooms and bathroom with shower and bath over. The property further benefits gas central heating, street parking options and from being close to the action in Roath and Adamsdown.

EPC RATING of C  
COUNCIL TAX BAND of C

A holding fee of one weeks' rent will be payable to secure the dwelling. This will be deducted from the final balance payable upon moving into the dwelling, subject to a successful application. Jeffrey Ross Limited reserves the right to retain this payment should the applicant have provided false or misleading information at the time of applying for the dwelling or failed to take reasonable steps to enter into the Standard Occupation Contract.

CARDIFF

VALE

CAERPHILLY

BRISTOL

[www.jeffreygross.co.uk](http://www.jeffreygross.co.uk)



