

HUNTERS®

HERE TO GET *you* THERE

Flat 8, Lewis Court Snelling Avenue, Northfleet, Gravesend, DA11 7EA

Asking Price £90,000

Property Images



HUNTERS®

HERE TO GET *you* THERE

GROUND FLOOR
245 sq.ft. (22.7 sq.m.) approx.

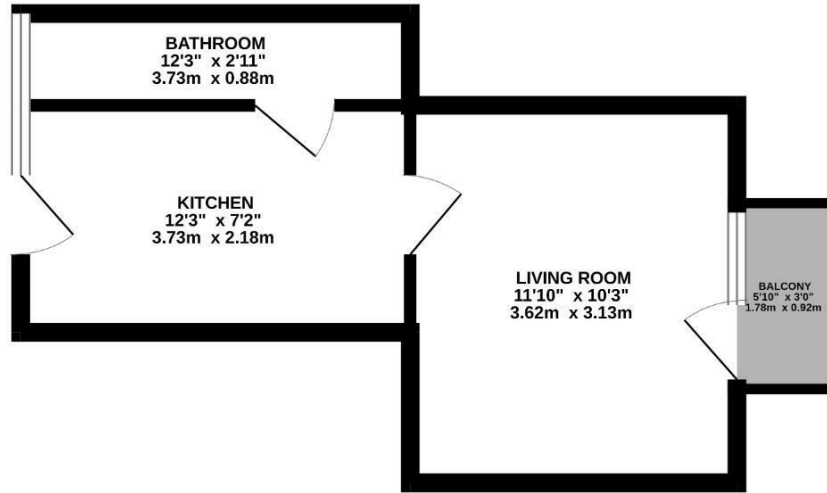

LEWIS COURT, SNELLING AVENUE, DA11

TOTAL FLOOR AREA : 245 sq.ft. (22.7 sq.m.) approx.

Whilst every attempt has been made to ensure the accuracy of the floorplan contained here, measurements of doors, windows, rooms and any other items are approximate and no responsibility is taken for any error, omission or mis-statement. This plan is for illustrative purposes only and should be used as such by any prospective purchaser. The services, systems and appliances shown have not been tested and no guarantee as to their operability or efficiency can be given.
Made with Metropix ©2026

EPC

Energy Efficiency Rating		Current	Potential
<i>Very energy efficient - lower running costs</i>			
(92 plus) A			
(81-91) B			
(69-80) C		72	72
(55-68) D			
(39-54) E			
(21-38) F			
(1-20) G			
<i>Not energy efficient - higher running costs</i>			
England & Wales	EU Directive 2002/91/EC		

Map

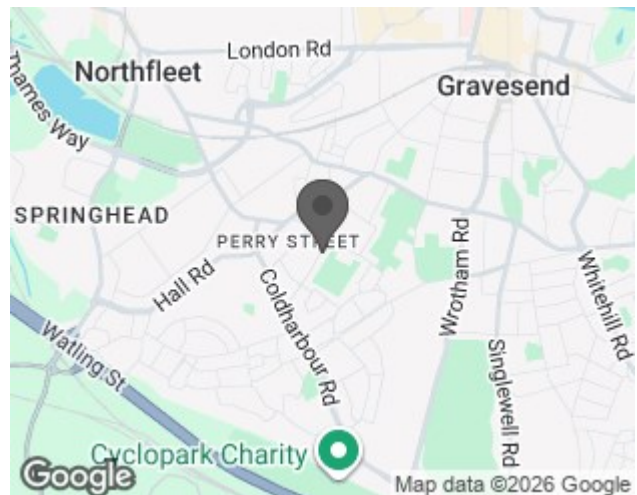

Details

Type: Studio Beds: null Bathrooms: 1 Receptions: 1 Tenure: Leasehold

Summary

Offered with NO FORWARD CHAIN we present this studio flat in need of some updating, providing a great opportunity for anyone looking to get onto the property ladder or investment purchase.

The flat is located on the top floor and comprises of kitchen, shower room and living room which comes with the added bonus with having a balcony.

The property is situated near local amenities, schools, and transport links, making it an excellent choice for those who commute or enjoy the convenience of nearby shops and services.

Call now to arrange a viewing!

Features

- STUDIO FLAT • TOP FLOOR • LIVING ROOM • KITCHEN • SHOWER ROOM • BALCONY • CHAIN FREE • GREAT FIRST TIME PURCHASE OR INVESTMENT • IN NEED OF MODERNISATION • EPC RATING C