



## **3 Bedroom Riverside Apartment Charter Quay, Kingston Upon Thames. £865,000 - Share of Freehold**

Superbly positioned on an enviable setting within the Charter Quay Development, a rarely available south facing 3 bedroom 2 bathroom riverside apartment with outstanding river views.

The entire apartment has been refurbished to an exemplary standard, is located on the 2nd floor and boasts 832 sq ft of internal living space. Spacious reception room a fitted high specification modern kitchen and doors to the south facing private balcony with stunning views along the river.

Principal Bedroom with fitted wardrobes and an ensuite shower room, 2<sup>nd</sup> bedroom with fitted wardrobes, a further 3<sup>rd</sup> bedroom and a luxury shower room. Charter Quay is ideally located on the banks of the river Thames, with secure underground parking. 24hr concierge, secure underground parking, residents' health suite and lift service.

[WWW.STACKANDBONNER.COM](http://WWW.STACKANDBONNER.COM)

020 8547 1234

[sales@stackandbonner.com](mailto:sales@stackandbonner.com)



Stevens House, Jerome Place, Charter Quay,  
Kingston upon Thames KT1  
Approximate Gross Internal Area  
77.26 sq m / 832 sq ft  
( CH = Ceiling Heights)

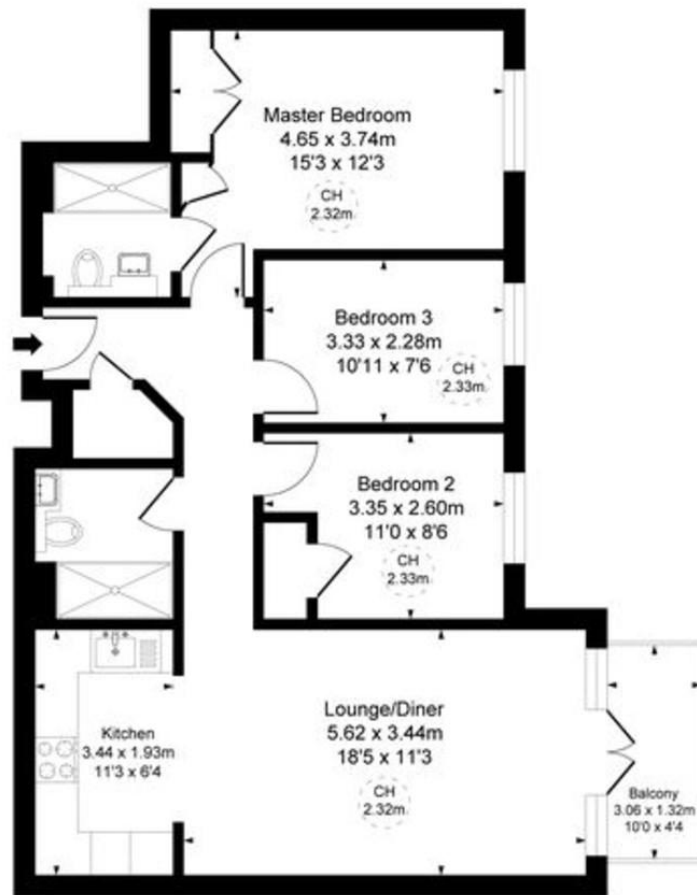

Second Floor

This plan is not to scale. It is for guidance and not for valuation purposes.  
All measurements and areas are approximate only, and have been prepared in accordance with the current edition of theRICS Code of Measuring Practice.

- 3 Bedroom Riverside Apartment
- Outstanding Southerly River Views
- Refurbished to an exemplary standard
- Private South Facing Balcony
- Spacious Reception Room with a high specification kitchen
- 2 Luxury Shower Rooms
- 2<sup>nd</sup> Floor
- 832 sq ft
- Secure Underground Allocated Parking Space
- No onward Chain
- 24hr Concierge Service
- Residents Health Suite
- Lift Service
- Share of Freehold with a 973 year underlying lease
- Service Charge: £4,331.16 plus a reserve fund contribution of £1,439.02 = £5,770.18 per annum
- Council Tax: Band G - £4,346.87 per annum