



BREENS

Mapleton Crescent

Enfield · EN3

ASKING PRICE

£470,000

FREEHOLD



BREENS

THE HOME

Mapleton Crescent

Enfield · EN3

KEY FEATURES

- 1930s Three Bedrooms End Of Terrace Family House
- 24FT Living Reception Room
- Fitted Kitchen
- Conservatory/Utility Room
- First Floor Shower Room (Power Shower)
- Gas Central Heating And Double Glazing
- Approximately 60FT Well Maintained Private Rear Garden With Side/Rear Access
- Driveway With Parking For Two Vehicles
- Well Maintained Throughout
- Popular Residential Turning

EPC RATING

C

COUNCIL TAX BAND

D

3

BEDROOMS

1

BATHROOMS

1

RECEPTIONS



Ground Floor

Approx. 48.6 sq. metres (522.6 sq. feet)

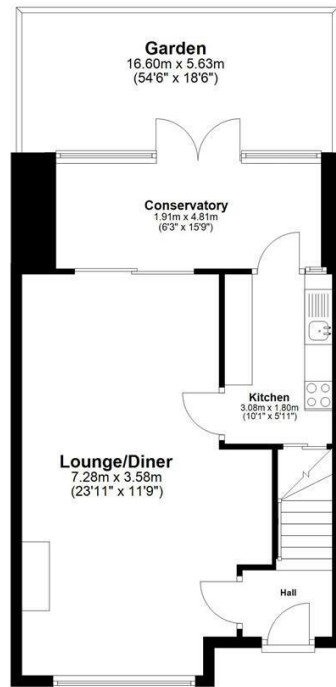

First Floor

Approx. 31.6 sq. metres (339.7 sq. feet)

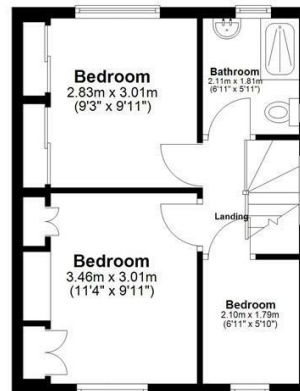

Total area: approx. 80.1 sq. metres (862.4 sq. feet)

All measurements have been taken as a guide to prospective buyers only and are not precise. This plan is for illustrative purposes only and no responsibility for any error, omission or misstatement. The services, systems and appliances shown have not been tested and no guarantee as to their operability or efficiency can be given. Measurements may have been taken from the widest area and may include wardrobe/cupboard space. No guarantee is given to any measurements including total areas. Buyers are advised to take their own measurements.

© @modephotouk | www.modephoto.co.uk
Plan produced using PlanUp.□

Mapleton Crescent

GET IN TOUCH

020 8804 8989

enfield@breens.property

www.breens.property

VISIT US

557- 559 Hertford Road, Enfield, EN3 5UQ

These particulars are intended as a general guide and are believed to be correct, but their accuracy is not guaranteed and they do not form part of any offer or contract. All measurements are approximate and for guidance only. The Agent has not tested any apparatus, equipment, fixtures, fittings or services and cannot verify they are in working order or fit for purpose. Photographs are for illustration only and may depict items that are not for sale or included in the sale price. References to tenure are based on information supplied by the vendor; the Agent has not seen the title documents, and buyers should obtain verification from their solicitor or surveyor. Under the Money Laundering Regulations 2017, intending purchasers will be asked to produce identification and documentation at a later stage. These particulars are issued on the condition that all negotiations are conducted through Breens Estate Agents. Subject to contract and availability.