

***To arrange a viewing contact us
today on 01268 777400***



Ramuz Drive, Westcliff-on-sea, Southend-on-sea, Guide price £225 000

Aspire Estate Agents are delighted to present this beautifully maintained three bedroom Edwardian-style terraced home, perfectly positioned in the heart of Westcliff-on-Sea.

Boasting an attractive bay-fronted façade and charming period features throughout, this impressive property blends character and modern convenience, making it ideal for families, professionals and commuters alike. Situated within walking distance of Westcliff's vibrant restaurants, bars and theatre district, as well as excellent schools and transport links, the location is as appealing as the home itself.

The ground floor offers a bright and spacious open-plan lounge/diner, enhanced by a stunning front-facing bay window that fills the room with natural light, perfect for both relaxing evenings and entertaining guests. This leads seamlessly into a practical and well-appointed kitchen with ample storage and workspace.

Upstairs, the property features two generous double bedrooms, a well-proportioned single bedroom and a modern three-piece family bathroom, all presented to a high standard. Externally, a large and well-maintained rear garden provides excellent outdoor space for dining, entertaining or family use.

Further benefits include double glazing, gas central heating and retained period character throughout.

A superb bay-fronted period home in a highly desirable central location — early viewing is strongly advised.

Location & Distances (approx.)

Entrance Hall

Lounge/Diner: 22' x 11'8 (6.71m x 3.56m)

Kitchen: 8'10 x 6'2 (2.69m x 1.88m)

Bedroom One: 15'6 x 10'8 (4.72m x 3.25m)

Bedroom Two: 12'6 x 10'8 (3.81m x 3.25m)

Bedroom Three: 7'10 x 6'2 (2.39m x 1.88m)

Bathroom

Garden

GROUND FLOOR

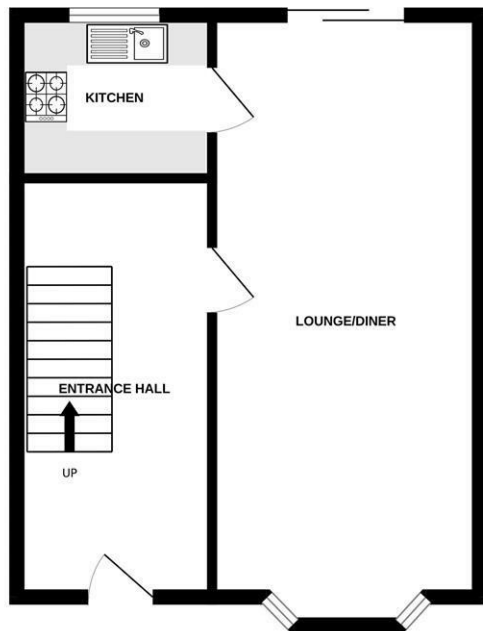

1ST FLOOR

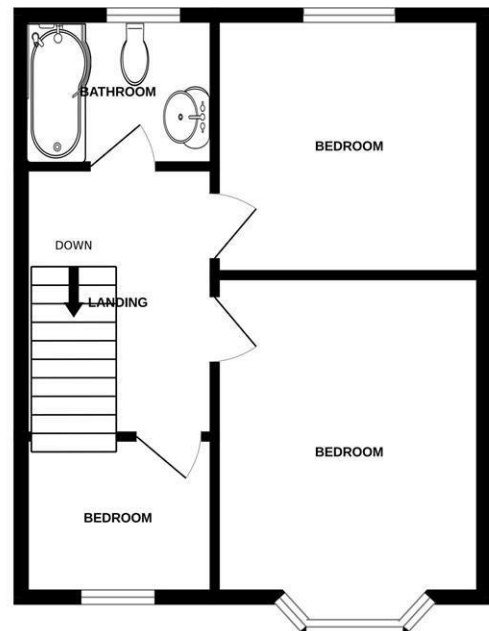

Whilst every attempt has been made to ensure the accuracy of the floorplan contained here, measurements of doors, windows, rooms and any other items are approximate and no responsibility is taken for any error, omission or mis-statement. This plan is for illustrative purposes only and should be used as such by any prospective purchaser. The services, systems and appliances shown have not been tested and no guarantee as to their operability or efficiency can be given.
Made with Metropix ©2026

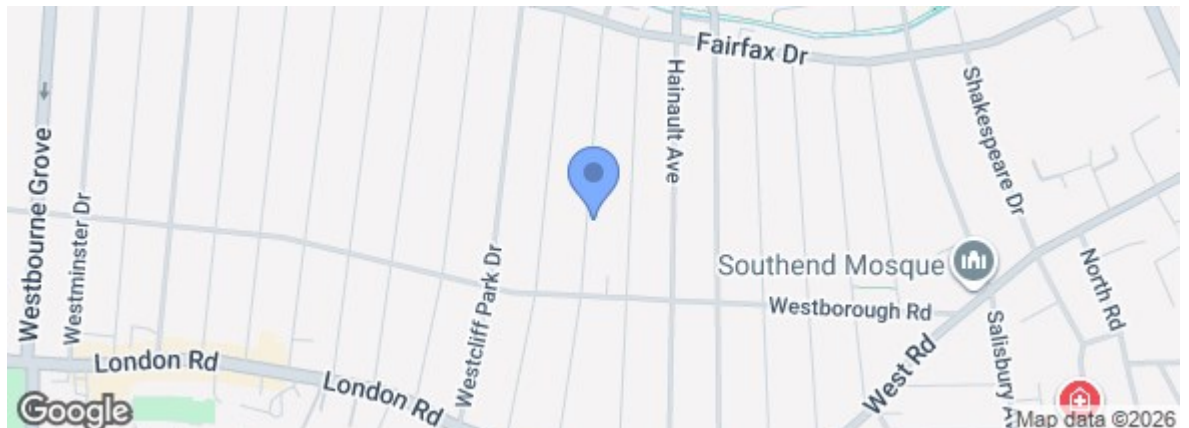
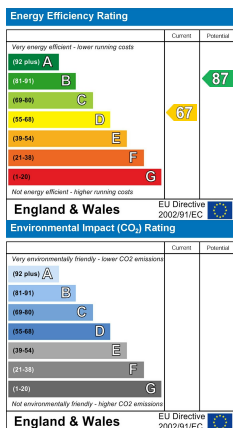

Under the Property Misdescriptions Act 1991 we make every effort to ensure our sales details are accurate but they are a general outline and do not constitute any part of an offer or contract. Any services, equipment and fittings have not been tested and no warranty can be given as to their condition. We strongly recommend that all the information provided be verified by your advisors and in particular, measurements required for a specific purpose such as fitted furniture or carpets. Please tell us if you have any problems and members of our branches will help either over the phone or in person. A copy of our complaints procedure is available on request. The details are issued on the strict understanding that any negotiations in respect of the property named herein are conducted through Aspire Estate Agents.