



38 Beechwood Drive, Ormskirk

Ormskirk

Guide Price £290,000

38 Beechwood Drive

Ormskirk

Extended three-bedroom semi with spacious living, ample parking, detached garage, and a lovely garden. Close to schools, transport, and town centre. Ideal family home in a sought-after area. Council Tax band: C

Tenure: Freehold

- Extended three-bedroom semi-detached family home
- Detached garage offering additional parking or storage
- Three well-proportioned first-floor bedrooms
- Beautiful mature rear garden with patio area
- Excellent location close to highly regarded schools, local amenities and easy access to the town centre





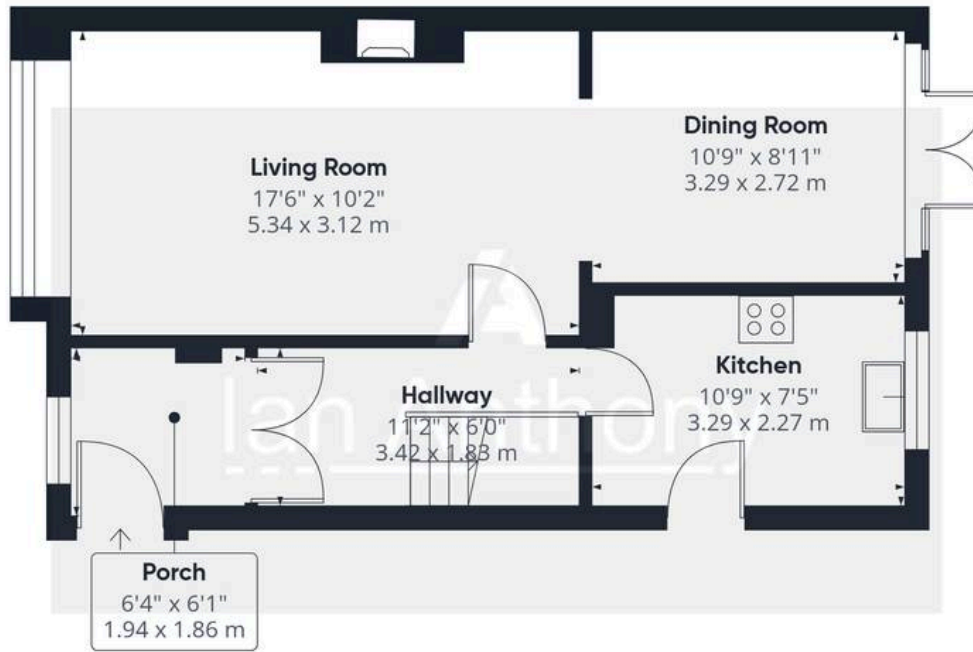

Ground Floor



Floor 1



Approximate total area⁽¹⁾

838 ft²

77.8 m²

(1) Excluding balconies and terraces

Calculations reference the RICS IPMS 3C standard. Measurements are approximate and not to scale. This floor plan is intended for illustration only.

GIRAFFE360



IAN ANTHONY

5 Burscough Street, Ormskirk - L39 2EG

01695580888

enquiries@iananthonyestates.co.uk

iananthonyestates.co.uk/

