

IMPORTANT NOTICE Wilkie May & Tuckwood for themselves and for the vendors of the property, whose agents they are, give notice that the particulars are intended to give a fair and substantially correct overall description for the guidance of intending purchasers and do not constitute part of an offer or contract. Prospective purchasers and lessees ought to seek their own professional advice. 2. All descriptions, dimensions, areas, references to condition and necessary permissions for use and occupation and other details are given in good faith, and are believed to be correct, but any intending purchasers should not rely on them as statements or representations or fact but must satisfy themselves by inspection or otherwise as to the correctness of each of them. 3. No person in the employment of Wilkie May & Tuckwood has any authority to make or give any representations or warranty. 4. No responsibility can be accepted for any expenses incurred by whatever in relation to this property on behalf of Wilkie May & Tuckwood, nor enter into any contract on behalf of the vendor. 5. Measurements are approximate and have been taken by the vendor. Measurements are approximate and have been taken by the vendor. While we endeavour to make our sales particular accurate and reliable, if there is any point which is of particular importance to you, please contact the office and we will be pleased to check the information with you. We routinely refer potential sellers and purchasers to a selection of recommended local conveyancing firms. It is their decision whether to use those services. In making that decision, it should be known that we receive a payment benefit of not more than £150+VAT. Once an offer is accepted by our client, an Administration Fee of £20+VAT (£24) per buyer will be required in order to process the necessary checks relating to our compliance under Anti-Money Laundering legislation. This is a non-refundable payment and cannot be returned should purchase cease to continue. It can be paid via a card machine, or via BACS transfer. Code of Practice for Residential Estate Agents: Effective from 1 August 2011. 8. Financial Evaluation. At the time that an offer has been made and is being considered by the seller, you must take reasonable steps to find out from the prospective buyer the source and availability of his funds for buying the property and pass this information to the seller. Such information will include whether the prospective buyer needs to sell a property, requires a mortgage, claims to be a cash buyer or any combination of these. Such relevant information that is available should be included in the Memorandum of Sale having regard to the provisions of the Data Protection Act. These reasonable steps must continue after acceptance of the offer until exchange of contracts (in Scotland, conclusion of missives) and must include regular monitoring of the prospective buyer's progress in achieving the funds required, and reporting such progress to the seller. The agent has not tested any apparatus, equipment, fixtures and fittings or services and so cannot verify that they are in working order or fit for their purpose. A Buyer is advised to obtain verification from their solicitor or surveyor. References to the Tenure of the Property are based on information supplied by the Seller. The agent has not had sight of the title documents. A Buyer is advised to obtain verification from their solicitor.

GENERAL REMARKS AND STIPULATIONS:
Tenure: Freehold
Services: All mains service, mains electricity, mains gas, mains drainage, mains water
Local Authority: Somerset Council, County Hall, The Crescent, Taunton, TA1 4DY
Property Location: <https://what3words.com/allergy.trinkets.confronts>
Council Tax Band: E
Broadband Availability: Ultrafast up to 900 Mbps download & 900 Mbps Upload
Mobile Phone Coverage: <https://www.ofcom.gov.uk/mobile-coverage-checker>
Flood Risk: Surface water - Very low Rivers & Sea - Very low



Cranbelle

Minehead Road, Bishops Lydeard, TA4

3BS

£550,000 Freehold



Wilkie May & Tuckwood

Floor Plan

Minehead Road, Bishops Lydeard, Taunton, TA4

Approximate Area = 1648 sq ft / 153.1 sq m

Garage = 164 sq ft / 15.2 sq m

Outbuilding = 119 sq ft / 11 sq m

Total = 1931 sq ft / 179.3 sq m

For identification only - Not to scale

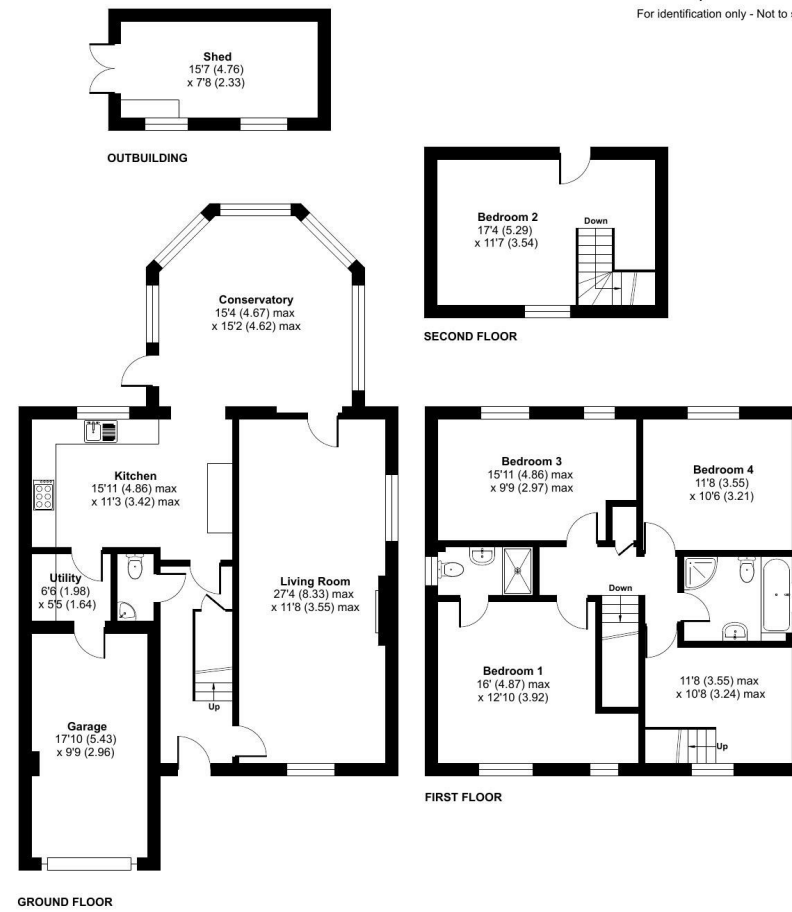

Floor plan produced in accordance with RICS Property Measurement 2nd Edition, Incorporating International Property Measurement Standards (IPMS2 Residential). © nrichcom 2026. Produced for JREA Ltd TA Wilkie May & Tuckwood, Taunton. REF: 1401428

WM&T

Description

- Detached Family Home
- Garage & Driveway
- Double Glazing & Gas Central Heating
- Spacious Accommodation Arranged Over Three Floors
- Close to the Village Centre

Located in the heart of the sought-after village of Bishops Lydeard, is this spacious and beautifully presented four-bedroom detached family home which offers comfortable living across three floors.

The property benefits from uPVC double glazing throughout and is warmed via a mains gas-fired central heating system.

Outside, the home enjoys a generous South-facing rear garden, ideal for families or entertaining. To the front of the property, there is a single garage and a driveway providing off-road parking for up to three vehicles.



The accommodation comprises in brief: double-glazed front door opens into a welcoming entrance hallway with stairs rising to the first floor. Just off the hallway is a useful ground floor cloakroom fitted with a low-level WC and wash hand basin. The spacious living room enjoys a front-facing aspect and leads into a large sunroom featuring tiled flooring, vaulted ceilings, and direct access to the rear garden - an ideal space for relaxing or entertaining. The kitchen, also accessed from the hallway, offers a range of matching wall and base units with work surfaces over, a sink with hot and cold mixer tap, an integrated dishwasher, and a range cooker with extractor fan above. Adjacent to the kitchen is a practical utility room providing additional work surfaces, space and plumbing for a washing machine, and space for a tumble dryer. From the utility room, there is internal access into the garage, which benefits from power and lighting. Upstairs, the first floor offers three well-proportioned bedrooms, including a

generous master with an en-suite shower room. The family bathroom is fitted with a panelled bath, separate shower cubicle, low-level WC, and wash hand basin. The fourth bedroom features a staircase leading up to a second-floor hobbies room. This versatile space includes spotlighting, a front-facing window, and a large storage area within the eaves. Externally, the rear garden is predominantly laid to lawn with a patio area. Additional features include an outside tap, side access, and a large timber shed/workshop with power and lighting. To the front of the property there is a driveway which provides off-road parking for up to three vehicles and access into the garage via an up-and-over door.

WM&T