



Manor Road

Guildford, Guildford

Modern two-bedroom top floor maisonette on Manor Road with private entrance, open-plan living, bath and shower, free parking, near amenities and Guildford station. Available immediately.

Council Tax band: B

Tenure: Leasehold

EPC Energy Efficiency Rating: D

EPC Environmental Impact Rating: D

- Two Bedrooms
- First Floor Maisonette
- Private Entrance
- Available Immediately
- Open Plan Kitchen and Lounge

GROUND FLOOR
43 sq.ft. (4.0 sq.m.) approx.

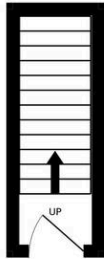

FIRST FLOOR
408 sq.ft. (38.3 sq.m.) approx.

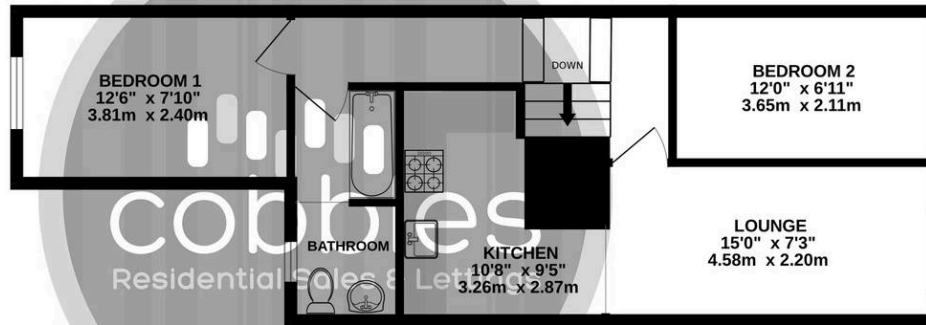

TOTAL FLOOR AREA: 541 sq.ft. (50.3 sq.m.) approx.

Whilst every attempt has been made to ensure the accuracy of the floorplan contained here, measurements of doors, windows, rooms and any other items are approximate and no responsibility is taken for any error, omission or mis-statement. This plan is for illustrative purposes only and should be used as such by any prospective purchaser. The services, systems and appliances shown have not been tested and no guarantee as to their operability or efficiency can be given.
Made with Metropix ©2026

