

EADON
LOCKWOOD
& RIDDLE
ESTD 1840

43 Murray Road

Banner Cross, Sheffield, S11 7GF

Offers Over £280,000



43 Murray Road



Description

This is a great opportunity for first time buyers to get on the property ladder in such a desirable area. This lovely terrace has 1090 square feet of accommodation (including the cellar) over three floors and is available to buy with no onward chain. The location is first class, just around the corner from the excellent amenities on Banner Cross and very close to the fashionable neighbourhood of Sharrowvale. The park is situated at the bottom of the hill and there are excellent transport links into town.

- Three bedrooms including two good doubles.
- Dining room having the original crockery cupboards and a garden view.
- Modern bathroom.
- No onward chain.
- Council Tax Band B.
- Lounge with decorative fireplace.
- Smart, offshot kitchen with timber worksurfaces.
- End of run, private garden to the rear with an attached store.
- 800 year lease from 1902 at a nominal annual ground rent.
- Gas central heating and UPVC double glazing provide a good EPC rating of C69.





Floor Plan

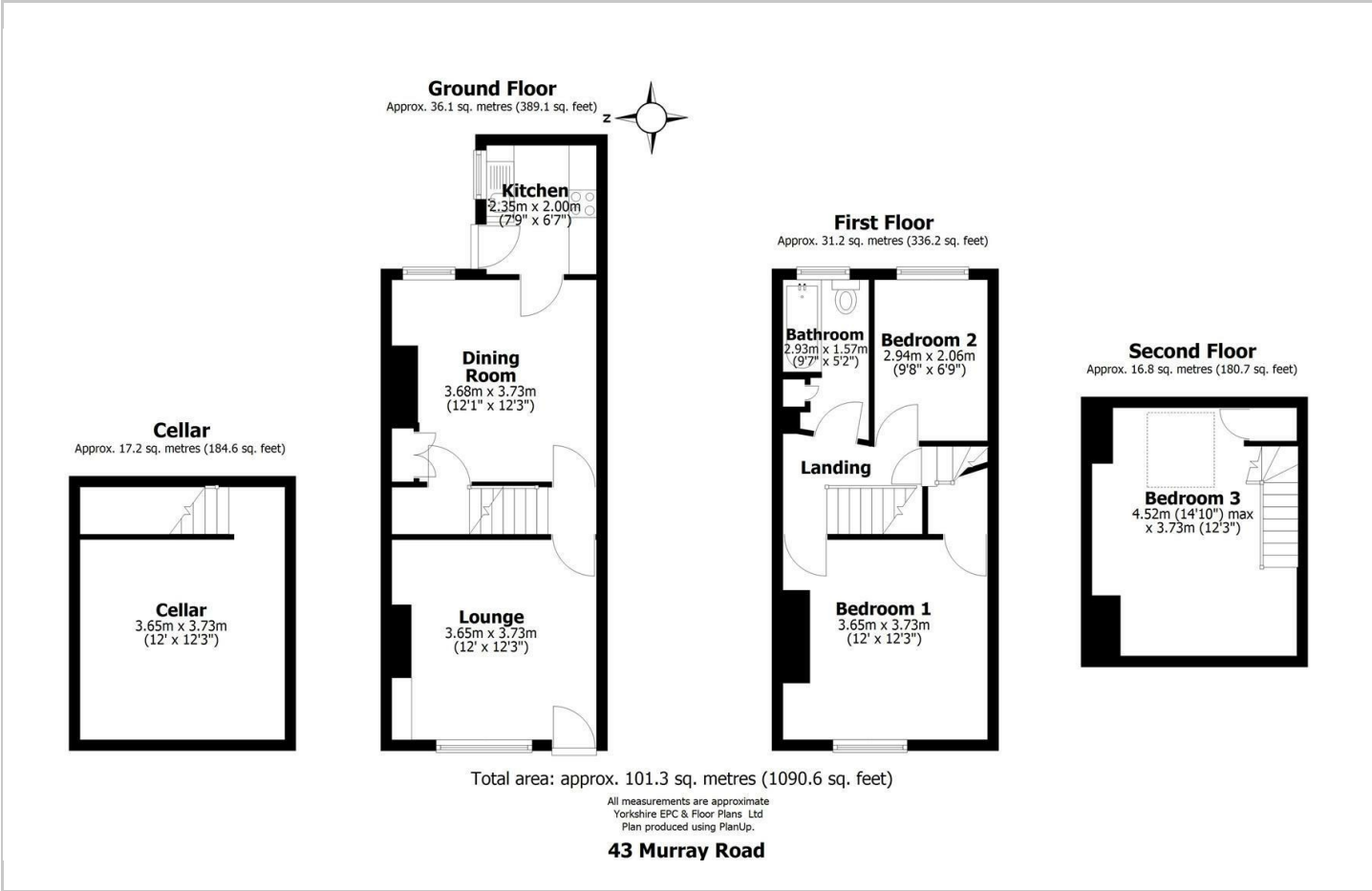

Area Map

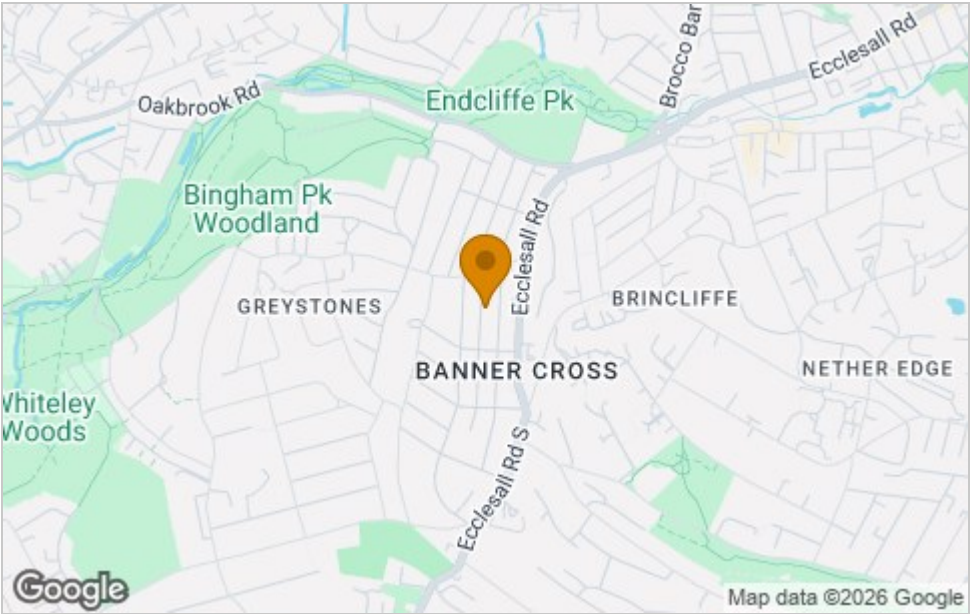

Viewing

Please contact our ELR Banner Cross Office on 0114 268 3388 if you wish to arrange a viewing appointment for this property or require further information.

These particulars, whilst believed to be accurate are set out as a general outline only for guidance and do not constitute any part of an offer or contract. Intending purchasers should not rely on them as statements of representation of fact, but must satisfy themselves by inspection or otherwise as to their accuracy. No person in this firms employment has the authority to make or give any representation or warranty in respect of the property.

Eadon Lockwood and Riddle, 888 Ecclesall Road, Sheffield, South Yorkshire, S11 8TP
Tel: 0114 268 3388 Email: bannercross@elr.co.uk <https://www.elr.co.uk>

Energy Efficiency Graph

