

JENNIE JONES

EST. 1993

ESTATE AGENTS



SMYTH CLOSE

Peasenhall | Suffolk

£215,000

8 SMYTH CLOSE, PEASENHALL IP17 2HE

Saxmundham – 3 miles
Framlingham – 7 miles
Sizewell – 9 miles

- Entrance Hall ● Cloakroom ● Kitchen ●
- Sitting Room ● Conservatory ● Landing ●
- 2 Bedrooms ● Family Bathroom ●
- Courtyard Garden ● Allocated Parking ●

The Property

A charming two bedroom home set within the heart of the ever popular village of Peasenhall, offering well proportioned accommodation and excellent potential for a buyer to enhance and personalise.

The property comprises a welcoming sitting room, a fitted kitchen, and to the rear a bright conservatory with bi-fold doors opening onto the courtyard garden, creating a lovely connection between indoor and outdoor space. The cloakroom completes the downstairs accommodation.

Upstairs, there are two bedrooms and a family bathroom. The property further benefits from double glazing, electric heating, allocated parking and is offered for sale with no onward chain.

Location

Peasenhall is a highly sought-after Suffolk village, well known for its strong community feel and excellent local amenities including a renowned delicatessen, village shop and café. The village is ideally positioned for access to the Suffolk Heritage Coast, with the nearby towns of Saxmundham and Framlingham offering a wider range of facilities.

CHARMING TWO BEDROOM VILLAGE HOME WITH CONSERVATORY AND BI-FOLD DOORS



Services

Mains water, drainage and electricity.

Local Authority and Council Tax Band

East Suffolk Council

Tax Band: B

EPC Rating - D



Approximate Gross Internal Area = 72.4 sq m / 779 sq ft

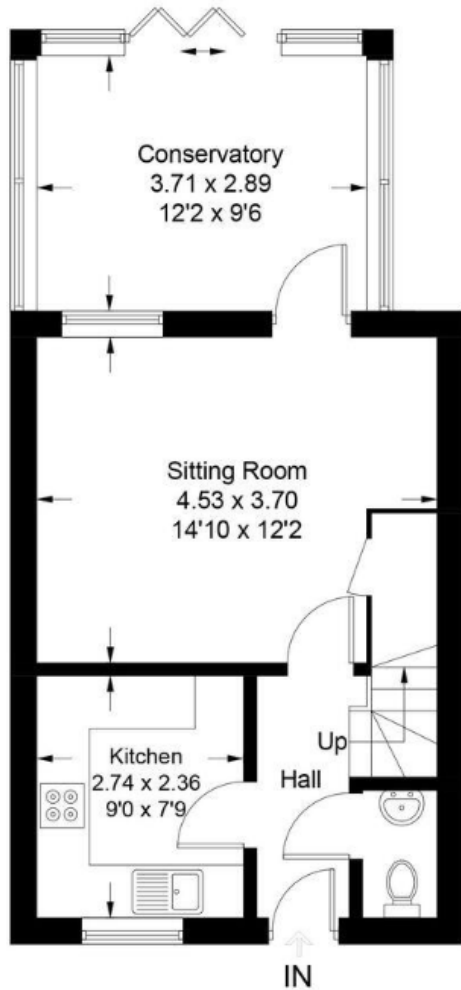

Ground Floor

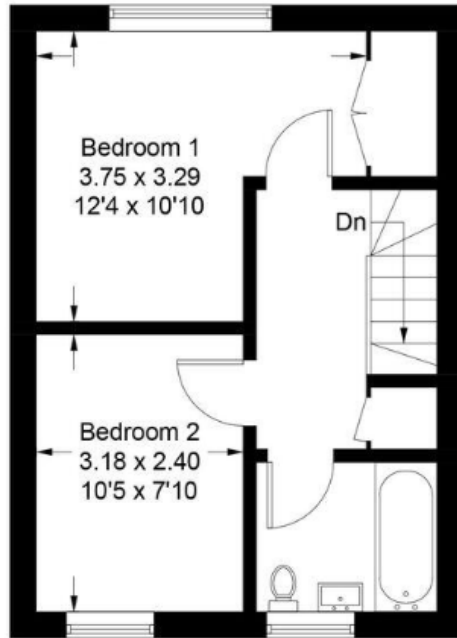

First Floor



Jennie Jones

26 High Street
Saxmundham
Suffolk
IP17 1AB

www.jennie-jones.com
01728 605511

All enquiries:

saxmundham@jennie-jones.com

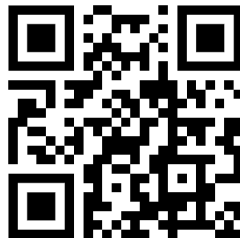

Scan the QR code to
visit our website

rightmove

OnTheMarket



JENNIE JONES

EST. JJ 1993

ESTATE AGENTS