



Smiths Road | Sotterley | Beccles | NR34 7NR

£495,000

DURRANTS
SINCE 1853

Key features

- Never been sold before
- Georgian property
- beautiful grounds
- rural location



Description

A charming three-bedroom cottage set within the picturesque Suffolk countryside, just a short drive from Southwold.



Directions





Floor plans

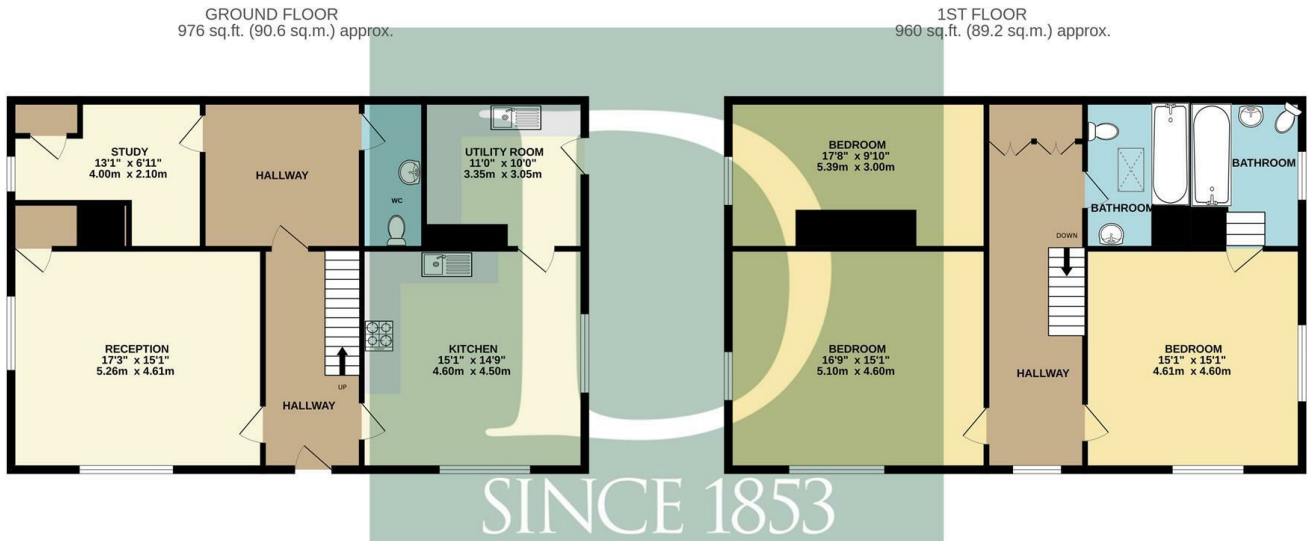

TOTAL FLOOR AREA: 2055sq.ft. (190.9 sq.m.) approx.

Whilst every attempt has been made to ensure the accuracy of the floorplan contained here, measurements of doors, windows, rooms and any other items are approximate and no responsibility is taken for any error, omission or mis-statement. This plan is for illustrative purposes only and should be used as such by any prospective purchaser. The services, systems and appliances shown have not been tested and no guarantee as to their operability or efficiency can be given.
Made with Metropix ©2026

Energy Efficiency Rating		
	Current	Potential
<i>Very energy efficient - lower running costs</i>		
(92 plus) A		
(81-91) B		
(69-80) C		
(55-68) D		
(39-54) E		
(21-38) F		
(1-20) G		
<i>Not energy efficient - higher running costs</i>		
England & Wales	EU Directive 2002/91/EC	



10 New Market

Beccles

Suffolk

NR34 9HA

01502 712122

infobeccles@durrants.com

<https://durrants.com/>