

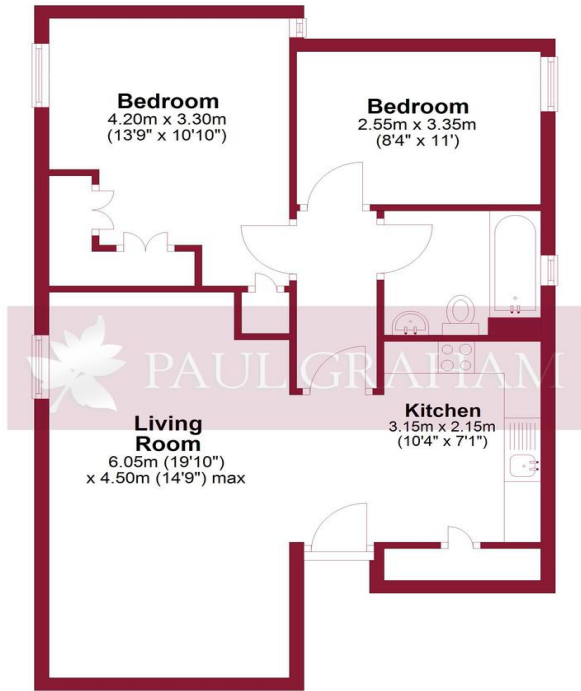

Flat 24 The Albany, Woodcote Road, Wallington, Surrey, SM6 0PS | £270,000 Leasehold

An immaculately presented two bedroom ground floor apartment, ideally situated within easy reach of Wallington town centre and mainline station, offering excellent transport links into Central London. Offered for sale benefiting from a long lease, gas central heating and no onward chain.

Ground Floor
Approx. 62.5 sq. metres (672.9 sq. feet)



Total area: approx. 62.5 sq. metres (672.9 sq. feet)

Floor plan produced in accordance with RICS Property Measurement Standards incorporating International Property Measurement Standards. Produced for Paul Graham. Plan produced using PlanUp.



COMMUNAL ENTRANCE HALL

ENTRANCE HALL

LOUNGE/DINER 19' 10" x 14' 9" (6.05m x 4.5m)

KITCHEN 10' 4" x 7' 1" (3.15m x 2.16m)

BEDROOM 1 13' 9" x 10' 10" (4.19m x 3.3m)

BEDROOM 2 11' x 8' 4" (3.35m x 2.54m)

BATHROOM

LONG LEASE

NO CHAIN

GAS CENTRAL HEATING

CLOSE TO THE TOWN CENTRE



IMPORTANT NOTE: Paul Graham have not tested any services, heating system, appliances, fixtures or fittings. References to the tenure of a property are based on information supplied by the seller as Paul Graham have not had sight of the title documents. Neither has Paul Graham checked any existing or necessary planning consents, building regulations or rights of way. Prospective purchasers are advised to obtain verification from their solicitor or surveyor. PLEASE NOTE: All measurements are approximate and represent the maximum dimensions of any room (into bays and alcoves) and a margin of error should be allowed.

Score	Energy rating	Current	Potential
92+	A		
81-91	B		
69-80	C	74 C	78 C
55-68	D		
39-54	E		
21-38	F		
1-20	G		

WALLINGTON

Residential Sales
3 Wallington Square
Woodcote Road
Wallington
Surrey SM6 8RG

Tel. 020 8669 5201

Email. wallington@paulgraham.co.uk

CARSHALTON

Residential Sales
62 - 64 High Street
Carshalton
Surrey SM5 3AG

Tel. 020 8773 7200

Email. carshalton@paulgraham.co.uk