



Manor Road, London, N17 0JH

welcome to
Manor Road, London

This residence comprises of a welcoming entrance hall which leads onto the bay fronted reception room and kitchen/dining room. As you reach the first floor you will find three good-sized bedrooms as well as the fitted family bathroom and extra WC. The South facing 63ft long rear garden is accessed via the kitchen. Northumberland Park Station is located 0.2 miles away with White Hart Lane Station located 0.6 miles away.

This residence offers great potential to add value and by extending into the loft, the rear or creating a summer house subject to the necessary planning consents.





Entrance Hall

Wood laminate floor, radiator.

Lounge

Double glazed bay window to front, wood laminate floor, fireplace.

Kitchen / Breakfast Room

Range of wall and base units with contrasting worksurface, space for fridge-freezer, electric oven and gas hob with extractor fan, tiled floor, radiator, double glazed window to side, double glazed French doors to garden.



First Floor

Landing

Bedroom One

Double glazed window to front, gas central heating boiler, radiator.

Bedroom Two

Double glazed window to rear, radiator.

Bedroom Three

Double glazed window to front, radiator.

WC

Bathroom

Panelled bath with mixer taps, pedestal wash hand basin, part tiled, double glazed window to rear.



Outside

Front Garden

Crazy paved.

Rear Garden

Mostly laid to lawn, shrub borders.



view this property online barnfields.co.uk/Property/ENF105771





welcome to Manor Road, London

- Three Bedroom House
- 63ft Long South Facing Rear Garden
- Northumberland Park Station 0.2 Miles
- White Hart Lane Station 0.6 Miles
- Potential To Extend STPP

Tenure: Freehold EPC Rating: C
Council Tax Band: C

offers in excess of
£535,000



Please note the marker reflects the postcode not the actual property

Manor Road, London, N17

Approximate Area = 847 sq ft / 78.6 sq m

For identification only - Not to scale

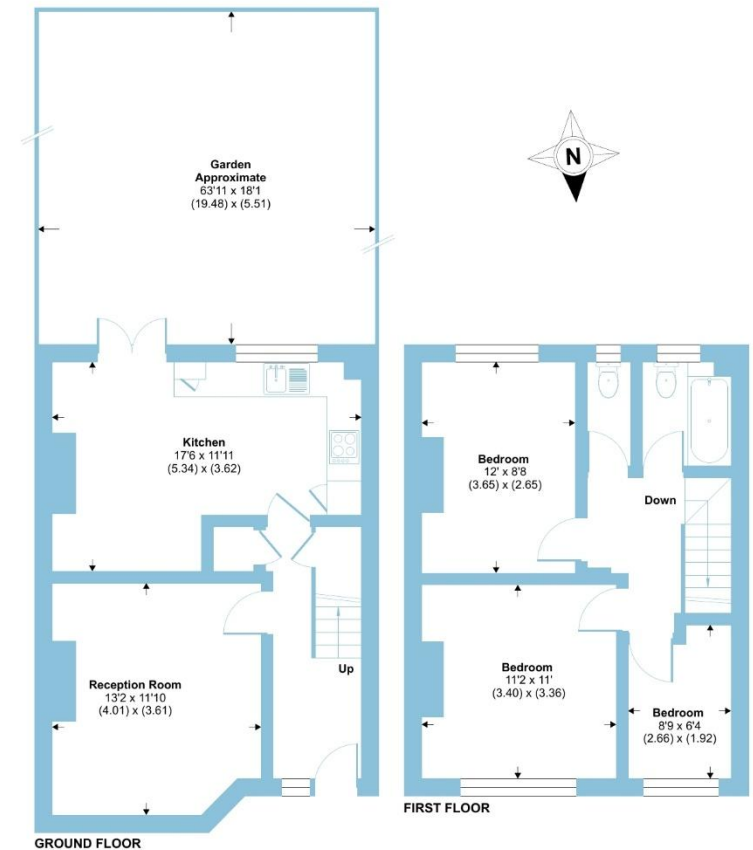

Floor plan produced in accordance with RICS Property Measurement 2nd Edition, Incorporating International Property Measurement Standards (IPMS2 Residential). © nichcom 2025. Produced for Barnard Marcus. REF: 1347175

barnard marcus

check out more properties at [barnfields.co.uk](https://www.barnfields.co.uk)



Property Ref:
ENF105771 - 0003

1. MONEY LAUNDERING REGULATIONS Intending purchasers will be asked to produce identification documentation at a later stage and we would ask for your co-operation in order that there is no delay in agreeing the sale. 2. These particulars do not constitute part or all of an offer or contract. 3. The measurements indicated are supplied for guidance only and as such must be considered incorrect. Potential buyers are advised to recheck measurements before committing to any expense. 4. We have not tested any apparatus, equipment, fixtures or services and it is in the buyers interest to check the working condition of any appliances. 5. Where an EPC, or a Home Report (Scotland only) is held for this property, it is available for inspection at the branch by appointment. If you require a printed version of a Home Report, you will need to pay a reasonable production charge reflecting printing and other costs. 6. We are not able to offer an opinion either written or verbal on the content of these reports and this must be obtained from your legal representative. 7. Whilst we take care in preparing these reports, a buyer should ensure that his/her legal representative confirms as soon as possible all matters relating to title including the extent and boundaries of the property and other important matters before exchange of contracts.

Barnfields is a trading name of Sequence (UK) Limited which is registered in England and Wales under company number 4268443, Registered Office is Cumbria House, 16-20 Hockliffe Street, Leighton Buzzard, Bedfordshire, LU7 1GN. VAT Registration Number is 500 2481 05.

barnfields



020 8363 3394



info@barnfields.com



1a Windmill Hill, Enfield, Middlesex, EN2 6SE



[barnfields.co.uk](https://www.barnfields.co.uk)