

260 Field End Road

Eastcote • Middlesex • HA4 9BF

Offers In Excess Of: £250,000

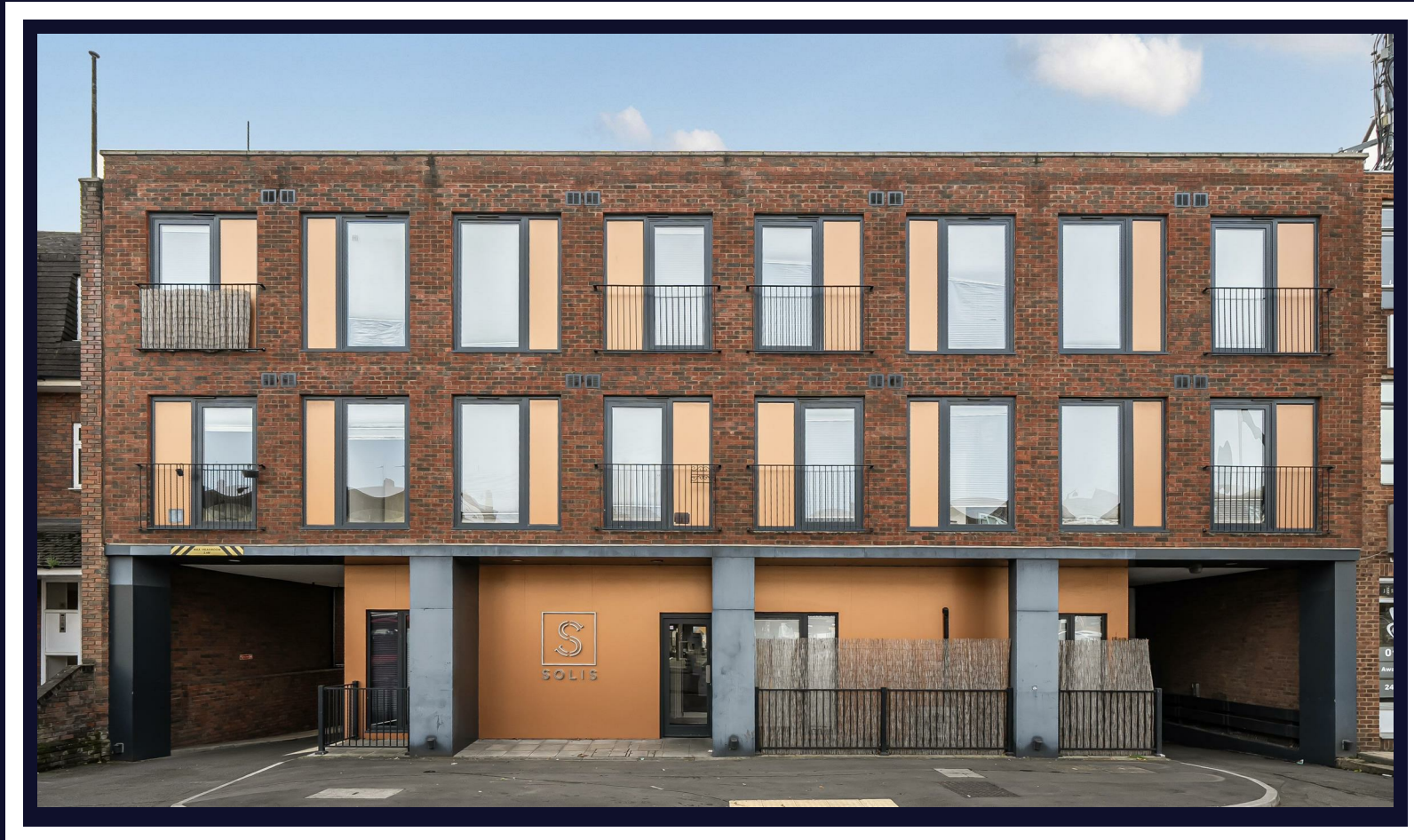

coopers
est 1986

260 Field End Road

Eastcote • Middlesex • HA4 9BF

A modern one-bedroom upper ground floor apartment within the Solis Apartments development, offering approximately 404 sq ft of well-designed living space. The property features an open-plan kitchen, reception and dining area, a spacious double bedroom, and a modern bathroom. Ideally located close to local shops, amenities, and transport links, making it perfect for first-time buyers or investors.

NO CHAIN

ONE BEDROOM APARTMENT

GREAT CONDITION THROUGHOUT

PARKING

IDEAL LOCATION

FITTED KITCHEN

MODERN BATHROOM

LEASEHOLD

WALKING DISTANCE TO STATION

404 SQ.FT

These particulars are intended as a guide and must not be relied upon as statements of fact. Your attention is drawn to the Important Notice on the last page.





Field End Road, Ruislip, HA4

Approximate Area = 404 sq ft / 37.5 sq m

For identification only - Not to scale

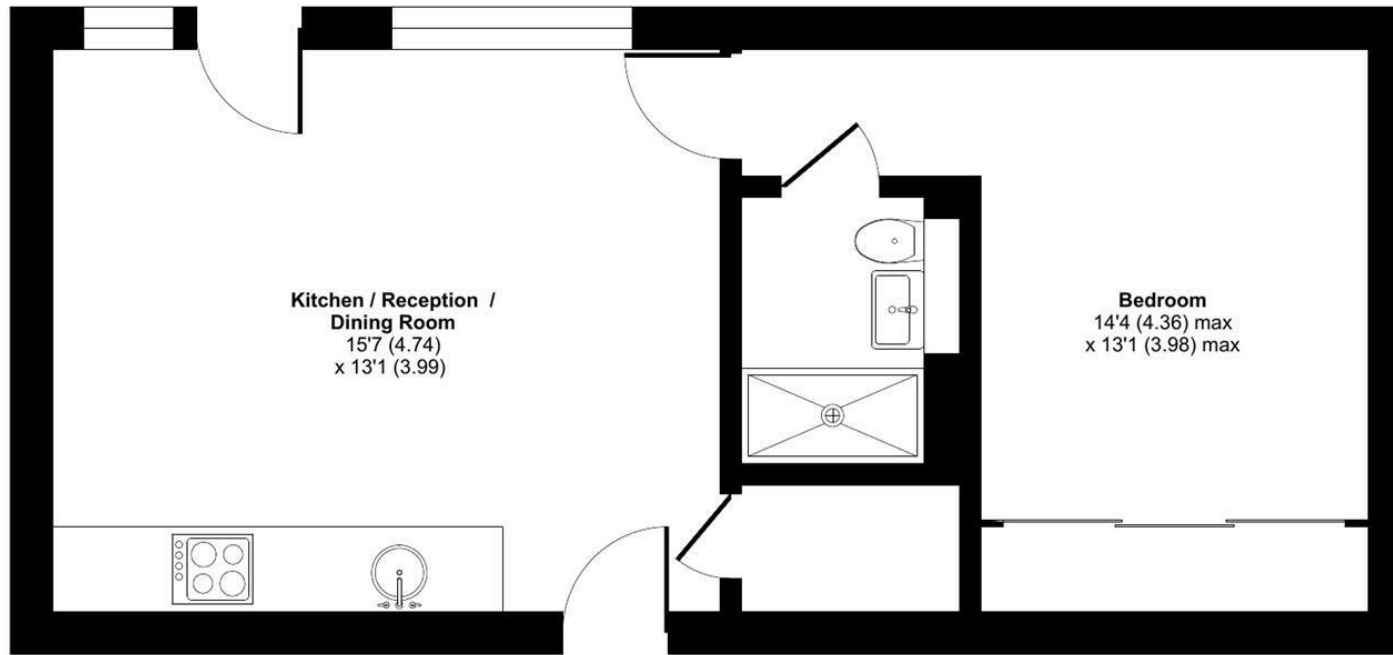

FIRST FLOOR



Floor plan produced in accordance with RICS Property Measurement 2nd Edition, Incorporating International Property Measurement Standards (IPMS2 Residential). © nchecon 2025. Produced for Coopers. REF: 1425831

coopers
est 1986

coopers
est 1986

71 Victoria Road, Ruislip Manor,
Middlesex, HA4 9BH
ruislipmanor@coopersresidential.co.uk

CoopersResidential.co.uk

Energy Efficiency Rating	
Current	Target
Very energy efficient - lower running costs	
A	
B	
C	
D	
E	
F	
G	
Not energy efficient - higher running costs	
England & Wales	
EU Directive 2002/91/EC	

Important Notice: These particulars, whilst believed to be accurate are set out as a general outline only for guidance and do not constitute any part of an offer or contract. Intending purchasers should not rely on them as statements or representation of fact, but must satisfy themselves by inspection or otherwise has the authority to make or give any representation or warranty in respect of the property.