

ALLDAY
& MILLER



Pine Gardens, Ruislip, HA4 9TJ
£575,000

 3  1  1  D



Pine Gardens, Ruislip, HA4 9TJ

£575,000

- Semi Detached
- Chain Free
- Fitted Kitchen
- Garage
- Potential To Extend (STPP)
- Three Bedrooms
- Private Garden
- Family Bathroom
- Excellent Location
- Close to Local Schools & Tube Links

Description

This well-presented family home offers bright and spacious accommodation, ideal for comfortable everyday living.

The ground floor comprises a bright and airy reception room, a separate dining room, and a fitted kitchen which completes this floor.

To the first floor, the property features three well-proportioned bedrooms along with a family bathroom.

Externally, the home benefits from both front and rear gardens, with the rear garden offering an ideal space for outdoor dining and relaxation.

Situation

Located in the highly sought-after Pine Gardens area of Ruislip. This desirable street offers a peaceful suburban setting with excellent connections via Eastcote Tube Station on the Metropolitan and Piccadilly lines, providing direct access to central London. Families benefit from proximity to well-regarded schools, including Lady Bankes Primary School and Newnham Infant and Junior Schools and Ruislip High School. with Ruislip High Street just a short stroll away, offering a variety of shops, cafes, restaurants, pubs, and essential services. For larger retail needs, nearby shopping centres provide convenience, while leisure options such as Ruislip Woods, Ruislip Lido, and historic Manor Farm offer excellent outdoor spaces and community activities.



Floor Plans

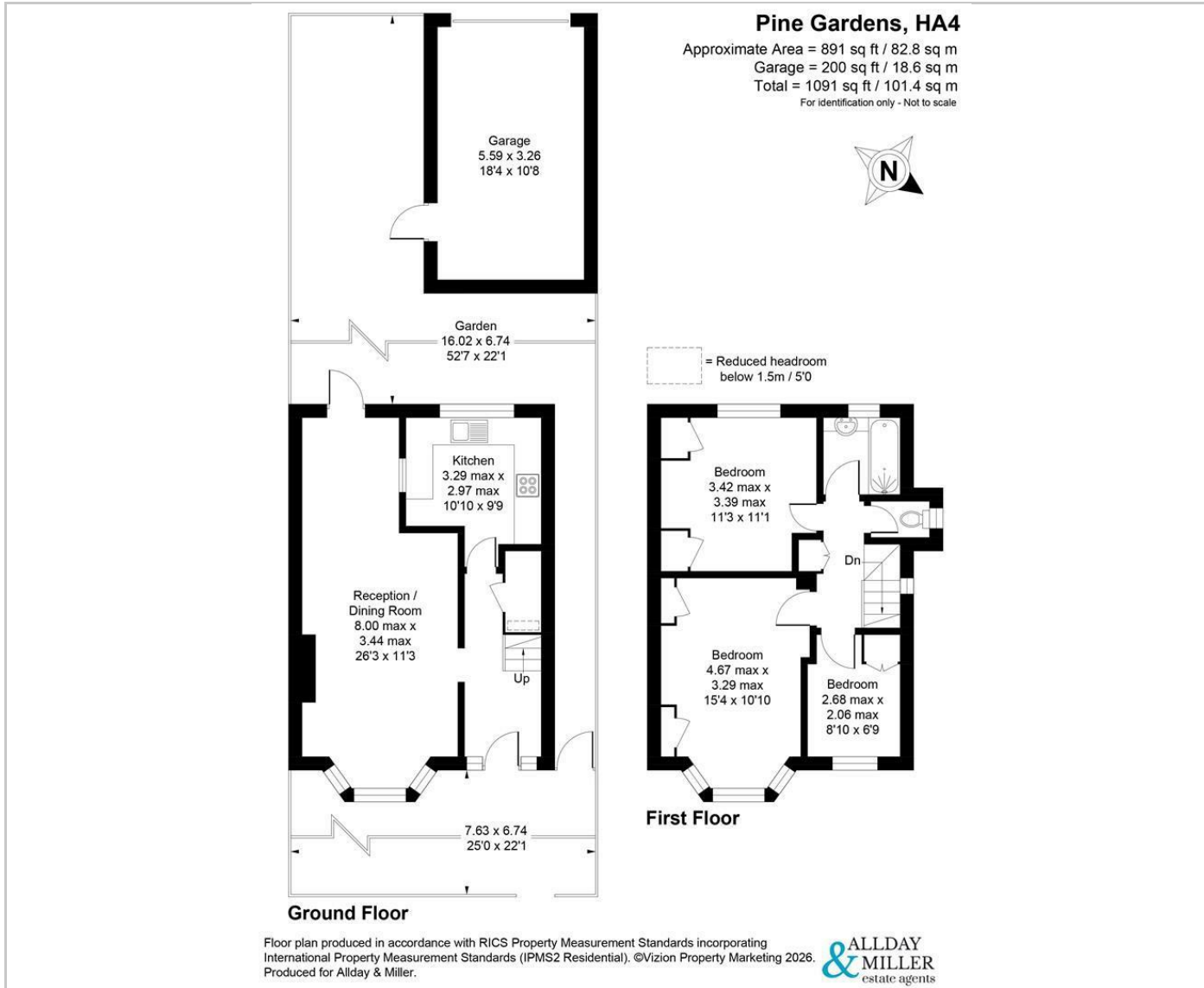

Area Map

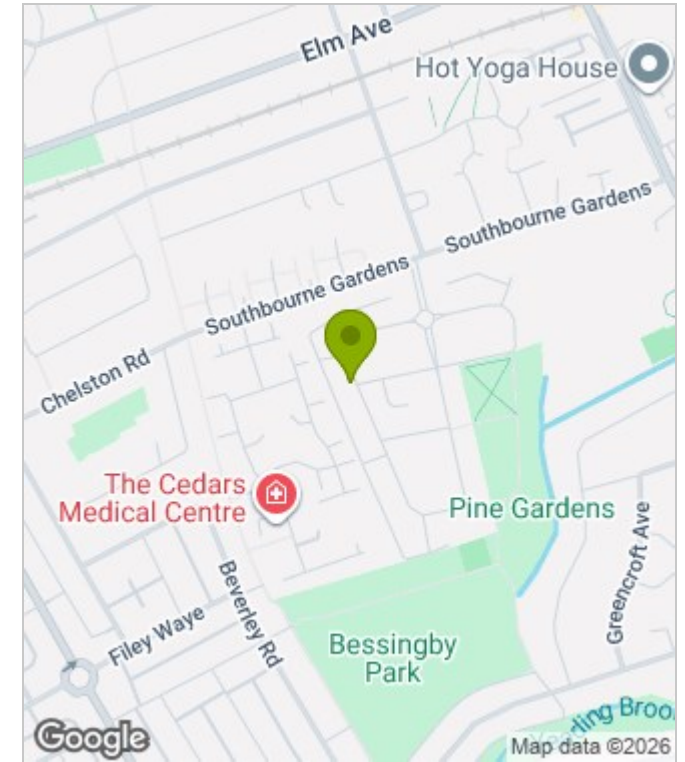

Energy Performance Graph

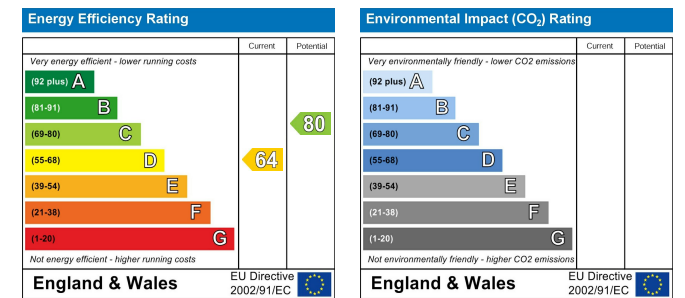

These particulars, whilst believed to be accurate are set out as a general outline only for guidance and do not constitute any part of an offer or contract. Intending purchasers should not rely on them as statements of representation of fact, but must satisfy themselves by inspection or otherwise as to their accuracy. No person in this firm's employment has the authority to make or give any representation or warranty in respect of the property.