



Offers In Excess Of £385,000 | Apartment | Share of Freehold

- Ground floor apartment
- Large lounge
- Bathroom
- Resident/Allocated parking
- Easy access to main line station, shops, bars, restaurants and the River Thames
- Private rear garden
- Separate kitchen
- One double bedroom
- Located in the Heart of Twickenham
- No onward chain

020 8892 1313



Queens Road, TW1 4ES

Milestone and Collis are pleased to offer this apartment nestled in the heart of Twickenham on Queens Road, this charming one bedroom ground floor flat offers a delightful blend of comfort and convenience. With a spacious reception room and a well appointed bathroom, this property is perfect for those seeking a cosy yet functional living space.

One of the standout features of this apartment is its private garden, providing a serene outdoor retreat for relaxation or entertaining guests. The flat is ideally situated just a short stroll from the picturesque Twickenham town centre, where you can enjoy a vibrant atmosphere filled with an array of shops, bars, and restaurants. The proximity to the River Thames and main line station makes it a commuter's dream, offering excellent transport links into London.

This property is not only an ideal home for downsizers or first-time buyers but also presents a fantastic opportunity for young families looking to settle in a lively community. Additionally, its prime location and appealing features make it a shrewd investment choice for those looking to enter the property market.

With a share of freehold and an impressive lease of over 900 years, this flat promises both security and peace of mind. Whether you are looking to make it your own or seeking a lucrative investment, this property is a must-see. Embrace the opportunity to live in a vibrant area with everything you need right at your fingertips.



Directions from, Milestone and Collis Sales 86 Heath Rd, Twickenham TW1 4BW Turn Left on Heath Rd Turn left onto Holly Rd, 75 ft Turn right to stay on Holly Rd, 0.1 mi Turn left onto Queen's Rd ?, 0.2 mi TW1 4ES Queen's Rd, Twickenham



TW1 4ES lies on Queens Road in Twickenham. TW1 4ES is located in the Twickenham Riverside electoral ward, within the London borough of Richmond upon Thames and the English Parliamentary constituency of Twickenham. The Sub Integrated Care Board (ICB) Location is NHS South West London ICB - 36L and the police force is Metropolitan Police.

Nearest Schools

- St Richard Reynolds Catholic High School, State School, 0.1 miles
- Strathmore School, State School, 0.2 miles
- St Richard Reynolds Catholic Primary School, State School, 0.2 miles
- St Mary's Church of England Primary School, State School, 0.2 miles

NEAREST STATIONS

- Twickenham Station, 0.2 miles
- St. Margarets Station, 0.7 miles
- Strawberry Hill Station, 0.7 miles

Council tax band D

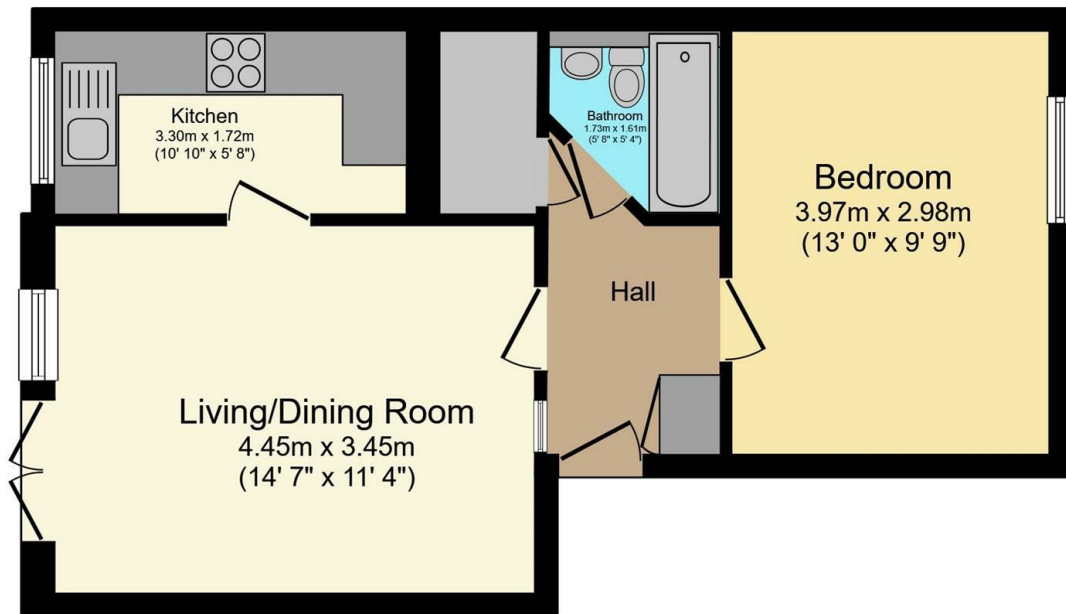
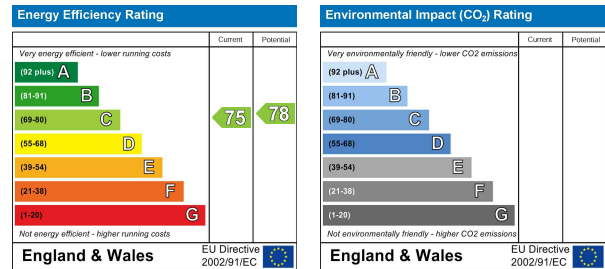

Total floor area 42.8 sq.m. (461 sq.ft.) approx

This floor plan is for illustrative purposes only. It is not drawn to scale. Any measurements, floor areas (including any total floor area), openings and orientation are approximate. No details are guaranteed, they cannot be relied upon for any purpose and they do not form part of any agreement. No liability is taken for any error, omission or misstatement. A party must rely upon its own inspection(s). Powered by www.focalagent.com

It is our aim to provide particulars that are both accurate and reliable but they are not guaranteed and would not form part of any offer or contract. Please contact us if you require clarification and we would be happy to assist. Please also note that the appliances and heating system have not been tested and therefore, no warranties can be given as to their condition.