



128 Temple Road, Bolton

Offers Over £145,000

**Miller Metcalfe**  
*Every step of the way*

# 128 Temple Road

Bolton, Bolton

**BEAUTIFUL TOP FLOOR OPEN PLAN APARTMENT WITH TWO BATHROOMS** Available immediately with no onward chain stands this well appointed and nicely presented two bedroom apartment! Situated on the top floor offering complete privacy and security, the apartment flows internally with modern and crisp decor that is ready to be enjoyed immediately! Significantly larger than most other apartments, take advantage of a fantastic open plan kitchen/living area, two generous double bedrooms and two bathrooms with the master benefitting from en-suite. We think the apartment could appeal to a number of different people such as a first time buyer, a young couple or perhaps someone looking to downsize. It could also make a great buy to let investment for someone looking to enhance their portfolio and has been a strong rental property previously. Temple Road is a quiet and well regarded location situated just off Most Bank Way in Bolton. A number of amenities are close by such as shops, schools, supermarkets and leisure facilities. In accordance with our regulatory obligations, we are required to carry out Anti-Money Laundering (AML) checks on all relevant individuals. A fee of £25 per person will be charged to cover the cost of conducting these checks. This fee is non-refundable.

Council Tax band: B

Tenure: Leasehold

EPC Energy Efficiency Rating: B

EPC Environmental Impact Rating: B









GROUND FLOOR  
888 sq.ft. (82.5 sq.m.) approx.

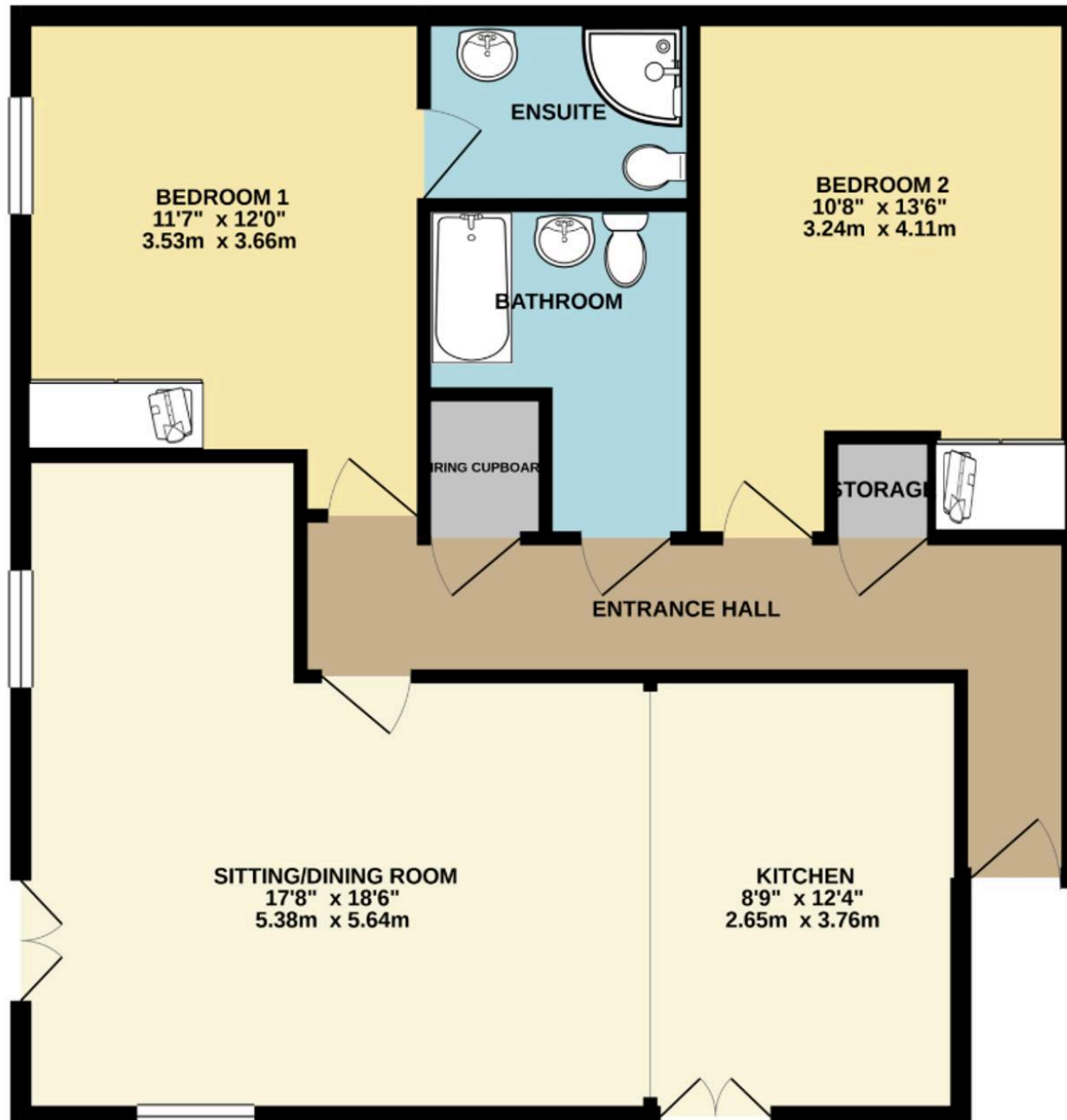



## Bolton

Miller Metcalfe, 2-10 Bradshawgate - BL1 1DG

01204 535353 • [bolton@millermetcalfe.co.uk](mailto:bolton@millermetcalfe.co.uk) • [millermetcalfe.co.uk/](http://millermetcalfe.co.uk/)

**Miller Metcalfe**  
*Every step of the way*