



19 Fulmar Drive, Hythe, SO45 3GL  
£345,000



ANTHONY JAMES  
PROPERTIES



# 19 Fulmar Drive

Hythe, Southampton

A charming 3-bedroom detached bungalow with an airy open-plan lounge/kitchen, three bedrooms, and a family bathroom. This delightful property boasts a full-width conservatory that overlooks the sunny and private rear garden, perfect for relaxation and entertaining. The extensive driveway to the front provides ample parking space, complemented by UPVC double glazing and gas central heating for modern comfort.

Council Tax band: C

Tenure: Freehold

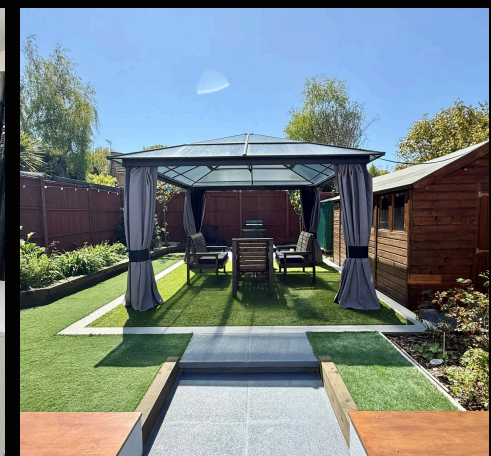

1 Southward House  
Dibden Purllieu SO45 4PT



T: 02380 844405

[info@anthonyjamesproperties.co.uk](mailto:info@anthonyjamesproperties.co.uk)



GROUND FLOOR

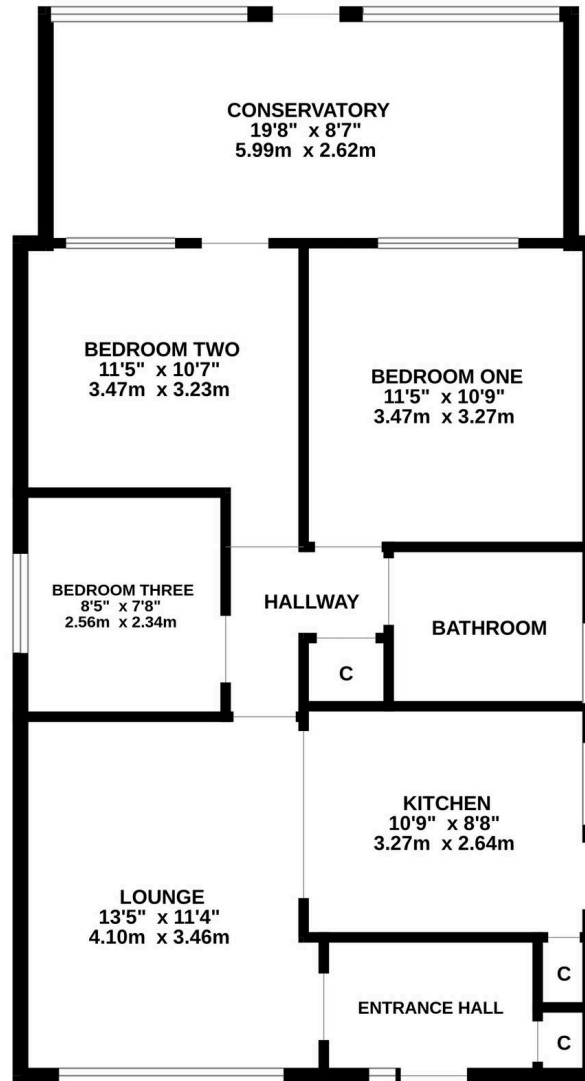

Whilst every attempt has been made to ensure the accuracy of the floorplan contained here, measurements of doors, windows, rooms and any other items are approximate and no responsibility is taken for any error, omission or mis-statement. This plan is for illustrative purposes only and should be used as such by any prospective purchaser. The services, systems and appliances shown have not been tested and no guarantee as to their operability or efficiency can be given.  
Made with Metropix ©2025