



25 Lacey Street

Longhoughton



25 Lacey Street, Longhoughton, Alnwick, Northumberland, NE66 3AH

An excellent three bedroom, semi detached house in a lovely position on Lacey Street, with a large east facing rear garden with open aspect views over the playing fields towards the coast - the ex RAF quarters, requiring some cosmetic updating, benefits from a wider plot with a block paved driveway for 2-3 cars, leading to a detached double garage, with a Garden room/conservatory to the rear along with a useful garden store and 14 Solar Panels to the roof.

The semi detached house, lived in by the current family for over 30 years, is ideally placed for lovely walks to the beach and Sugar Sands, and to the nearby village amenities including First School, Co-op supermarket, 'Running Fox' and village cafe, historic Church and village hall. The 'Fishing Boat Inn' in nearby Boulmer is located overlooking the sea and coast.

Ground floor - Entrance hallway with stairs to the first floor, under stairs storage cupboard and small cloaks cupboard | Sitting room with two windows to the front | Open plan L shaped kitchen /dining room with a door opening to the garden and decorative beams to the ceiling | Kitchen fitted with a range of cabinets with integrated hob, oven, microwave and plumbing for a washing machine and tumble drier.





First floor - First floor landing with loft access | Double bedroom one with views over the garden to the coast, and an electric shower | Double bedroom two | Double bedroom three | Bathroom with a bath with electric shower over, WC and wash hand basin.

Externally - Detached double garage with an up and over door, power and lighting | Impressive & versatile Garden room and garden store located to the rear of the garage | Block paved driveway for 2-3 cars | Lawned front and rear garden with views over the fields to the rear, mature trees and shrubs to the boundary | 14 Solar panels producing energy and income from the feed in tariff to the National Grid.

Approximate distances: Boulmer & sea 1.8 miles - Alnwick 4.5 miles - Alnmouth Railway Station 3 miles - Morpeth 23 miles - Newcastle upon Tyne - 37 miles

Services: Mains Electric, Gas, Water & Drainage | Gas Central Heating | Solar Panels | Tenure: Freehold | Council Tax: Band A | EPC: C

Guide Price £275,000



Ground Floor
98.2 sq.m. (1057 sq.ft.) approx.

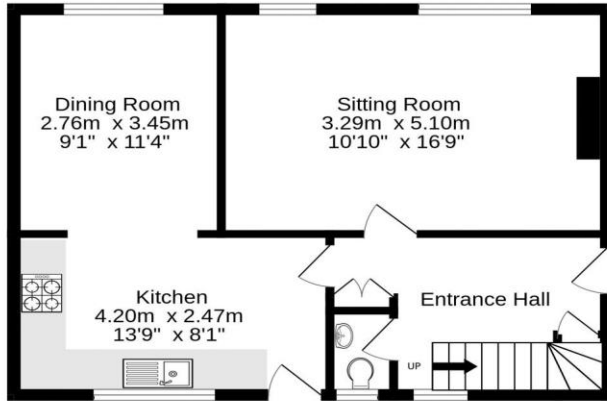

1st Floor
46.4 sq.m. (500 sq.ft.) approx.

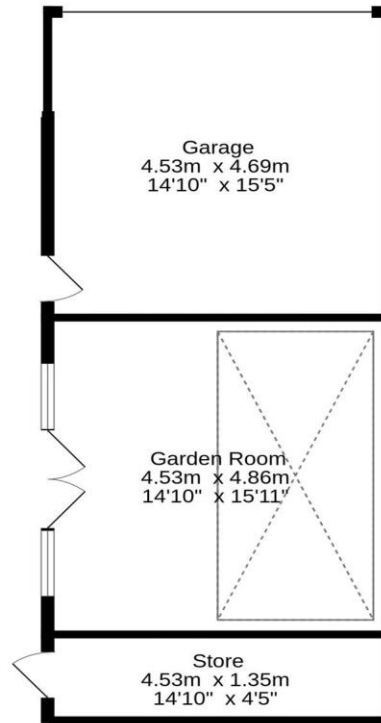
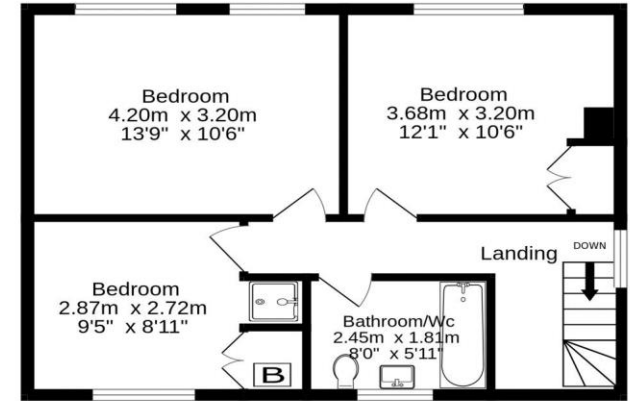

TOTAL FLOOR AREA : 144.7 sq.m. (1557 sq.ft.) approx.

Whilst every attempt has been made to ensure the accuracy of the floorplan contained here, measurements of doors, windows, rooms and any other items are approximate and no responsibility is taken for any error, omission or mis-statement. This plan is for illustrative purposes only and should be used as such by any prospective purchaser. The services, systems and appliances shown have not been tested and no guarantee as to their operability or efficiency can be given.
Made with Metropix ©2026



SANDERSON
YOUNG

Alnwick Office
35 Bondgate Without | Alnwick
Northumberland | NE66 1PR
alnwick@sandersonyoung.co.uk
01665 600 170