



Chadwell Street, EC1R

£950,000

A two-bedroom period conversion set over the top floors of a Grade II listed Georgian house, positioned just off the highly sought-after Myddelton Square. The home features a large reception, separate kitchen, family bathroom and two double bedrooms. The property is sold with a share of freehold access to a leafy garden at the rear.

Chadwell Street offers a peaceful setting with Angel station within easy walking distance, excellent transport links, 300 metres from one of London's top state primary schools and close proximity to Upper Street, Exmouth Market, Clerkenwell, and the green spaces of Myddelton Square Gardens.

Features

- Two Double Bedrooms
- Separate Kitchen
- Share of Freehold
- Garden
- Top Floor
- Period Conversion

Chadwell Street, London, EC1R

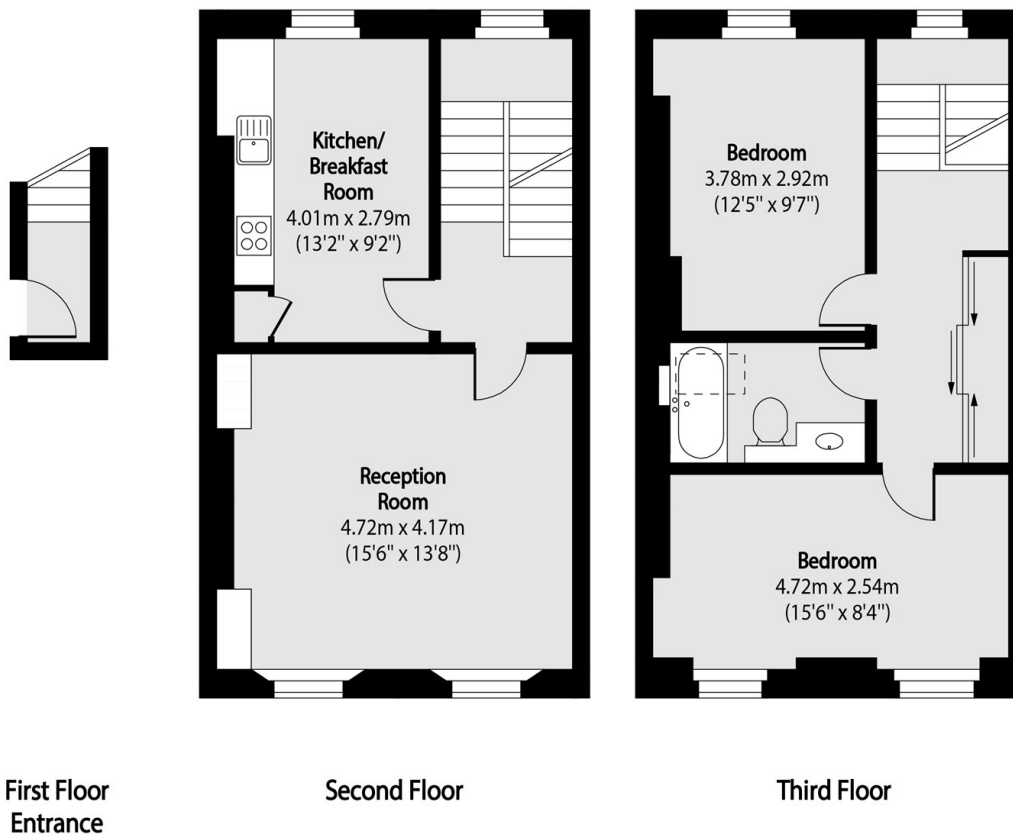

Total area (approx): 81.01 sq m (872 sq. ft)