



**6 Potts Court**  
**Crowle, Scunthorpe DN17 4DP**  
**£75,000**

*Bella*  
properties

**\*\* NO ONWARD CHAIN \*\***

**Bella Properties offers for sale this one bedroom ground floor flat on Potts Court, Potts Lane, located in the always sought after Crowle. This property is perfect for investment or sole occupant, with lots of potential, and comes with the added benefit of no onward chain. Found close to many of Crowle's local amenities as well as motorway links to further afield, this property is in a prime position.**

**The property consists of the entrance hall, two storage cupboards, living room, kitchen, bedroom and bathroom on the ground floor. Externally, to the rear of the property is a gravelled back yard.**

**Viewings are available immediately.**



**Hall** 3'4" x 16'11" (1.02 x 5.16)

Entrance to the property is into the hall. Internal doors lead to the living room, kitchen, bedroom, bathroom and two storage cupboards.

**Living Room** 12'4" x 13'1" (3.76 x 4.01)

Carpeted with storage heater, electric fireplace and uPVC window faces to the front of the property.

**Kitchen** 10'6" x 6'9" (3.22 x 2.07)

Vinyl effect flooring with uPVC window and door to the rear of the property. Base height and wall mounted wooden units with countertops, splashbacks, integrated sink and drainer and space and plumbing for white goods.

**Bedroom One** 13'8" x 8'1" (4.17 x 2.47)

Carpeted with storage heater and uPVC window faces to the rear of the property.

**Bathroom** 7'11" x 4'5" (2.42 x 1.37)

Carpeted with uPVC window facing to the rear of the property. A three piece suite consisting of bathtub, sink and toilet.

**External**

To the rear of the property is a gravelled back yard.

**Disclaimer**

The information displayed about this property comprises a property advertisement and is an illustration meant for use as a guide only. Bella Properties makes no warranty as to the accuracy or completeness of the information.





## Floor Plan

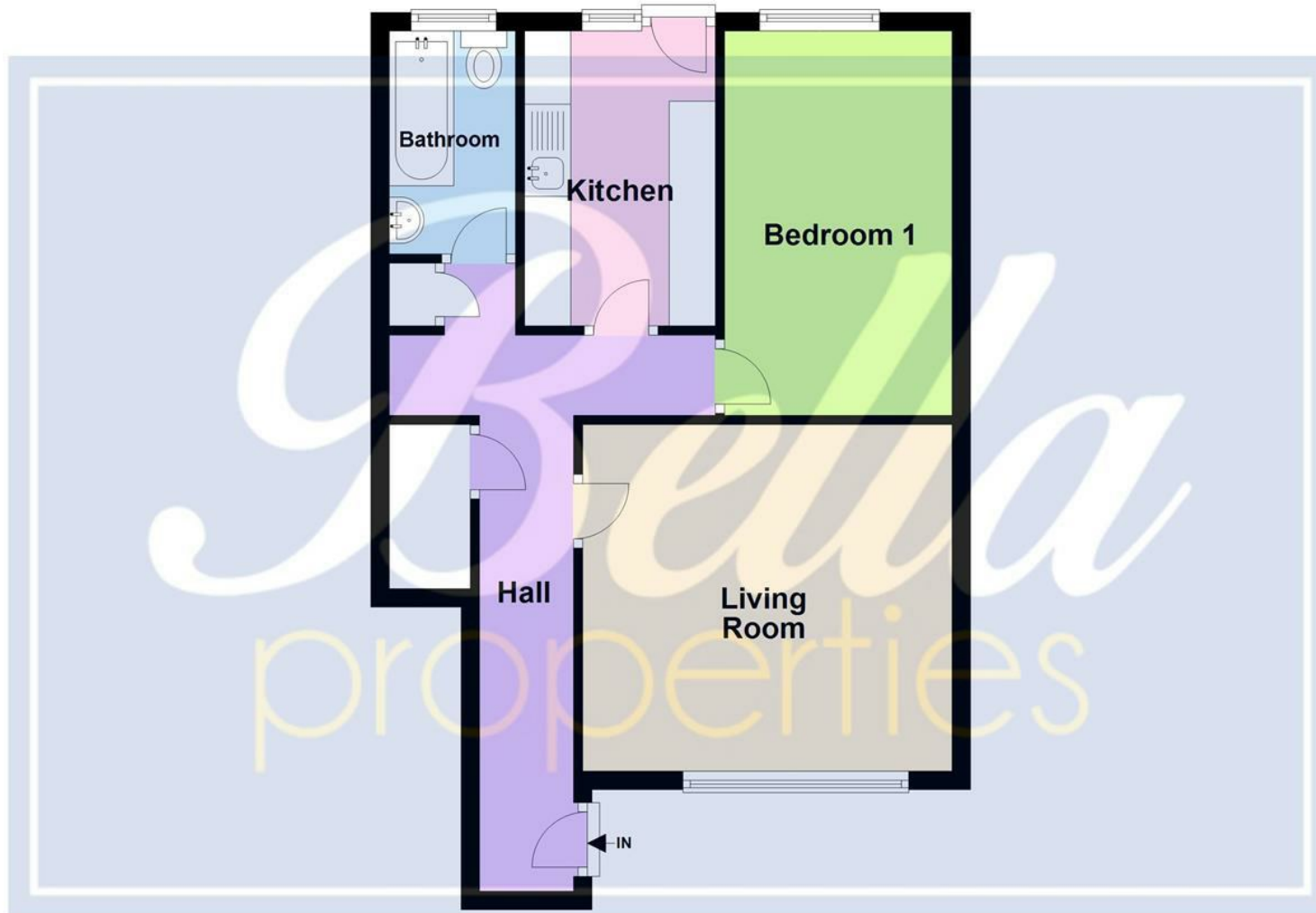

Total area: approx. 48.5 sq. metres (522.0 sq. feet)

Floor plan measurements are approximate and are for illustrative purposes only. While we do not doubt the floor plans accuracy, we make no guarantee, warranty or representation as to the accuracy and completeness of the floor plan. You or your advisors should conduct a careful, independent investigation of the property to determine your satisfaction as to the suitability of the property for your space requirements.

Plan produced using PlanUp.

Energy Efficiency Rating		
	Current	Potential
Very energy efficient - lower running costs		
(92 plus) A		
(81-91) B		
(69-80) C		
(55-68) D		
(39-54) E		
(21-38) F		
(1-20) G		
Not energy efficient - higher running costs		
<b>England &amp; Wales</b> EU Directive 2002/91/EC		
Environmental Impact (CO <sub>2</sub> ) Rating		
	Current	Potential
Very environmentally friendly - lower CO <sub>2</sub> emissions		
(92 plus) A		
(81-91) B		
(69-80) C		
(55-68) D		
(39-54) E		
(21-38) F		
(1-20) G		
Not environmentally friendly - higher CO <sub>2</sub> emissions		
<b>England &amp; Wales</b> EU Directive 2002/91/EC		