

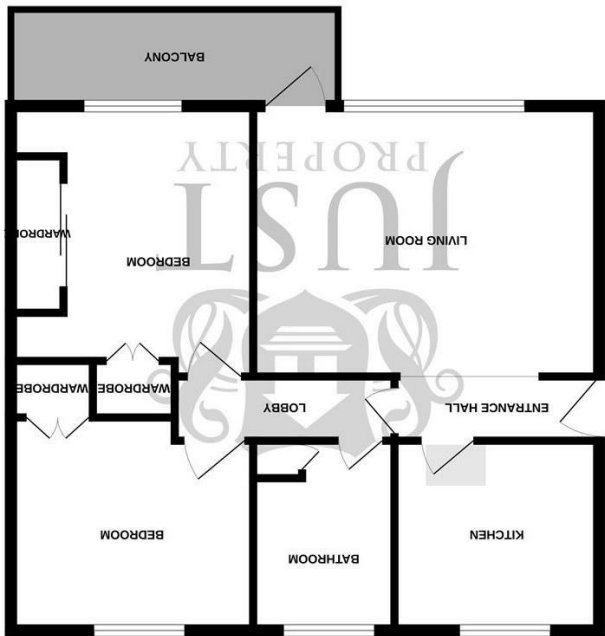





While every attempt has been made to ensure the accuracy of the English described here, measurements are not guaranteed. The plan is to be used as a guide only and should not be used as a guarantee of dimensions or fixtures. The plan is to be used as a guide only and should not be used as a guarantee of dimensions or fixtures. The plan is to be used as a guide only and should not be used as a guarantee of dimensions or fixtures.



GROUND FLOOR

Energy Efficiency Rating					
England & Wales					
EU Directive 2002/91/EC					
					
			Very energy efficient - lower running costs		
			A (92 plus)		
			B (81-91)		
			C (69-80)		
			D (55-68)		
			E (39-54)		
			F (21-38)		
			G (1-20)		
			Not energy efficient - higher running costs		
			Current	Potential	



9 Ewell Court Sutton Place, Bexhill-On-Sea, TN40 1PA

FLOORPLANS

www.justproperty.net



9 Ewell Court Sutton Place, Bexhill-On-Sea, TN40 1PA

Leasehold - Share of Freehold

£200,000





Leasehold - Share of Freehold

£200,000



ROOM DIMENSIONS

Communal Entrance

Communal Hallway

Private Entrance

Hallway

Sitting/Dining Room
14'9" x 15'1" (4.5 x 4.6)

Kitchen
10'9" x 7'6" (3.3 x 2.3)

Bedroom
10'9" x 9'10" (3.3 x 3)

Bedroom
12'9" x 11'1" (3.9 x 3.4)

Bathroom
7'6" x 6'10" (2.3 x 2.1)

Balcony

Garage

16'0" x 8'2" (4.9 x 2.5)

Communal Gardens

FEATURES

- Second Floor Seafront Apartment
- Stunning Sea Views
- Two Bedrooms
- Spacious Balcony
- Share Of Freehold
- Refurbishment Potential
- Popular Residential Block
- Garage & Communal Gardens
- Council Tax Band B
- ****NO ONWARD CHAIN****



Please note that we have not tested the services or any of the equipment or appliances in this property, accordingly we strongly advise prospective buyers to commission their own survey or service reports before finalising their offer to purchase. While we endeavour to make our sales particulars fair, accurate and reliable, they are only a general guide to the property and accordingly if there are any point which is of particular importance to you, please contact the office and we will be pleased to check the position for you, especially if you are contemplating travelling some distance to view the property.