

## Botanic Square, E14

£290,000

Studio apartment set on the 7th floor of Grantham House in the sought after London City Island development. The property has an open plan reception and dining area, modern integrated kitchen and sleeping area with built-in wardrobes.

London City Island is a modern development within walking distance of the shops, bars and restaurants of Canning Town and Canary Wharf.

### Features

- Built-in Wardrobes
- 423 Sq.Ft
- Seventh Floor
- Studio Apartment
- Concierge
- Residents Facilities

# Botanic Square, London, E14

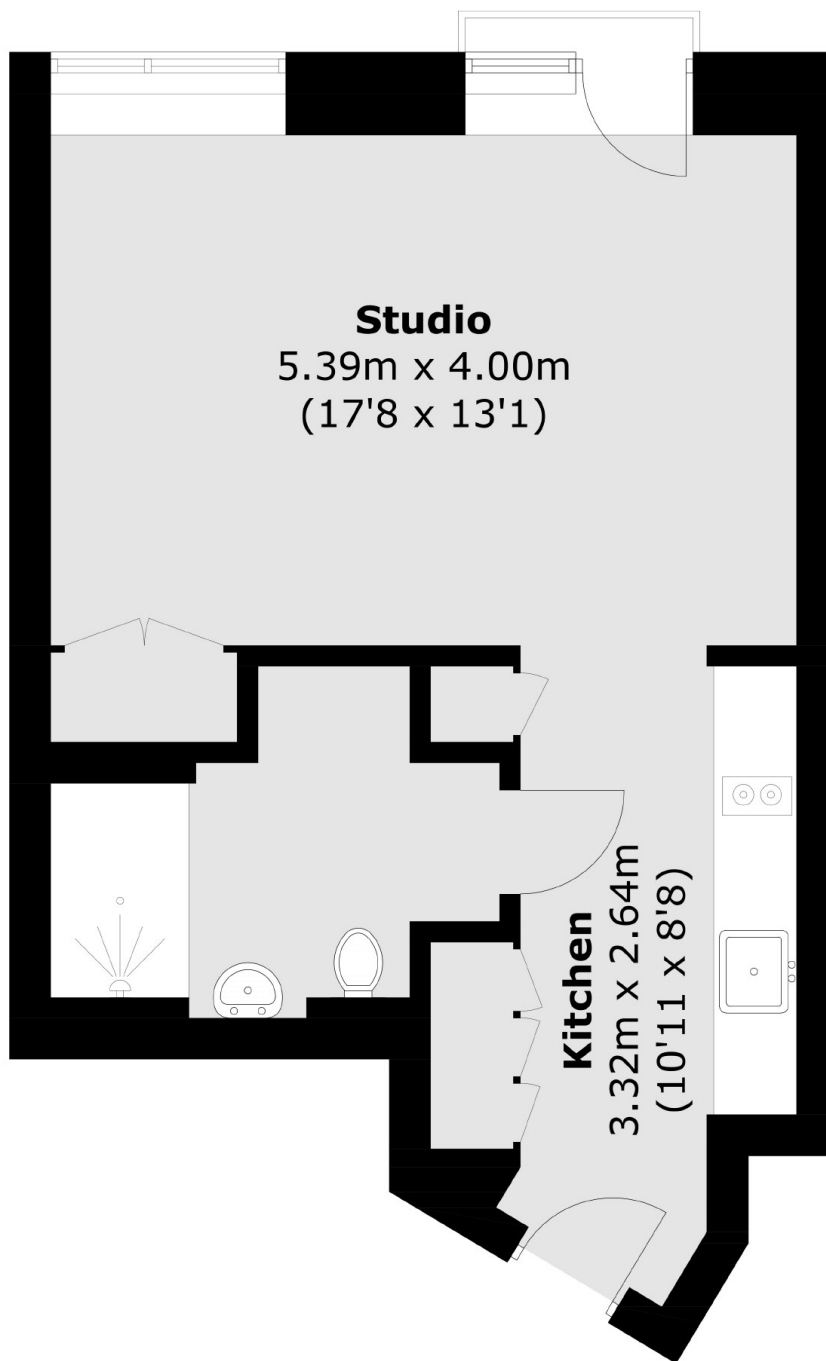

Total area (approx.): 39.3 sq. m (423.0 sq. ft)