



CLIVEPEARCE
Now you're moving

3 Bedrooms

House - Townhouse

Asking Price

£285,000

Located in

Redruth



www.clivepearceproperty.com



Park An Trinity

Redruth | | TR16 5LZ



A modern three bedroom three storey townhouse presented in immaculate condition throughout benefitting from two bathrooms, private parking and in a quiet semi-rural location.

Park An Trinity

£285,000 Freehold



- Quiet cul de sac
- Immaculate presentation
- Three good size bedrooms
- Low maintenance garden
- Private allocated parking
- Modern three storey home
- Upgraded high quality kitchen
- Bathroom and master ensuite
- Highly energy efficient
- Underfloor heating

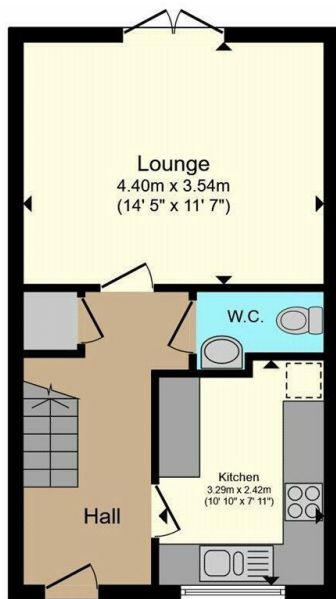

Ground Floor

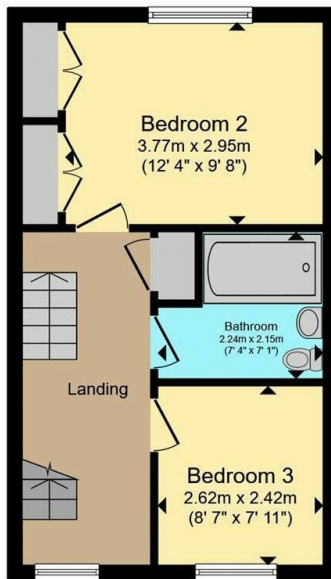

First Floor

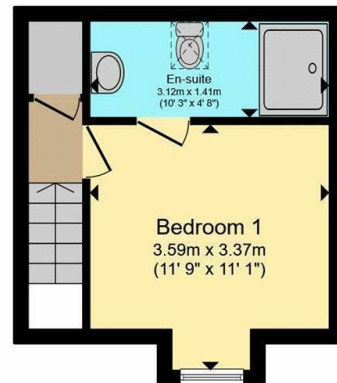

Second Floor

Total floor area 90.3 sq.m. (972 sq.ft.) approx

This floorplan is for illustrative purposes only and is not drawn to scale. Measurements, floor-areas, openings and orientations are approximate. They should not be relied upon for any purpose and do not form any part of an agreement. No liability is taken for any error or mis-statement. All parties must rely on their own inspections.

Council Tax Band B

Local Authority

Agents Note: Whilst every care has been taken to prepare these particulars, they are for guidance purposes only. All measurements are approximate and are for general guidance purposes only and whilst every care has been taken to ensure their accuracy, they should not be relied upon and potential buyers/tenants are advised to recheck the measurements.

Energy Efficiency Rating		Current	Potential
Very energy efficient - lower running costs			
(92 plus) A			94
(81-91) B		81	
(69-80) C			
(55-68) D			
(39-54) E			
(21-38) F			
(1-20) G			
Not energy efficient - higher running costs			
England & Wales		EU Directive 2002/91/EC	

31 Lemon Street
Truro
Cornwall
TR1 2LS



CLIVEPEARCE
Now you're moving

hello@clivepearceproperty.com

01872 272622

www.clivepearceproperty.com