



Northcote Road, TW1

£1,000,000

Tucked away in a peaceful cul-de-sac within the highly sought after St Margarets area, this charming three bedroom Victorian home presents an excellent opportunity to own a characterful property with exciting scope for future enhancement.

Northcote Road is a popular residential road only 0.4 miles from the River Thames and its tow path walks into Richmond. St Margarets main line station and shops are only 0.6 miles away. Old Deer Park is close by.

Features

- Victorian House
- Three Bedrooms
- Period Features
- Potential To Extend (STPP)
- Quiet Residential Location
- South-Facing Garden



Northcote Road, TW1

The ground floor offers a bright through reception room with a large bay window, while the spacious kitchen dining room overlooks the south-facing garden and provides potential to extend into the side return, subject to the usual consents. Upstairs are two generous double bedrooms, a spacious family bathroom and a separate utility room.

The property also offers further potential to convert the loft, subject to the usual consents, making it an excellent opportunity to enhance and adapt the home over time.



Northcote Road, Twickenham, TW1

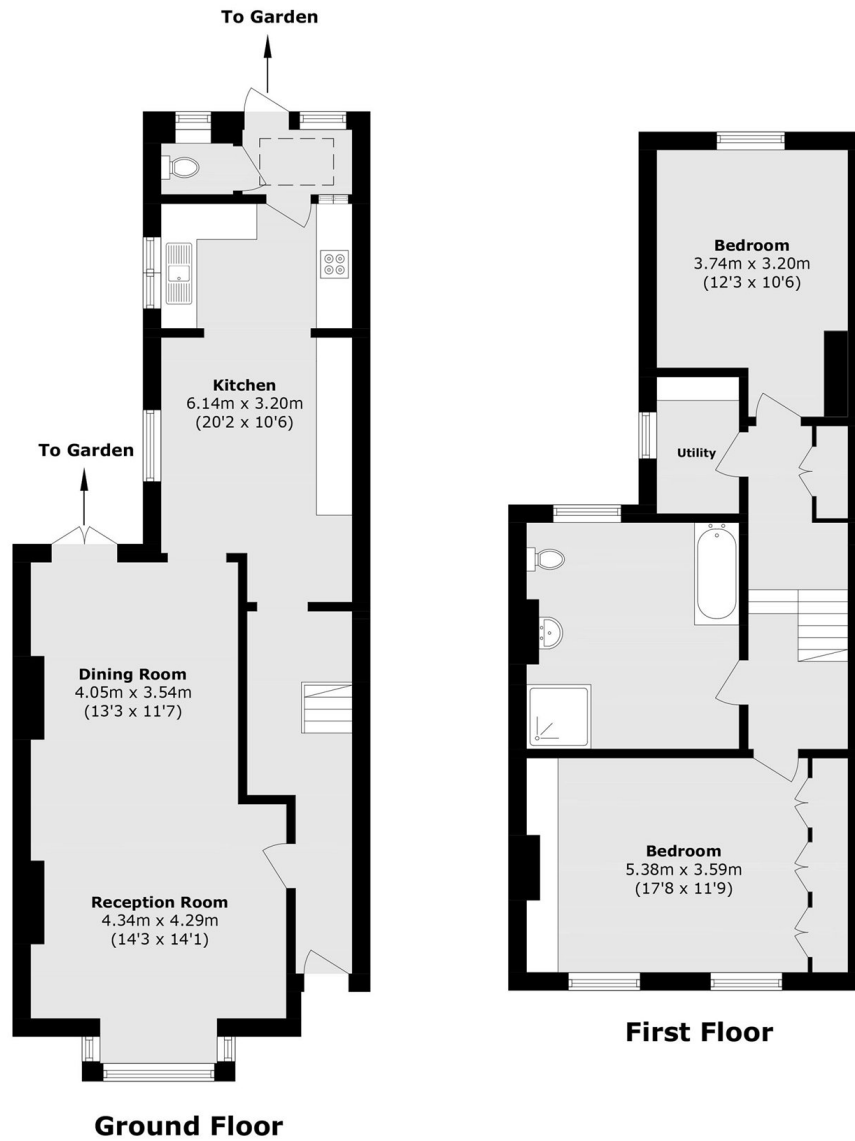

Total area (approx.): 125.3 sq. m (1348.7 sq. ft)