

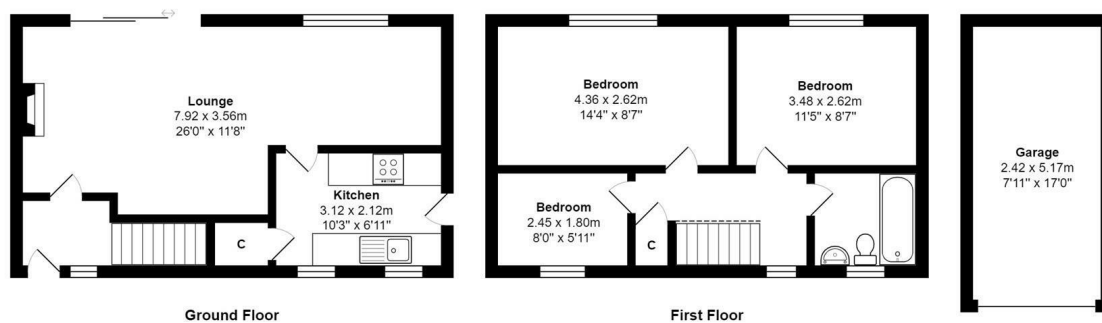

3 Piece Fields, Threshfield, Skipton, BD23 5HR

Asking Price £375,000

- THREE BED SEMI DETACHED
- GARDENS TO FRONT AND REAR
- CHAIN FREE
- VIEWING A MUST
- PRIVATE DRIVEWAY
- LARGE SHED
- SOUGHT AFTER AREA
- SINGLE GARAGE
- RECENTLY RENOVATED
- CLOSE TO AMENITIES



Total Area: 84.1 m² ... 905 ft²
 All measurements are approximate and for display purposes only

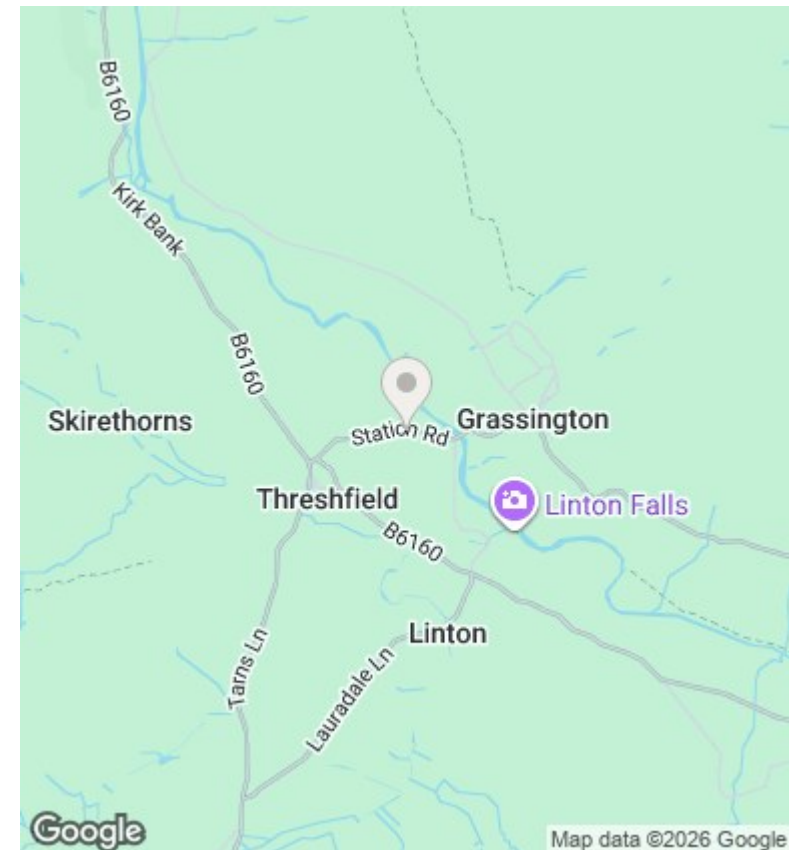

Directions

Viewings

Viewings by arrangement only. Call 01756 753341 to make an appointment.

Council Tax Band

D

EPC Rating:

D

Energy Efficiency Rating		Current	Potential
<i>Very energy efficient - lower running costs</i>			
(92 plus)	A		
(81-91)	B		82
(69-80)	C		
(55-68)	D	67	
(39-54)	E		
(21-38)	F		
(1-20)	G		
<i>Not energy efficient - higher running costs</i>			
England & Wales		EU Directive 2002/91/EC	