

10 Cadet Drive, Shirley, Solihull, B90 2FD

£200,000

 2  1  1



3 Union Road, Shirley, Solihull B90 3BT

sales • new homes • land • commercial • mortgages • auction

Registered Company in England and Wales. Company No 03591917
 Registered Office: smart New Homes Ltd, 3 Union Road, Shirley, Solihull B90 3BT

- Ground floor 2 bedroom apartment
- Private patio accessed from the lounge
- Secure phone intercom system
- Ample storage space, with a storage cupboard in the hallway
- 116 Years left on the lease
- Prime Shirley location close to shops, restaurants and amenities
- Allocated parking space
- Spacious open plan kitchen, lounge, dining area
- No above chain!!
- Get in touch today to arrange a viewing!

10 Stearman Court, Cadet Drive

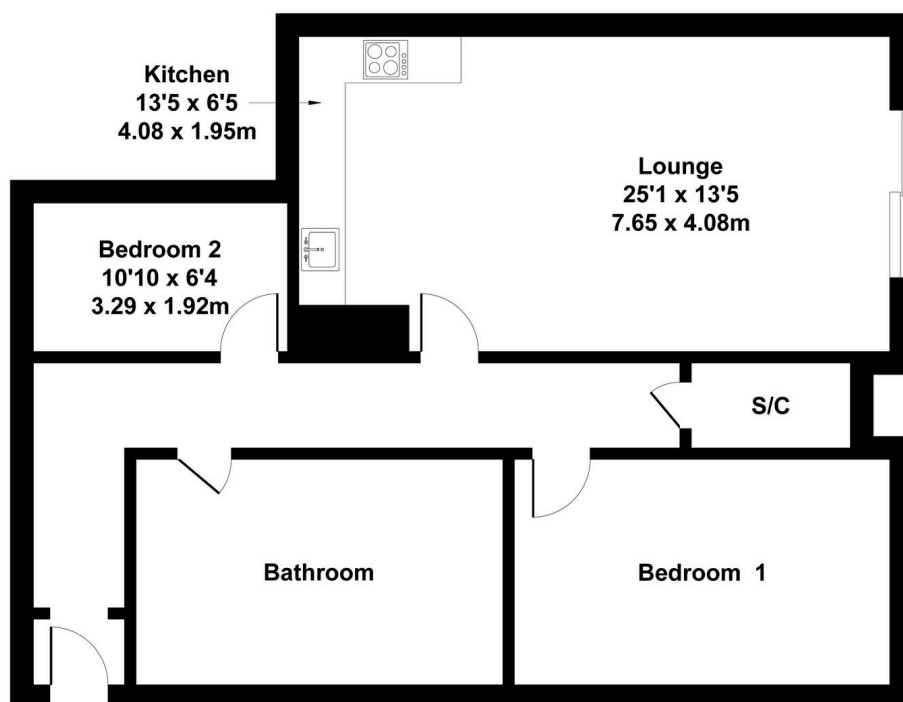

Not to Scale. Produced by The Plan Portal 2025
For Illustrative Purposes Only.

A well-presented ground floor, 2 bedroom apartment in the heart of Shirley, Solihull, just a short walk to shops, restaurants and great local amenities. Featuring a bright lounge with doors opening to a private patio, modern kitchen, two good-sized bedrooms and a well-appointed bathroom. The property also benefits from an allocated parking space and a secure phone intercom system. Ideal for first-time buyers, downsizers or investors. Call us today to arrange a viewing!

3 Union Road, Shirley, Solihull B90 3BT

sales • new homes • land • commercial • mortgages • auction