

Frank Harris & Co.



Battlebridge Court, N1

£577 Per week

A beautifully presented one-bedroom garden flat featuring a spacious open-plan kitchen, dining and living area. The property boasts a sleek, high-specification bathroom and a generously sized double bedroom with ample built-in storage. Highlights include elegant wooden flooring, a large private garden, and a charming outdoor patio with a dedicated BBQ area, perfect for entertaining or relaxing.



King's Cross and St Pancras stations are approximately 0.3 miles from the property. Coal Drops Yard, is a shopping centre consisting of 100,000 sq ft of shops, cafés, bars and restaurants and is approximately 0.5 miles from the property.

- One Bedroom • Private garden • Secure Building •
- Open Plan • Wooden Flooring • Modern Spec •



Frank Harris & Co.

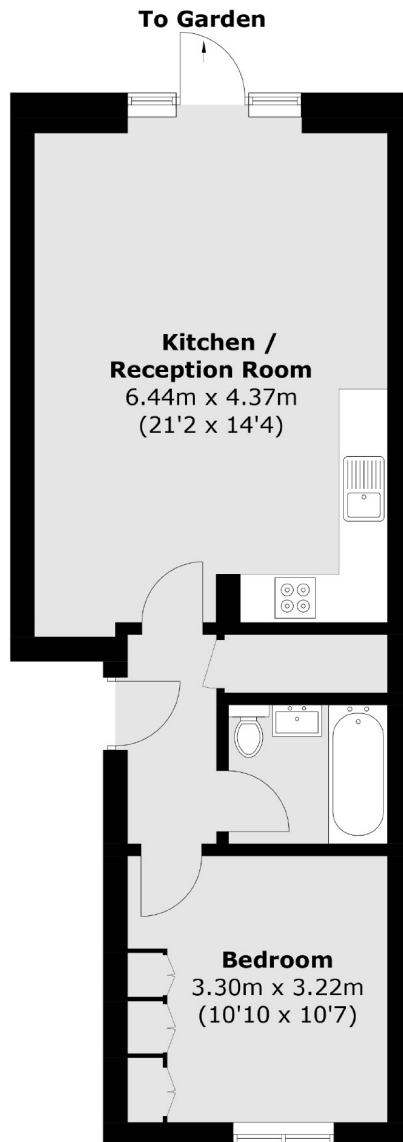

Total area (approx.): 47.8 sq. m (514.5 sq. ft)

Frank Harris & Co. Bloomsbury and Kings Cross

81 Marchmont Street,

London, WC1N 1AL

020 7387 0077

bloomsburylettings@frankharris.co.uk

Energy Rating: C. We aim to make our particulars both accurate and reliable. However they are not guaranteed; nor do they form part of an offer or contract. If you require clarification on any points then please contact us, especially if you're traveling some distance to view. Please note that appliances and heating systems have not been tested and therefore no warranties can be given as to their good working order.

