



## White City Estate, W12

### £400,000

A spacious and well-proportioned three-bedroom purpose-built flat, ideally located in the heart of Shepherd's Bush. Recently renovated throughout by the current owner, the property offers bright and airy living spaces filled with natural light. An excellent opportunity for first-time buyers or investors alike.

Blaxland House is ideally located near Westfield White City, the BBC Centre, and a wide range of shops, restaurants, and bars. Wormholt Park is also within easy reach. Excellent transport links include quick access to the A40 and nearby Central and Hammersmith & City line stations.

### Features

- Offer In Excess Of
- Three Double Bedrooms
- No Onward Chain
- Westfields Shopping Centre
- Central Line
- Residents Parking

# White City Estate, London, W12

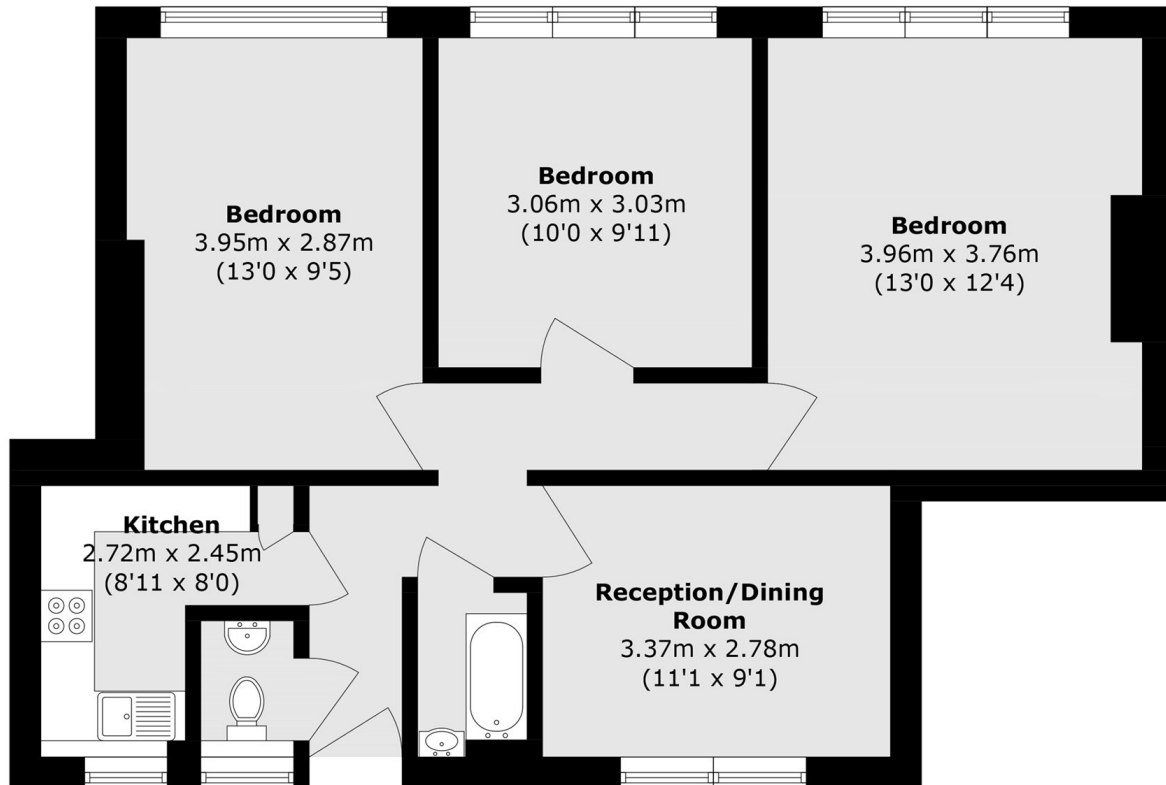

## Fourth Floor

Total area (approx.): 64.1 sq. m (690.0 sq. ft)