



8 Brendon Drive

Ashford, TN24 8HY

Offers In The Region Of £420,000

Occupying a delightful corner plot in a peaceful cul de sac setting is this attractive detached home.

The pleasantly appointed accommodation comprises an entrance hall, cloakroom, kitchen/breakfast room, sitting room, dining room, three bedrooms and four piece bathroom suite.

The attractive mature garden is well stocked with the property also benefiting from gas central heating, double glazing, detached garage & driveway.

Highworth Grammar school is just a short walk away as is Ashford town centre and mainline station.

Viewing

Please contact our Ashford Office on 01233 646411 if you wish to arrange a viewing appointment for this property or require further information.

- SPACIOUS DETACHED HOME
- CORNER PLOT POSITION
- THREE BEDROOMS
- TWO RECEPTION ROOMS
- DETACHED GARAGE & DRIVEWAY
- QUIET CUL DE SAC SETTING
- SHORT WALK FROM TOWN CENTRE & MAINLINE STATION
- GAS CENTRAL HEATING & DOUBLE GLAZING
- GROUND FLOOR WC



Floor Plan

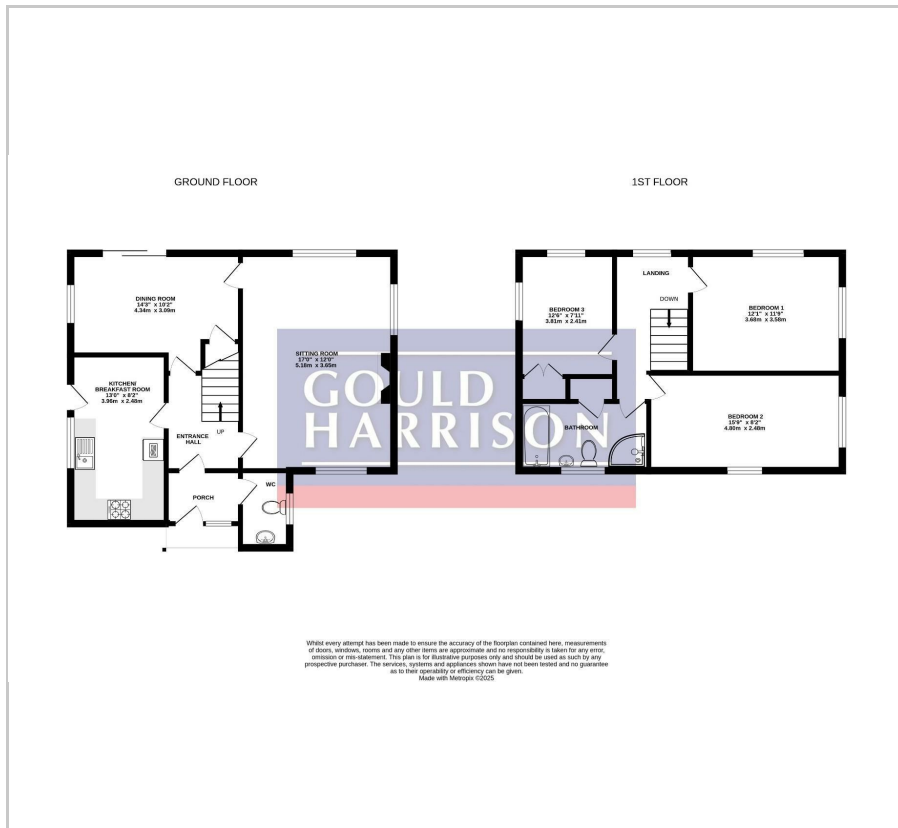

Area Map



Energy Efficiency Graph

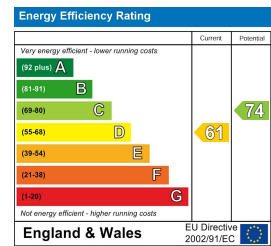

These particulars, whilst believed to be accurate are set out as a general outline only for guidance and do not constitute any part of an offer or contract. Intending purchasers should not rely on them as statements of representation of fact, but must satisfy themselves by inspection or otherwise as to their accuracy. No person in this firm's employment has the authority to make or give any representation or warranty in respect of the property.