

9 Coupals Close - Asking Price £140,000

Haverhill CB9 7UT

shires

Estate & Letting Agents



"Consistently providing outstanding service to our clients"

Asking Price £140,000

The Property

Shires presents this charming flat located in the desirable Coupsals Close, Haverhill. This well-maintained property, built in 1991, offers a comfortable living space of approximately 441 sq. ft., making it an ideal choice for individuals, couples, first-time buyers, or investors alike. Offered with the added benefit of no onward chain, this home is ready for a smooth and straightforward purchase.

The flat features a welcoming reception room, perfect for relaxing or entertaining guests, alongside a well-proportioned bedroom providing a peaceful retreat. The bathroom is conveniently situated to comfortably serve both residents and visitors.

One of the notable advantages of this property is the availability of parking for one vehicle, ensuring a secure and convenient space for your car. Situated within a popular residential area of Haverhill, the property also benefits from excellent access to local amenities and a friendly community atmosphere.

This delightful flat presents a fantastic opportunity for those looking to step onto the property ladder or expand their investment portfolio. With its practical layout, convenient features, and no onward chain, this property is sure to appeal to a wide range of buyers.

Features

- ONE BEDROOM FIRST FLOOR FLAT
- NO ONWARD CHAIN
- ALLOCATED PARKING
- IDEAL FIRST-TIME PURCHASE OR INVESTMENT OPPORTUNITY
- CLOSE TO LOCAL AMENITIES AND TRANSPORT LINKS
- WELL MAINTAINED THROUGHOUT
- SPACIOUS LIVING AREA
- QUIET CUL-DE-SAC POSITION
- VIEWING HIGHLY RECOMMENDED
- MODERN KITCHEN



These sales particulars have been produced as a general guide only and we would draw to your attention that we have not carried out a detailed Survey of the property nor have we tested services, appliances or specific fittings. Whilst measurements and statements given within the details are provided in good faith, their accuracy should not be relied upon. If there are any points about which you may be uncertain or would like further clarification, we would suggest that you telephone this office and speak to our staff who will endeavour to assist you.

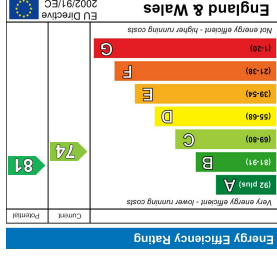

What every attempt has been made to ensure the accuracy of the floorplan contained here, measurements of rooms or this statement. This plan is for guidance purposes only and should be used as such by any prospective purchaser. The services, fixtures and appliances shown have not been tested and no guarantee as to their quality or efficacy can be given. Made with Mapbox ©2023

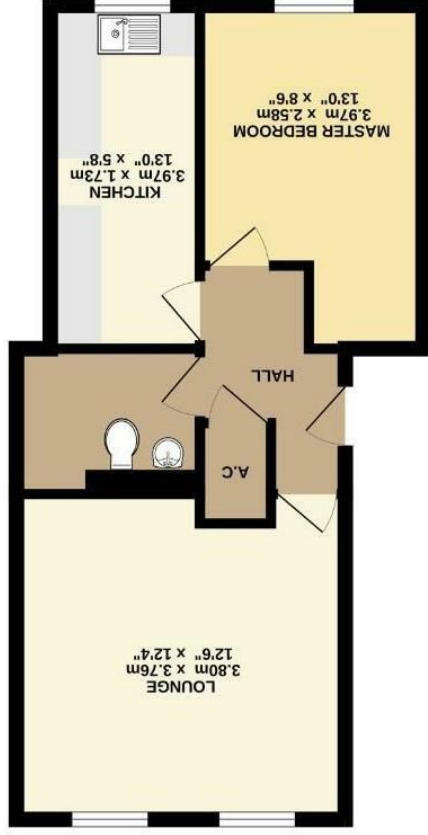

GROUND FLOOR
37.5 sq.m. (404 sq.ft.) approx.

12 High Street, Haverhill, Suffolk, CB9 8AR
 T: 01440 707976
 E: haverhill@shiresestateagents.co.uk