



EQUUS

Country & Equestrian



KEEPERS FARM



KEEPERS FARM, Old Ham Lane, Lenham, Maidstone, Kent, ME17 2LT

An attractive grade II Listed detached home set in 3.74 acres (*TBV) with excellent equestrian facilities including 6 timber loose boxes of various sizes, hay barn, tack room, floodlit post and railed 20m x 45m all weather riding arena and paddocks. This charming property dates back to the 14th century and exudes a wealth of exposed beams and period features including two impressive inglenook fireplaces within the dining room and sitting room.

ACCOMMODATION-Refer to the floor plans for layout and sizes. At the heart of the home is a stunning bespoke open plan kitchen and breakfast room with vaulted ceiling and substantial island and breakfast bar enhanced by exquisite joinery and granite worktops along with integrated appliances and double range stove with Aga and fridge freezer set within custom built cabinetry. The whole interior is tastefully decorated with reasonable head height to most rooms. The balance of the accommodation includes: An entrance hallway with Amtico tiled flooring, staircase to first floor, characterful beamed dining room and sitting room each including an inglenook fireplace with a central wood burning stove between, cosy study area and utility/boot room/cloakroom. Upstairs there are three bedrooms (one with walk in dressing room- could be converted to an ensuite) plus well-appointed family bathroom.

ACCOMODATION

LOCATION & AREA AWARENESS

The property enjoys a semi-rural position on the edge of Lenham Village, which offers an attractive selection of independent shops, quaint cafés, and traditional public houses centred around the village square. Both Lenham and Maidstone provide high-speed rail links into London, with journey times of just over an hour. Nearby, the village of Leeds is home to the magnificent Leeds Castle. Over 900 years old and set within more than 500 acres of stunning park-like grounds, it is renowned as the loveliest castle in the world and draws visitors from across the globe.

Maidstone, the county town, lies less than eight miles from Harrietsham and offers an extensive range of high-street shopping, including a number of major department stores. The town also boasts excellent recreational facilities and several outstanding secondary and independent schools. The charming market town of Faversham, approximately 12 miles away, features a vibrant mix of high-street shops and independent retailers lining its attractive high street and bustling market square. The town also offers superb leisure amenities, including both indoor and outdoor swimming pools, a cinema, a large park and recreation ground, a museum, and numerous pubs and restaurants. Further afield, Ashford provides additional leisure and retail opportunities. Eureka Park hosts a variety of restaurants, as well as Bannatyne Health Club & Spa, Cineworld, and a Travelodge.

The McArthurGlen Designer Outlet around an 18-minute drive is currently undergoing significant expansion, set to double the size of this already major shopping destination.

EQUESTRIAN FACILITIES & GARAGE

REFER TO THE PLANS for the sizes, shape of the outbuildings. Compact yard on concrete with all aspects for the equestrian close by. Power and water laid on with good lighting.

RIDING ARENA - 20m 45 silica sand and rubber with post and rail. Located directly from yard.

STABLES - x8 stables / **HAY STORE** and 2 other **STORES**, **FEED ROOM** and **TACK ROOM**, 2 sheds.

Off the drive a detached open bay timber **GARAGE** and integral **STORE** all on concrete.

LAND & GROUNDS

The whole site is 3.74 acres (*TBV) of level grounds and includes all the outbuildings and arena as well as the garden and house. *The acreage and land shown or stated on any map, plan or particulars is TBV (To Be Verified). This means the land has not been formally measured or verified by Equus or the sellers. A Title Plan from the Land Registry will be available, where possible, showing the boundary and stated acreage. Interested parties wishing to verify the exact area should make their own enquiries via their solicitor and, if required, commission a suitably qualified professional to undertake a formal measurement.

MATERIAL INFORMATION

TENURE: Freehold

PROPERTY TYPE: Detached Grade 2 listed property / **PROPERTY CONSTRUCTION:** Brick and timber / **NUMBER & TYPE OF ROOM/S:** see attached floor plans.

PARKING: Multiple approx. 4 to 4 cars / **LOCAL AUTHORITY:** Maidstone / **TAX BAND:** G

EPC RATING: Exempt Grade Listed. However one has been done.

SERVICES

HEATING: Oil / **SEWAGE:** Cess Pit / **WATER SUPPLY:** Mains / **ELECTRICITY SUPPLY:** Mains

HELPFUL WEBSITE LINKS

We recommend that you visit the local authority website pertaining to the property you are interested in buying for all the planning consents / restrictions / history and the following websites for more helpful information about the property and surrounding local area before proceeding in a purchase:

www.goodschoolsguide.co.uk | www.homecheck.co.uk | www.floodrisk.co.uk | www.environment-agency.gov.uk - www.landregistry.gov.uk | www.homeoffice.gov.uk | www.ukradon.org

<https://checker.ofcom.gov.uk/en-gb/mobile-coverage>

<https://www.ofcom.gov.uk/phones-telecoms-and-internet/advice-for-consumers/advice/broadband-speeds/broadband-basics>



VIEWING ARRANGEMENTS

All Viewings are strictly by Appointment with the Vendors' Agent
 Equus Country & Equestrian, South East/South West
 T: 01892 829014
 E: sales@equusproperty.co.uk
 W: www.equusproperty.co.uk

DISCLAIMER: All prospective buyers view all properties for sale with Equus International Property Ltd at their own risk and neither the Agents, Joint Agents nor the Sellers take responsibility for any damage or injury however caused to themselves or personal belongings or property.

By viewing a property with Equus you accept this disclaimer. If inspecting the outbuildings, equestrian facilities or any other building within the grounds you must wear appropriate clothing and footwear and children must be either left in the car or always supervised. Livestock sh

DISCLAIMERS

1. These particulars are not an offer or contract, nor part of one. You should not rely on statements given by Equus International Property Ltd in the particulars as being factually accurate about the property, its condition or its value. Neither Equus International Property Ltd nor any joint agent has any authority to make any representations about the property, any information given is entirely without responsibility on the part of Equus International Property Ltd.
2. Please note that the material information is provided to Equus International Property Ltd by third parties and is provided here as a guide only. We advise you to confirm the details of any such material information prior to any offer being submitted. We will use reasonable endeavours to update if there are changes as soon as practical.
3. The photographs, property videos and virtual viewings etc. show only certain parts of the property as they appeared at the time they were taken. Areas, measurements and distances given are approximate

only.

4. Any reference to alterations to, or use of, any part of the property does not mean that any necessary planning, building regulations or other consent has been obtained. A buyer must find out by inspection or in other ways that these matters have been properly dealt with and that all information is correct. 5. A list of the fitted carpets, curtains, light fittings and other items fixed to the property which are included in the sale (or may be available by separate negotiation) will be provided by the Seller's Solicitors. 6. VAT may be payable.

Guide price £1,150,000



KF - ME17

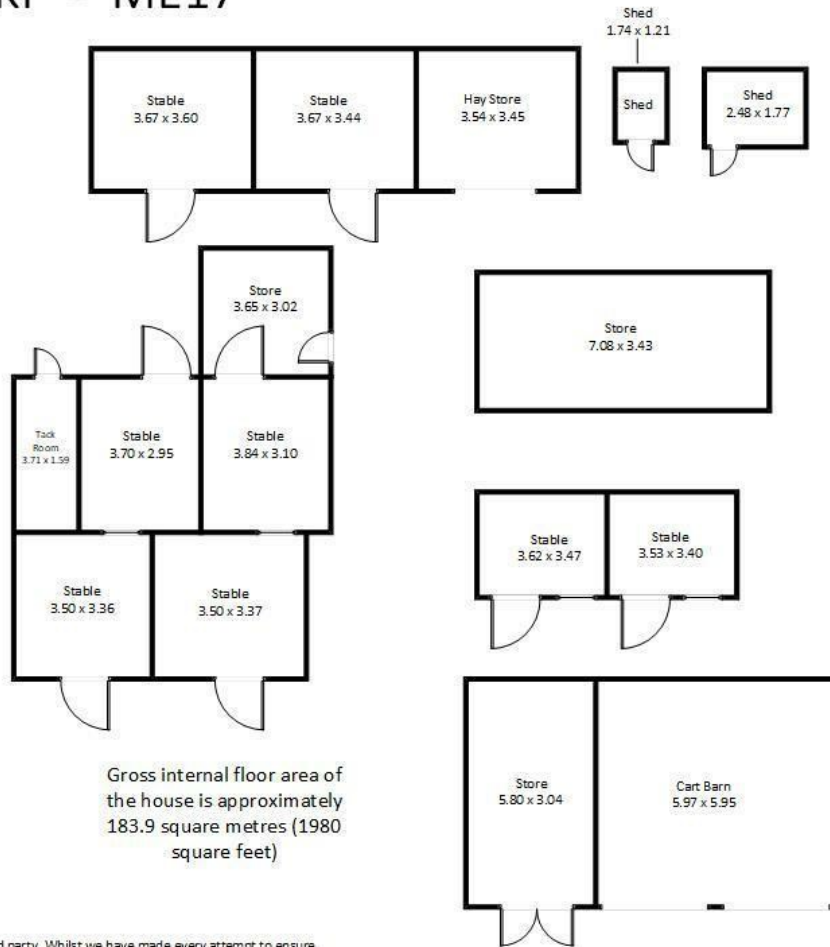

Gross internal floor area of the house is approximately 183.9 square metres (1980 square feet)

This plan is for illustration only and should be viewed as such by any prospective purchaser or interested party. Whilst we have made every attempt to ensure the accuracy of all measurements they must be viewed as approximate and no responsibility can be taken for any error, omission or misstatement.
 Invicta EPC www.invictaepc.com email: rwood@invictaepc.com



Energy Efficiency Rating		Current	Potential
Very energy efficient - lower running costs			
(92 plus) A			
(81-91) B			
(69-80) C			
(55-68) D			
(39-54) E			
(21-38) F			
(1-20) G			
Not energy efficient - higher running costs			
England & Wales	EU Directive 2002/91/EC		

Environmental Impact (CO ₂) Rating		Current	Potential
Very environmentally friendly - lower CO ₂ emissions			
(92 plus) A			
(81-91) B			
(69-80) C			
(55-68) D			
(39-54) E			
(21-38) F			
(1-20) G			
Not environmentally friendly - higher CO ₂ emissions			
England & Wales	EU Directive 2002/91/EC		

PROPERTYMISDESCRIPTION ACT 1991: Every care has been taken in the preparation of these particulars but their accuracy is not guaranteed and they do not form part of any contract. Descriptions are given in good faith and as an opinion of the agents, not as a statement of fact. No description or information given about the property or its value, whether written or verbal or whether or not in these Particulars ("information") may be relied upon as a statement of representation or fact. Neither Equus Property nor its Joint Agents have any authority to make any representation and accordingly any information given is entirely without responsibility on the part of Equus Property or the seller/lessor. Any areas, measurements or distances referred to are given as a guide only and are not precise. Photographs are reproduced for general information using a 24mm wide-angle lens and are not necessarily comprehensive nor current; no assumption should be made that any content shown are included in the sale nor with regards to parts of the property which have not been photographed. Reference to any particular use of any part of the property or to alterations is not intended to imply that planning or building regulations or any other consents have been obtained. We have not tested any appliances, services, heating systems or fixtures, and so cannot guarantee they are in good working order. Prospective purchasers should undertake their own tests, enquiries or surveys before entering into any commitment. The information in these particulars is given without responsibility on the part of the Agent or their clients. Neither the Agents nor their employees have any authority to make or give any representations or warranties whatever in relation to this property. These particulars are issued on the understanding that all viewings and negotiations are conducted through the agents.

NATIONAL ADVERTISING • LOCAL KNOWLEDGE • SPECIALIST ADVICE



www.equusproperty.co.uk

NATIONAL ADVERTISING • LOCAL KNOWLEDGE • SPECIALIST ADVICE



A member of



PrimeLocation.com

UKLAND and
FARMS.co.uk

