



FLAT 1, REDLANDS PLACE BRIGHTON ROAD
HORSHAM, RH13 5BU

£180,000
LEASEHOLD

Eltons are delighted to present to the market this modern one bedroom, ground floor flat in central Horsham.

ELTONS

Estate Agents

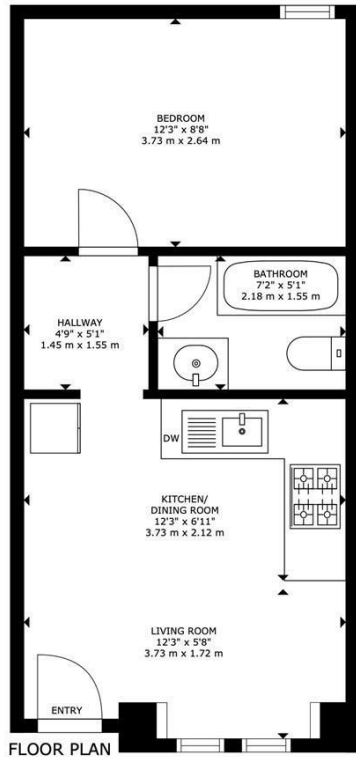

GROSS INTERNAL AREA
FLOOR PLAN: 334 sq. ft, 31 m²
SIZES AND DIMENSIONS ARE APPROXIMATE, ACTUAL MAY VARY.

ELTONS
Estate Agents

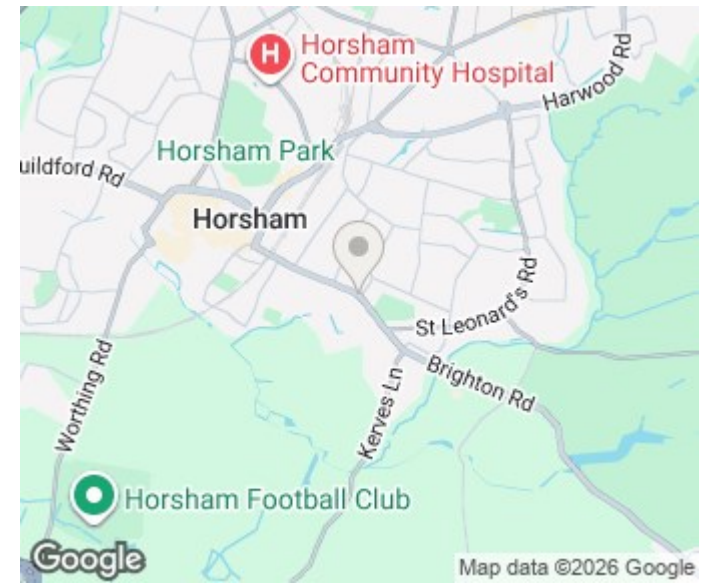

Energy Efficiency Rating		
	Current	Potential
Very energy efficient - lower running costs		
(92 plus) A		
(81-91) B		
(69-80) C		77
(55-68) D		
(39-54) E	52	
(21-38) F		
(1-20) G		
Not energy efficient - higher running costs		
England & Wales	EU Directive 2002/91/EC	

Agents Note: Whilst every care has been taken to prepare these particulars, they are for guidance purposes only. All measurements are approximate and are for general guidance purposes only and whilst every care has been taken to ensure their accuracy, they should not be relied upon and potential buyers/tenants are advised to recheck the measurements

Eltons Estate Agents Horsham
13 - 15 Queen Street
Horsham
West Sussex
RH13 5AA

01403 299 771
sales@eltons.co.uk
eltons.co.uk

ELTONS
Estate Agents