



## East India Dock Road, E14 £300,000

Presented to the market is this two-bedroom apartment, ideally located within walking distance of a wide range of local amenities and restaurants. The property features an open-plan reception room, along with concierge services and a secure entry phone system.

The Fusion Building is ideally located just 0.1 miles from All Saints DLR Station, offering an easy commute to Canary Wharf and the City.

### Features

- 632 Square Feet
- Fifth Floor
- Two Bedrooms
- Concierge Services
- No Onward Chain
- Open Plan

# East India Dock Road, London, E14

## Fifth Floor

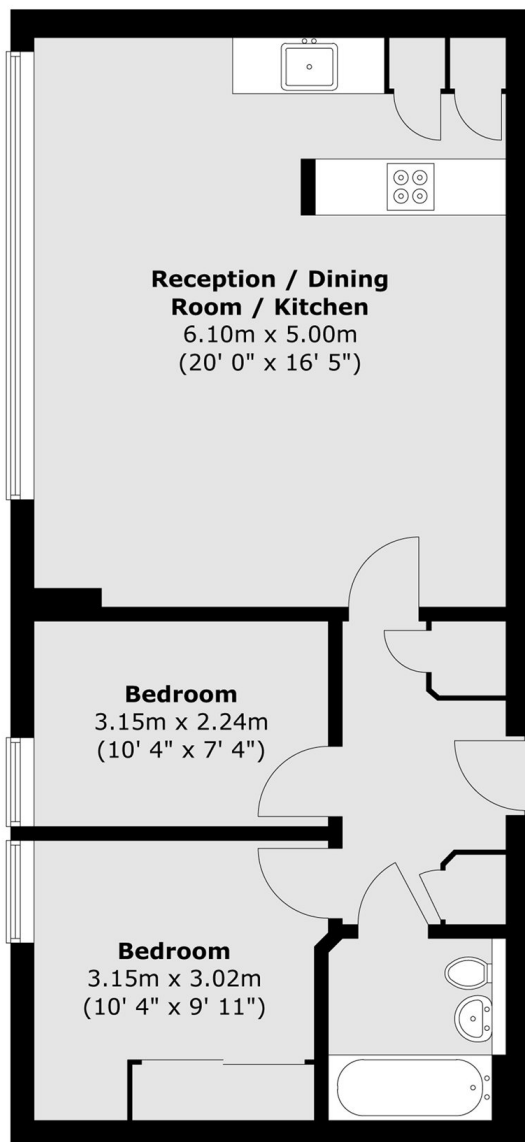

Total area (approx.) : 58.7 sq. m (632 sq. ft)