

the floorplan...

GROUND FLOOR
592 sq.ft. (55.0 sq.m.) approx.

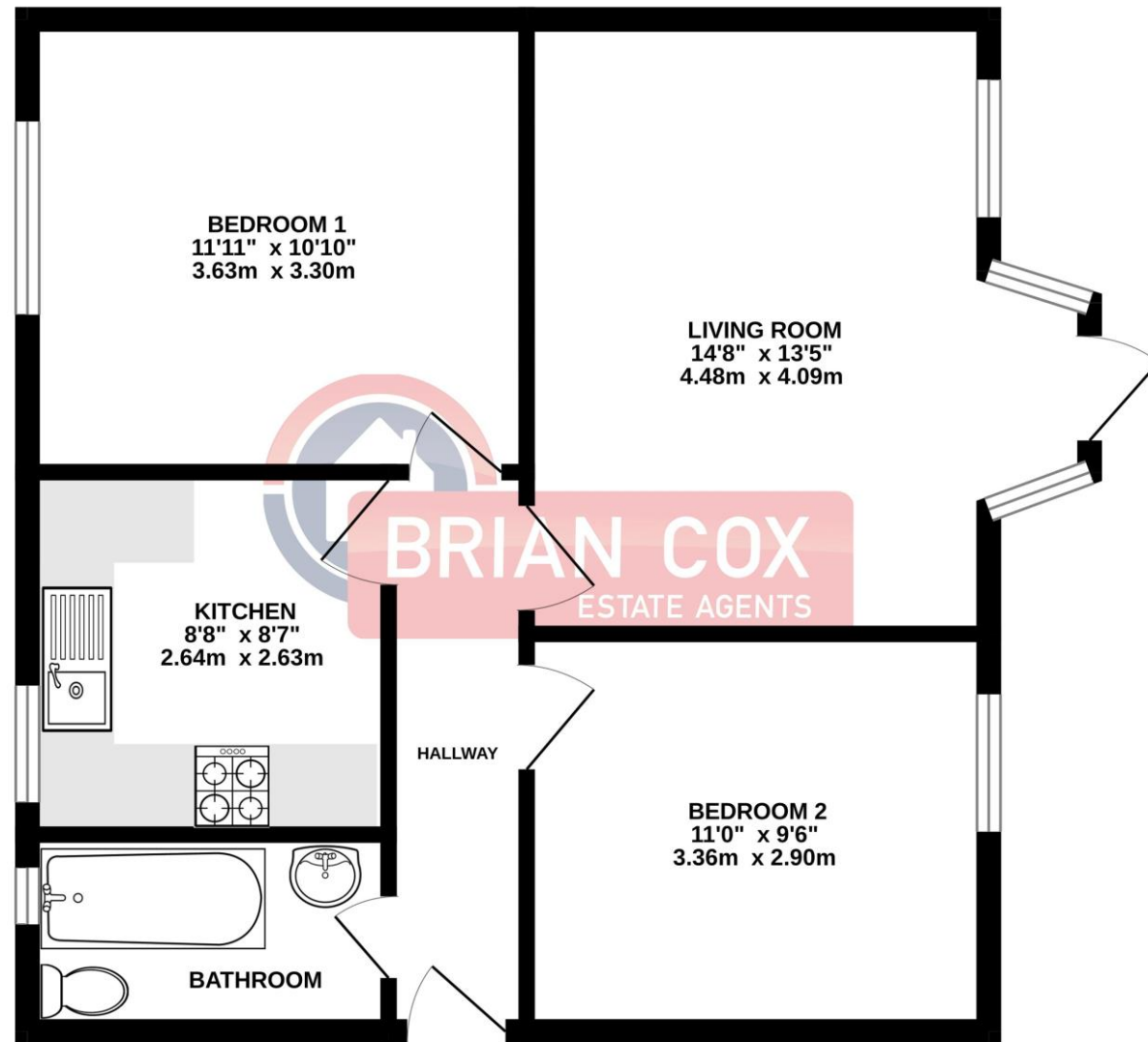

more details from...

call: **Brian Cox Greenford: 0208 578 1004**
email: emma.gerald@brian-cox.co.uk
web: www.brian-cox.co.uk



0208 578 1004
brian-cox.co.uk



TWO BEDROOM - CHAIN FREE - 999 YEAR LEASE - REAR GARDEN - REAR DRIVEWAY FOR 2 CARS. Brian Cox and Company are delighted to bring to the market this larger-than-average two-bedroom ground floor maisonette which offers generous space both inside and out. Benefiting from a private rear garden and driveway for 2 cars, long lease and convenient location making it an ideal choice for first time buyers and investors. Internally, the property boasts a spacious layout with ample room throughout. The property comprises two double bedrooms, a bright and airy living room with French doors leading to the garden, a fitted kitchen, and family bathroom. Viewings are highly recommended to fully appreciate the size, condition, and prime location of this delightful home.



£350,000
Leasehold

Costons Lane, Greenford UB6 8RW

Consumer Protection from Unfair Trading Regulations 2008 We have not tested any apparatus, equipment, fixtures, fittings or services and so cannot verify that they are in working order or fit for purpose. You are advised to obtain verification from your solicitor or surveyor. References to the tenure of a property are based on information supplied by the seller. We have not had sight of the title documents and a buyer is advised to obtain verification from their solicitor. Items shown in photographs are not included unless specifically mentioned within the sales particulars, but may be available by separate negotiation. We advise you to book an appointment to view before embarking on any journey to see a property, and check its availability.



in brief...

- Two Bedroom
- Ground Floor Maisonette
- Chain Free
- Rear Driveway For 2 Cars
- 999 Year Lease
- No Service Charge/ No Ground Rent



the location...

nearest stations ...

South Greenford (0.6 miles)
Castle Bar Park (0.8 miles)
Greenford (0.9 miles)

Greenford is a large suburb in the London Borough of Ealing in West London, UK. It was an ancient parish in the historic county of Middlesex. It is 11 miles (18 km) from Charing Cross in Central London.

There are several local primary schools in the area which include The Edward Betham Church of England Primary School, Coston Primary School, Stanhope Primary School and Oldfield Primary School.

If you have older children there are also local secondary schools nearby some of these include The Cardinal Wiseman Catholic School, Brentside High School and William Perkin Church of England High School.