



37 Church Walk, Telford, TF2 8EU **Offers in the region of £170,000**

Spacious mid terrace family home in this popular area of Donnington. Being close to nearby shops, amenities and transport links the property is available with no upward chain and requires some modernisation yet has much potential.

Comprising in brief of an entrance hall, sitting room, dining room and kitchen to the ground floor. To the first floor are three bedrooms and the family bathroom.

Having UPVC double glazing and warmed via gas fired central heating.

Driveway parking is on offer to the front whilst the rear garden is fully enclosed and has much privacy.

A great property for first time buyers or the growing family alike.

ENTRANCE HALL

SITTING ROOM

12'1" x 10'9" (3.7m x 3.3m)

DINING ROOM

15'1"x 12'1" (4.6mx 3.7m)

KITCHEN

14'1" x 7'6" (4.3m x 2.3m)

FIRST FLOOR LANDING

BEDROOM ONE

14'9" x 12'1" (4.5m x 3.7m)

BEDROOM TWO

12'1" x 11'1" (3.7m x 3.4m)

BEDROOM THREE

9'6" x 7'6" (2.9m x 2.3m)

BATHROOM

GROUND FLOOR

1ST FLOOR

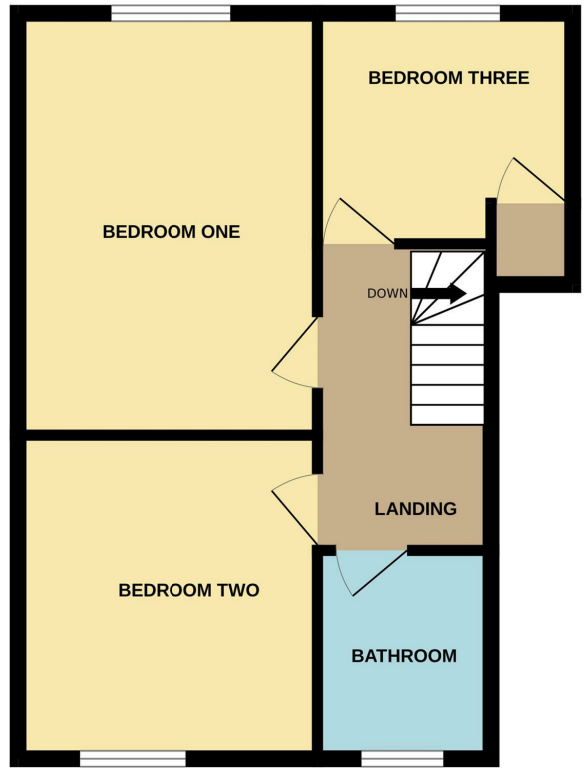
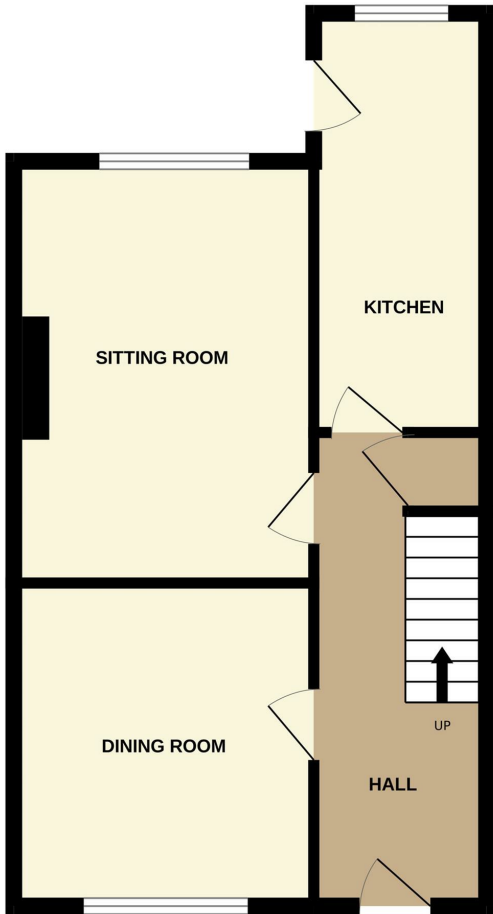

Whilst every attempt has been made to ensure the accuracy of the floorplan contained here, measurements of doors, windows, rooms and any other items are approximate and no responsibility is taken for any error, omission or mis-statement. This plan is for illustrative purposes only and should be used as such by any prospective purchaser. The services, systems and appliances shown have not been tested and no guarantee as to their operability or efficiency can be given.
Made with Metropix ©2026

