

26 Meadow Grange, Fitzwilliam, Pontefract, WF9 5FS

Welcome to this stunning semi detached house located in the desirable area of Meadow Grange, Fitzwilliam, Pontefract. This property, completed in 2019, offers a generous living space of 1,561 square feet, making it an ideal family home.

As you step inside, you will be greeted by a modern interior that has been thoughtfully designed to cater to contemporary living. The spacious layout provides ample room for relaxation and entertaining, ensuring that every family member can enjoy their own space. The property boasts a well-appointed kitchen that flows seamlessly into the living areas, creating a warm and inviting atmosphere.

One of the standout features of this home is the expansive garden, perfect for outdoor activities, gardening, or simply enjoying the fresh air. Additionally, there is an outbuilding that offers versatile options for extra space, whether you wish to use it as a home office, a workshop, or even a small business venture.

Situated in a peaceful neighbourhood, this property combines modern living with the charm of a family-friendly community. With its excellent transport links and local amenities, Meadow Grange is an ideal location for those seeking both convenience and comfort.

Don't miss the opportunity to make this beautiful home your own.

£300,000

- 5 Bedroom Family Home
- Modern Interior Throughout
- Open Plan Kitchen/Diner
- Master Bedroom With En-suite
- Spacious Garden
- Outbuilding
- Off Street Parking
- Close to Local Pubs, Schools and Other Amenities

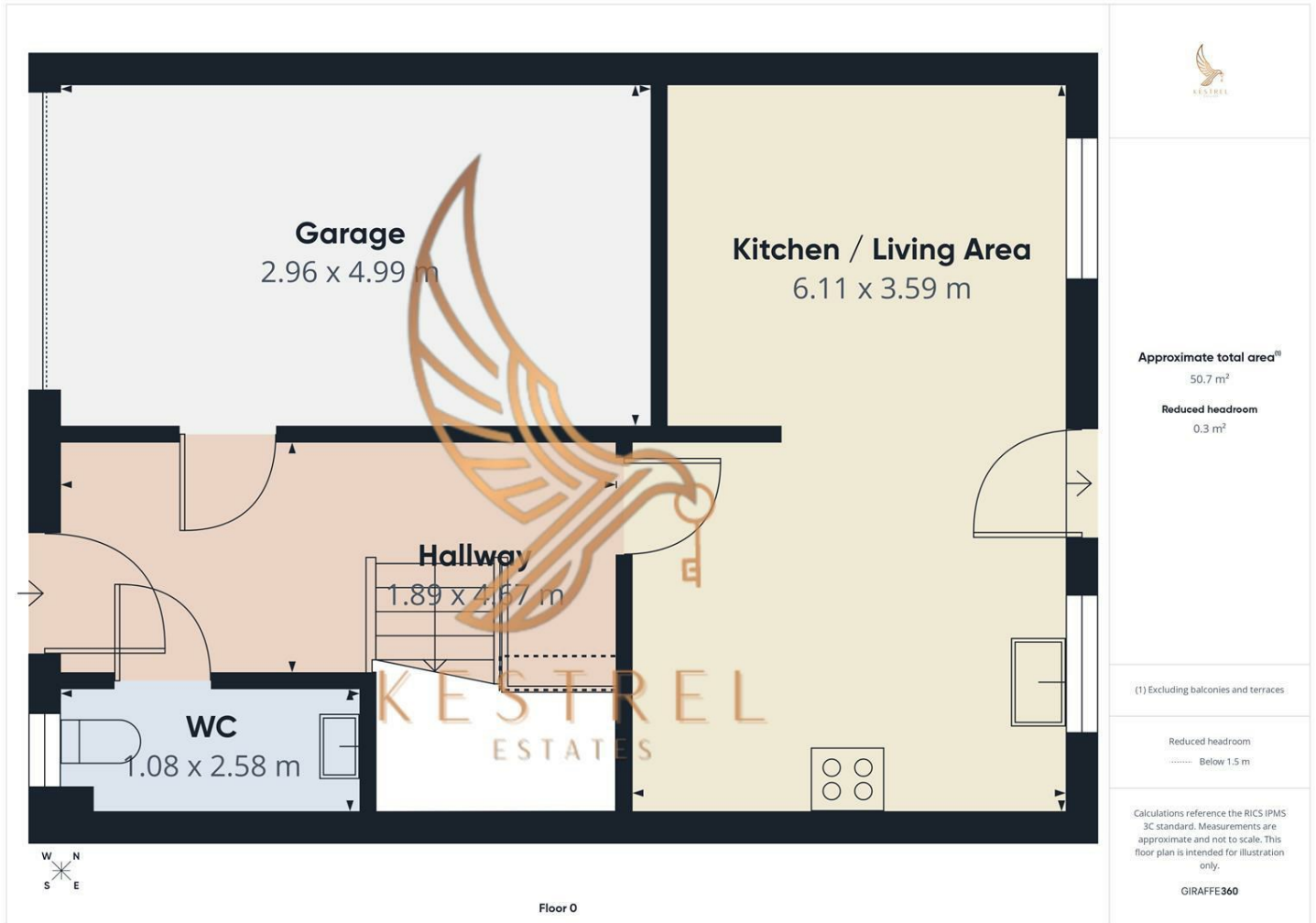

Energy Efficiency Rating		Current	Potential
Very energy efficient - lower running costs			100+
(92 plus) A			
(81-91) B		83	
(69-80) C			
(55-68) D			
(39-54) E			
(21-38) F			
(1-20) G			
Not energy efficient - higher running costs			
England & Wales		EU Directive 2002/91/EC	