

## St. James's Road, SE16

£420,000

Situated in the heart of Bermondsey, this one double bedroom flat is in excellent condition and has a large open plan kitchen and living area, modern bathroom, ample storage, private balcony and offers concierge facilities.

Dragonfly Apartments is located just 0.2 miles from Bermondsey tube station offering fantastic transport links to all of London. The river and a wide range of shops, café's and artisan deli's and food markets are moments away.

### Features

- One Double Bedrooms
- Excellent Condition
- Concierge Facilities
- Chain Free
- Fantastic Location
- Long Lease

**St. James's Road,  
London, SE16**

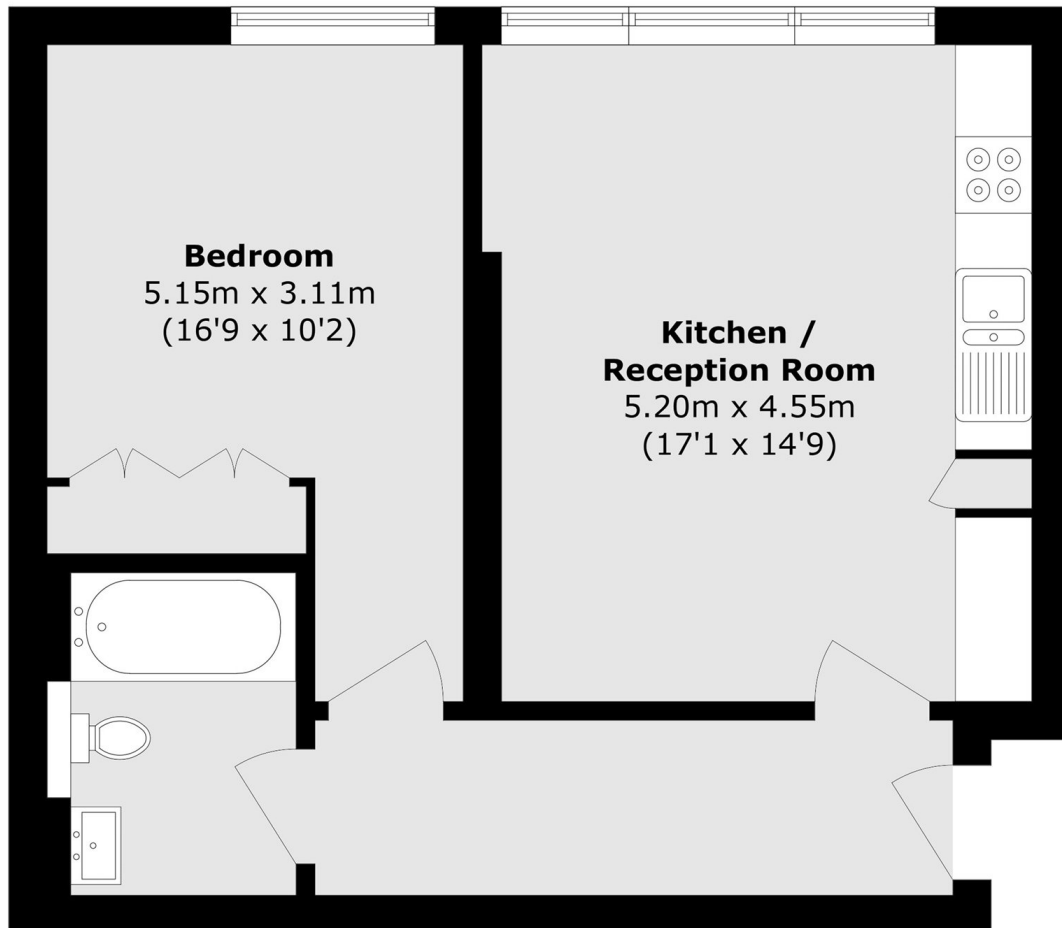

Total area (approx.): 50.6 sq. m (544.7 sq. ft)