



Nevern Square, SW5

£575,000

A spacious two-bedroom, two-bathroom flat situated on the lower ground floor of an attractive mansion block in the heart of Earl's Court. Ideal as a first-time purchase or investment opportunity, the property benefits from access to award-winning communal gardens and offers generous living accommodation in a highly sought-after location.

Nevern Square is an excellent location being just round the corner from the amenities of Earls Court Road which includes many restaurants and bars as well as tube services.

Features

- Two Bedrooms
- Two Bathrooms
- Access to Communal Gardens
- Walking Distance to Amenities
- No Ongoing Chain
- Highly Sought After Location

Nevern Square, London, SW5

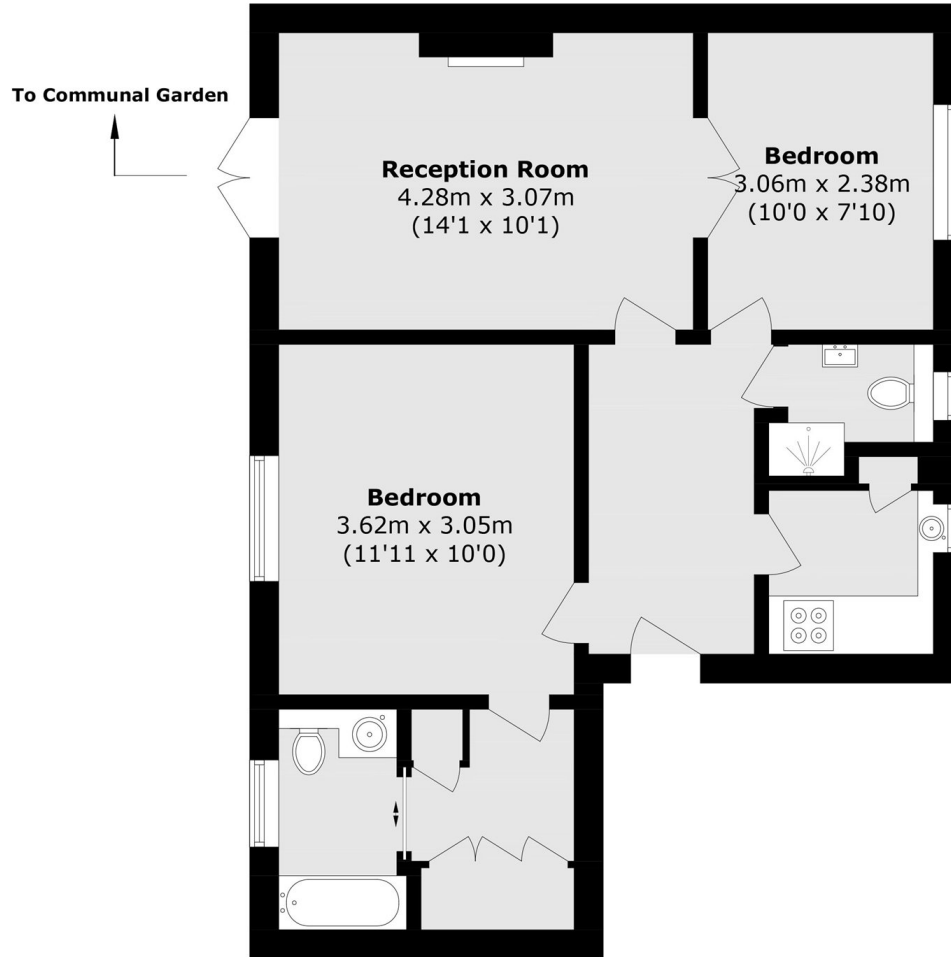

Lower Ground Floor

Total area (approx.): 52.0 sq. m (559.7 sq. ft)